

MATCHLINE STATION 0+170

MATCHLINE STATION 0+280

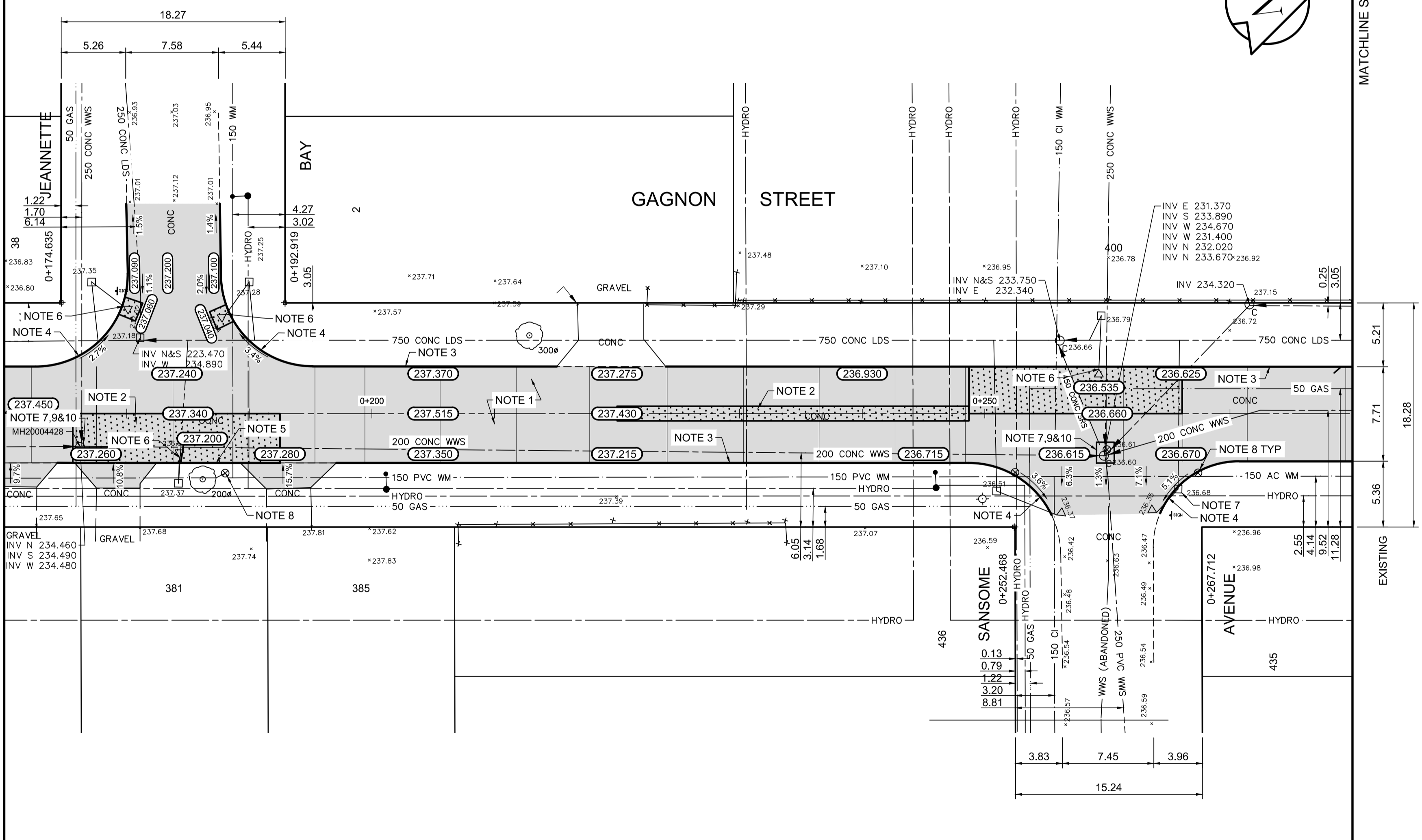
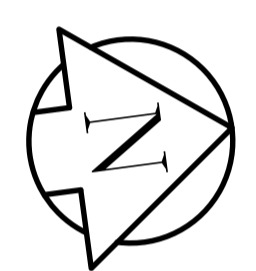

- REFERENCE NOTES**
- PAVEMENT DIMENSIONS ARE TO BACK OF CURB
 - BASELINE IS CENTRE LINE RIGHT-OF-WAY
 - PROPERTY LINES OBTAINED FROM CITY OF WINNIPEG L.B.I.S., AND NO SCALE FACTOR WAS APPLIED
 - REFER TO AECOM FIELD BOOK NO. 4999

- CONSTRUCTION NOTES**
- CONSTRUCT NEW ASPHALTIC PAVEMENT OVERLAY TYPE 1A (85mm AVG.)
 - REMOVE EXISTING CONCRETE PAVEMENT AND CONSTRUCT NEW 150mm REINFORCED CONCRETE PAVEMENT c/w 85mm ASPHALTIC OVERLAY
 - PLANE EXISTING MOUNTABLE CURB AND CONSTRUCT NEW BARRIER CURB (100mm REVEAL HT, DOWELLED)
 - REMOVE EXISTING MOUNTABLE CURB AND CONSTRUCT NEW MODIFIED BARRIER CURB (150mm HT, DOWELLED)
 - CONSTRUCT NEW BARRIER CURB (100mm REVEAL HT, SEPARATE)
 - REMOVE EXISTING MOUNTABLE CURB INLET FRAME AND INSTALL NEW CURB AND GUTTER INLET FRAME, BOX AND GRATED COVER (AP-011 & AP-012)
 - ADJUST EXISTING MANHOLE / CATCHBASIN TO GRADE
 - ADJUST EXISTING WATER VALVE TO GRADE
 - REMOVE EXISTING FRAME AND COVER AND PLACE NEW FRAME AND SOLID COVER (AP-006/AP-007)
 - INSTALL NEW CAST IRON RING

AECOM
 Certificate of Authorization
 AECOM Canada Ltd.
 No. 4671 Date: _____

METRIC
 WHOLE NUMBERS INDICATE MILLIMETRES
 DECIMALIZED NUMBERS INDICATE METRES

EXISTING	LEGEND - PLAN	PROPOSED	EXISTING	LEGEND - PLAN	PROPOSED	EXISTING	LEGEND - PROFILE	PROPOSED
150 mm W.M.	WATERMAIN	150 mm W.M.	—	HYDRO	—	—	Q PROFILE	—
Hydrant	HYDRANT	Hydrant	—	M.T.S.	—	—	WEST GUTTER	—
Valve	VALVE	Valve	—	CONCRETE	—	—	EAST GUTTER	—
300mm L.D.S.	LAND DRAINAGE SEWER	300mm L.D.S.	—	ASPHALT	—	—	N/W PROPERTY LINE	—
250mm W.W.S.	WASTEWATER SEWER	250mm W.W.S.	—	PROPERTY LINE	—	—	S/E PROPERTY LINE	—
Manhole	MANHOLE	Manhole	—	SURVEY BAR	—	—		
Catch Basin	CATCH BASIN	Catch Basin	—	ELEVATION	(235.750)	—		
Catch Pit	CATCH PIT	Catch Pit	—	TREE	—	—		
Junctions	JUNCTIONS	Junctions	—	SIDEWALK RAMP	—	—		
Culvert	CULVERT	Culvert	—	CONCRETE SIDEWALK	—	—		
Gas	GAS	Gas	—	FENCE	—	—		

LOCATION APPROVED UNDERGROUND STRUCTURES

SUPV. U/G STRUCTURES COMMITTEE DATE _____

NOTE:
 LOCATION OF UNDERGROUND STRUCTURES AS SHOWN ARE BASED ON THE BEST INFORMATION AVAILABLE. BUT NO GUARANTEE IS GIVEN THAT ALL EXISTING UTILITIES ARE SHOWN OR THAT THE GIVEN LOCATIONS ARE EXACT. CONFIRMATION OF EXISTENCE AND EXACT LOCATION OF ALL SERVICES MUST BE OBTAINED FROM THE INDIVIDUAL UTILITIES BEFORE PROCEEDING WITH CONSTRUCTION.

B.M. 41-005
 ELEV. 238.147

S. 8.100r St. Charles St. & Augier Ave., T18, in most Wby. Conc. foundation of school, No. 331 St. Charles St., 0.3 m B. & 0.1 m below brick of N.W. Cor. of most Wby. wall of school.

NO.	REVISIONS	DATE	BY
0	ISSUED FOR TENDER	04/12/2018	BC
A	ISSUED FOR REVIEW	04/04/2018	BC

AECOM

DESIGNED BY	SF	CHECKED BY	BC/KWR
DRAWN BY	JC	APPROVED BY	
HOR. SCALE:	1:250	RELEASED FOR CONSTRUCTION BY:	
VERTICAL:	1:10	DATE	

ENGINEER'S SEAL

PROVINCE OF MANITOBA

K.W. RAE

REGISTERED PROFESSIONAL ENGINEER

CONSULTANT DRAWING NO. CT-02

THE CITY OF WINNIPEG
 PUBLIC WORKS DEPARTMENT
 ENGINEERING DIVISION

2018 RESIDENTIAL STREET RENEWAL PROGRAM

GAGNON STREET - AUGIER AVENUE TO OXBOW BEND ROAD
 CONCRETE PAVEMENT REHABILITATION
 STATION 0+170 TO STATION 0+280

CITY DRAWING NUMBER
 SHEET 02 OF 18