

MATCHLINE STATION 0+390

MATCHLINE STATION 0+500

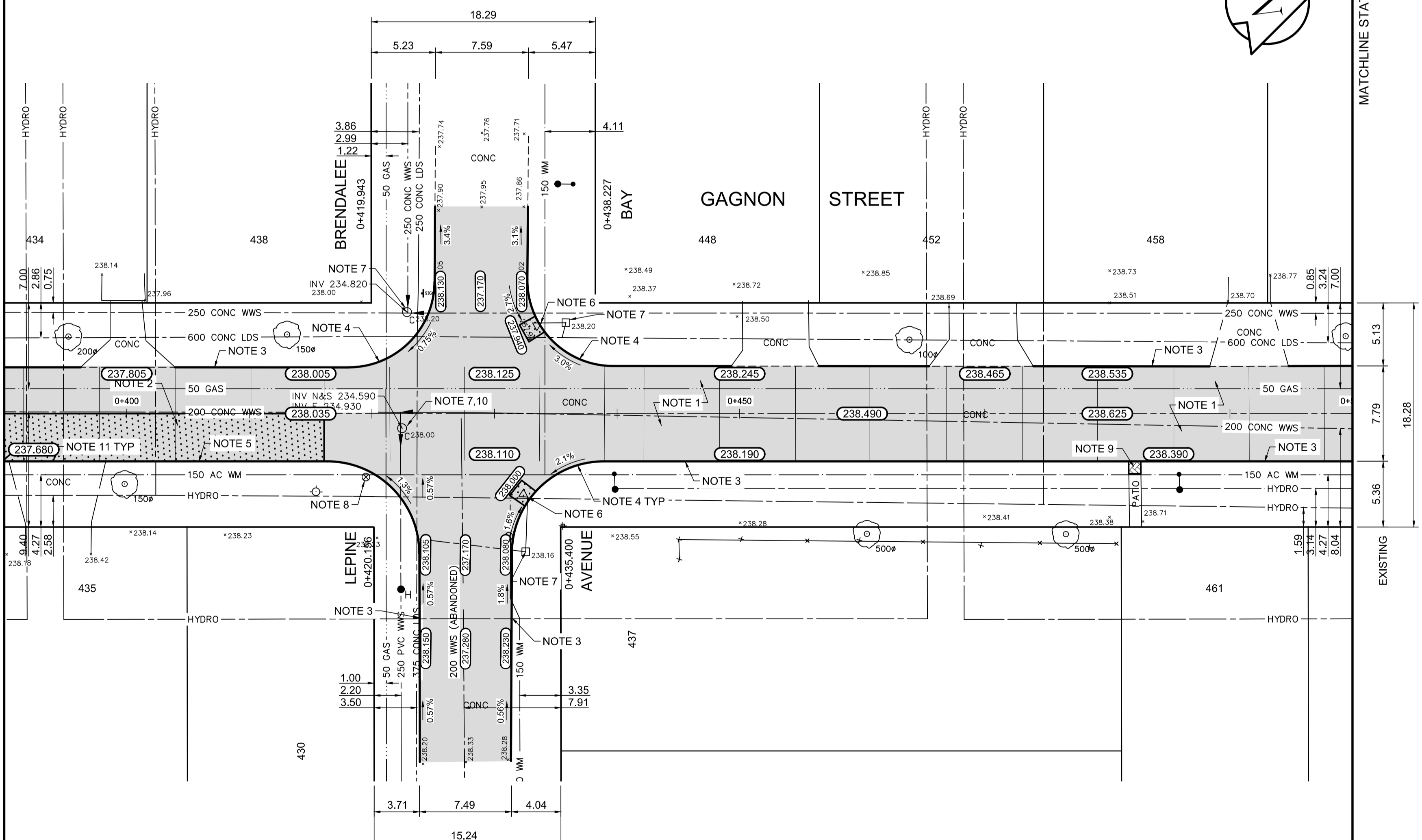
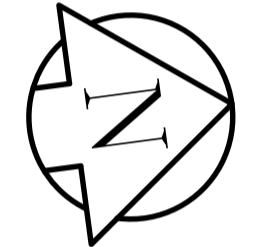

REFERENCE NOTES

- A. PAVEMENT DIMENSIONS ARE TO BACK OF CURB
- B. BASELINE IS CENTRE LINE RIGHT-OF-WAY
- C. PROPERTY LINES OBTAINED FROM CITY OF WINNIPEG L.B.I.S., AND NO SCALE FACTOR WAS APPLIED
- D. REFER TO AECOM FIELD BOOK NO. 4999

CONSTRUCTION NOTES

1. CONSTRUCT NEW ASPHALTIC PAVEMENT OVERLAY TYPE 1A (85mm AVG.)
2. REMOVE EXISTING CONCRETE PAVEMENT AND CONSTRUCT NEW 150mm REINFORCED CONCRETE PAVEMENT c/w 85mm ASPHALTIC OVERLAY
3. PLANE EXISTING MOUNTABLE CURB AND CONSTRUCT NEW BARRIER CURB (100mm REVEAL HT, DOWELLED)
4. REMOVE EXISTING MOUNTABLE CURB AND CONSTRUCT NEW MODIFIED BARRIER CURB (150mm HT, DOWELLED)
5. CONSTRUCT NEW BARRIER CURB (100mm REVEAL HT, SEPARATE)
6. REMOVE EXISTING MOUNTABLE CURB INLET FRAME AND INSTALL NEW CURB AND GUTTER INLET FRAME, BOX AND GRATED COVER (AP-011 & AP-012)
7. ADJUST EXISTING WATER VALVE / CATCHBASIN TO GRADE
8. REGRADE EXISTING PATIO BLOCKS TO GRADE
9. REGRADE EXISTING PATIO BLOCKS
10. INSTALL NEW CAST IRON RING
11. CONSTRUCT NEW CONCRETE LIP CURB (40mm HT, INTEGRAL)

AECOM
 Certificate of Authorization
 AECOM Canada Ltd.
 No. 4671 Date: _____

METRIC
 WHOLE NUMBERS INDICATE MILLIMETRES
 DECIMALIZED NUMBERS INDICATE METRES

150 mm W.M.	WATERMAIN	150 mm W.M.	HYDRO	— x —	PROFILE
Hydrant	HYDRANT	Manhole	M.T.S.	— □ —	WEST GUTTER
Valve	VALVE	Catch Basin	CONCRETE	— ○ —	EAST GUTTER
Land Drainage Sewer	LAND DRAINAGE SEWER	Catch Pit	ASPHALT	— ◇ —	N/W PROPERTY LINE
Wastewater Sewer	WASTEWATER SEWER	Junctions	PROPERTY LINE	— ○ —	S/E PROPERTY LINE
Manhole	MANHOLE	Culvert	SURVEY BAR		
Catch Basin	CATCH BASIN	Gas	ELEVATION (235.750)		
Catch Pit	CATCH PIT	Existing	TREE		
Junctions	JUNCTIONS	Proposed	SIDEWALK RAMP		
Culvert	CULVERT	Existing	CONCRETE SIDEWALK		
Gas	GAS	Proposed	FENCE		
Existing	LEGEND - PLAN	Proposed	LEGEND - PLAN	Existing	LEGEND - PROFILE
Proposed		Existing	LEGEND - PROFILE	Proposed	

LOCATION APPROVED UNDERGROUND STRUCTURES

DATE: _____

NOTE:
 LOCATION OF UNDERGROUND STRUCTURES AS SHOWN ARE BASED ON THE BEST INFORMATION AVAILABLE, BUT NO GUARANTEE IS GIVEN THAT ALL EXISTING UTILITIES ARE SHOWN OR THAT THE GIVEN LOCATIONS ARE EXACT. CONFIRMATION OF EXISTENCE AND EXACT LOCATION OF ALL SERVICES MUST BE OBTAINED FROM THE INDIVIDUAL UTILITIES BEFORE PROCEEDING WITH CONSTRUCTION.

B.M. 41-005	0	ISSUED FOR TENDER	04/12/2018	BC
ELEV. 238.147	A	ISSUED FOR REVIEW	04/04/2018	BC
	NO.	REVISIONS	DATE	BY

AECOM

DESIGNED BY: SF
 CHECKED BY: BC/KWR
 DRAWN BY: JC
 APPROVED BY: _____
 HOR. SCALE: 1:250
 VERTICAL: 1:10
 RELEASED FOR CONSTRUCTION BY: _____
 DATE: _____

THE CITY OF WINNIPEG
 PUBLIC WORKS DEPARTMENT
 ENGINEERING DIVISION

2018 RESIDENTIAL STREET RENEWAL PROGRAM

GAGNON STREET - AUGIER AVENUE TO OXBOW BEND ROAD
 CONCRETE PAVEMENT REHABILITATION
 STATION 0+390 TO STATION 0+500

CITY DRAWING NUMBER: SHEET 04 OF 18

CONSULTANT DRAWING NO. CT-04