

## CONSTRUCTION NOTES

- SUPPLY AND INSTALL TAPERED EPS TO ENSURE POSITIVE DRAINAGE AND BASE LAYER ISO TO ACHIEVE MIN. R28.
- INSTALL NEW OVERFLOW SCUPPER AT EAST END.
- SUPPLY AND INSTALL NEW INTERNAL DRAINS AS REQUIRED.
- SUPPLY AND INSTALL NEW 26-GAUGE COPING AND COUNTER FLASHING C/W ACCESSORIES AS REQUIRED.
- SUPPLY AND INSTALL NEW INSULATED SPUN ALUMINUM PV FLASHING.
- PARAPET COPING PROFILE TO BE SINGLE BEND SQUARE FLUSH WITH STUCCO CLADDING NOT TWO-STEP.

## DEMOLITION NOTES

- DISENGAGE AND DISCARD AGGREGATE & 4-PLY BUR. SUPPLY AND INSTALL NEW 2-PLY SBS WATERPROOFING SYSTEM.

## KEYNOTES

- |               |                              |           |
|---------------|------------------------------|-----------|
| ① CORE SAMPLE | ⑩ PITCH BOX                  | ③① STAIRS |
| ② CHIMNEY     | ⑪ HVAC UNIT                  |           |
| ③ AC UNIT     | ⑫ CAPPED CURB                |           |
| ④ VENT HOOD   | ⑬ FLAG POLE                  |           |
| ⑤ VENTILATOR  | ⑭ ELECTRICAL MAST            |           |
| ⑥ VENT PIPE   | ⑮ COOLING TOWER              |           |
| ⑦ ROOF DRAIN  | ⑯ SPLASH PAD                 |           |
| ⑧ SKYLIGHT    | ⑰ SPLASH PAN                 |           |
| ⑨ EAVESTROUGH | ⑱ DOWNSPOUT/RAINWATER LEADER |           |
| ⑩ FIREWALL    | ⑲ BACK SLOPE                 |           |
| ⑪ ANTENNA     | ⑳ CANT                       |           |
| ⑫ LADDER      | ㉑ INCREASE SLOPE TO DRAIN    |           |
| ⑬ STUB COLUMN | ㉒ CRICKET                    |           |
| ⑭ ROOF HATCH  | ㉓ PARAPET/WIDE FLASHING      |           |
| ⑮ SCUPPER     | ㉔ LIFE LINE ANCHOR           |           |

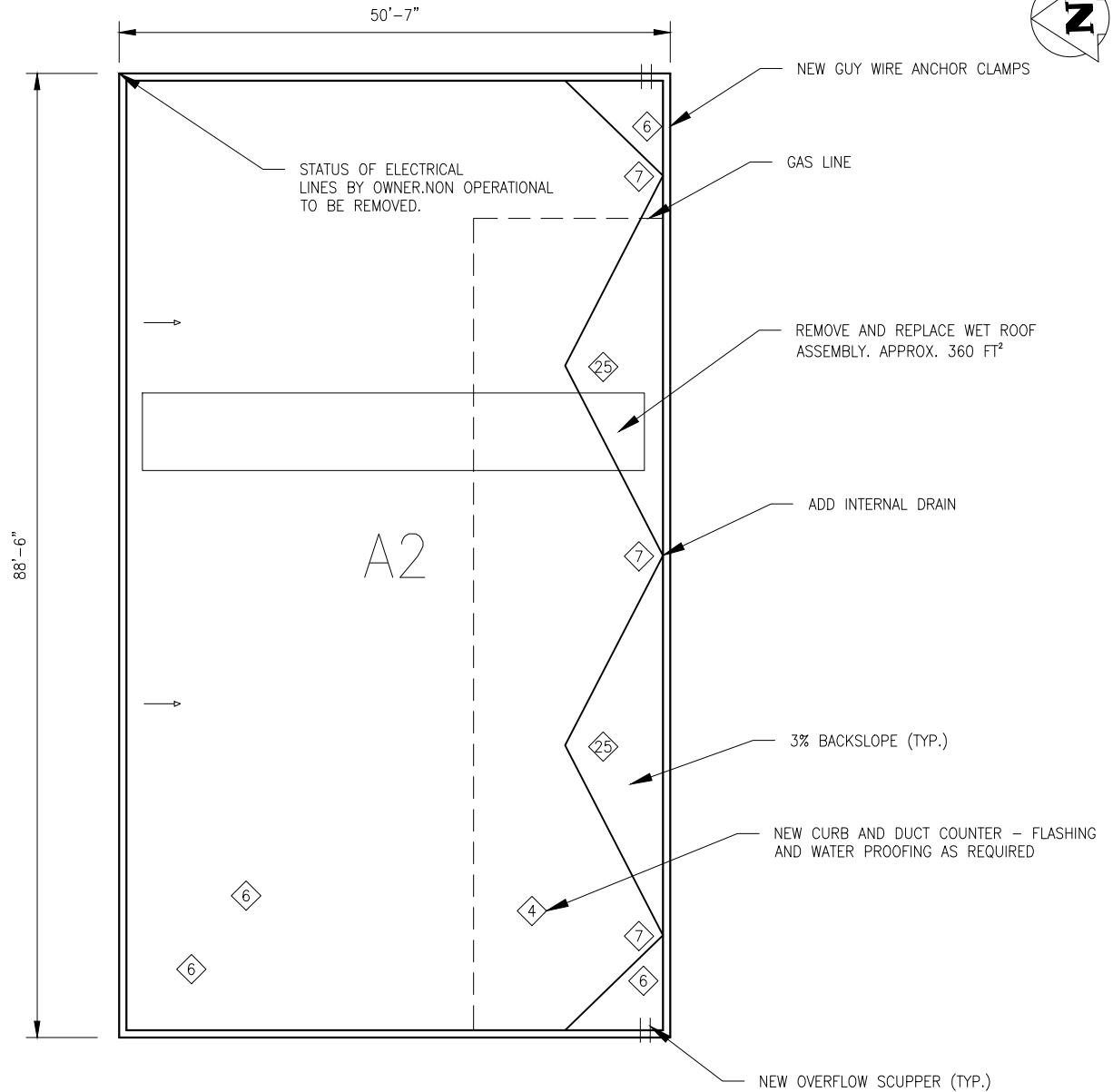

**QCA BUILDING  
ENVELOPE LTD.**

PROJECT NAME: CENTRAL CORYDON COMMUNITY CENTRE

PROJECT NO.: 417-2018

File: 417-2018\_Drawing\_A-2-R0

SCALE: 1/16"=1'-0"

SHEET NO: **A2-R0**