

Section B

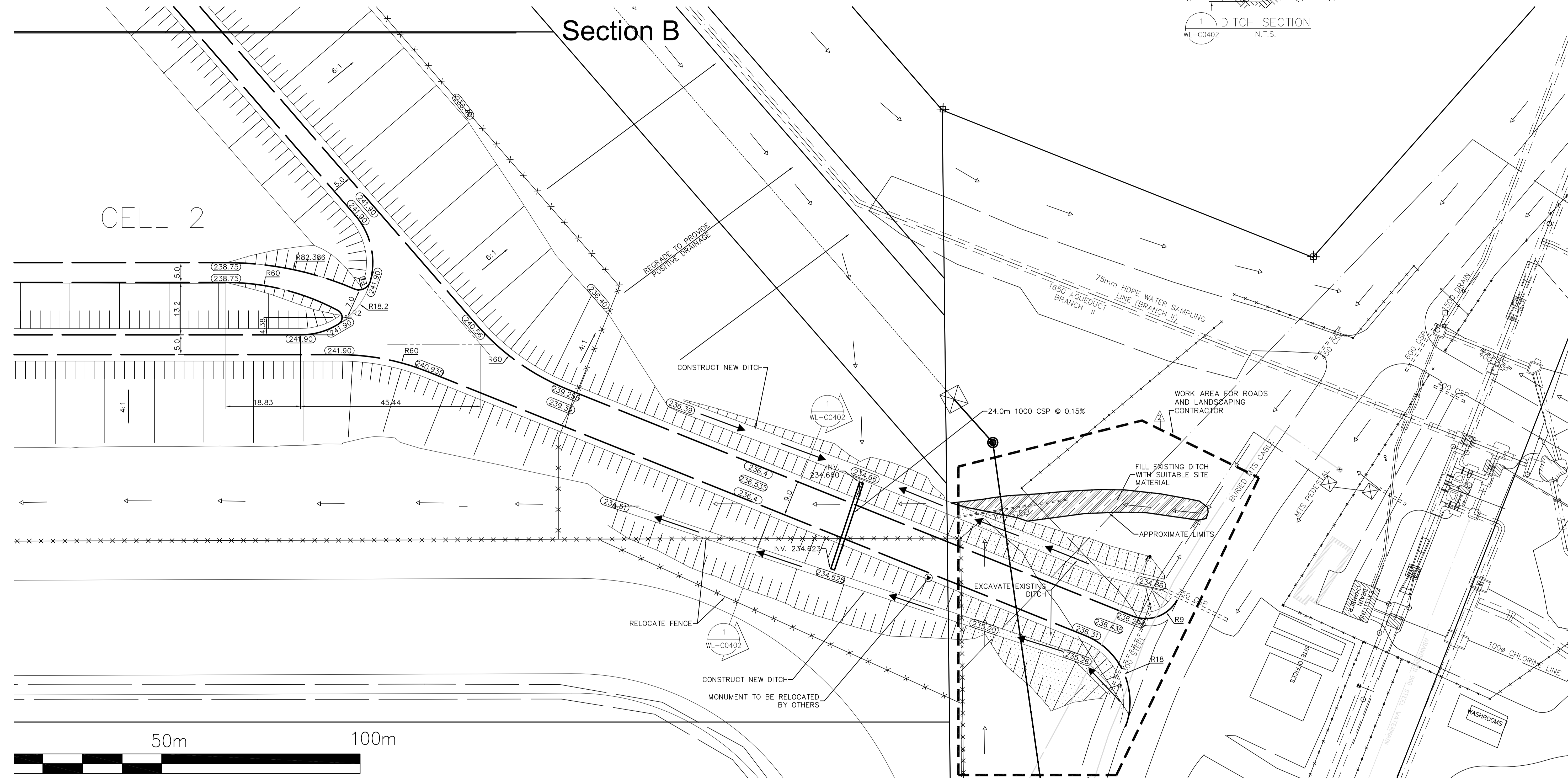

- NOTES:
1. CONSTRUCT NEW CULVERTS IN ACCORDANCE WITH CITY OF WINNIPEG STANDARD CONSTRUCTION SPECIFICATIONS CW 3610.
 2. SALVAGE EXISTING CULVERT AND DELIVER TO CITY YARD AS DIRECTED

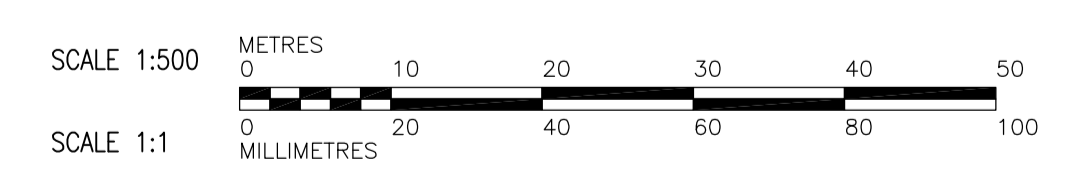

150 mm W.M.	WATERMAIN	150 mm W.M.	HYDRO	HYDRO	LIGHT STANDARD	
◇	HYDRANT	+	M.T.S.	M.T.S.	ANCHOR	
⊙	VALVE	○	CONCRETE	CONCRETE	POLE	
300mm L.D.S.	LAND DRAINAGE SEWER	300mm L.D.S.	ASPHALT	ASPHALT	CONTOURS	
250mm W.W.S.	WASTEWATER SEWER	250mm W.W.S.	PROPERTY LINE	PROPERTY LINE	RAIL X-ING SIGNAL	
○	MANHOLE	⊕	SURVEY BAR	SURVEY BAR	RAILWAY TRACK	
□	CATCH BASIN	232.750	ELEVATION	ELEVATION	DITCH	
▽	CURB INLET	3500	TREE	TREE	TEST HOLE	
+	JUNCTIONS		ANODE	ANODE		
—	CULVERT		CONCRETE SIDEWALK	CONCRETE SIDEWALK		
—	GAS		FENCE	FENCE		
---	EXISTING	---	EXISTING	EXISTING	LEGEND - PLAN	PROPOSED
---	LEGEND - PLAN	---	PROPOSED	PROPOSED	LEGEND - PLAN	PROPOSED

APECA
 Certificate of Authorization
 Earth Tech Canada Inc.
 No. 730 Expiry: April 30, 2006

B.M. ELEV.			
DESIGNED BY	GK	CHECKED BY	SRB
DRAWN BY	JS	APPROVED BY	DJT
SCALE:	1:500	RELEASED FOR CONSTRUCTION BY:	R. SOROKOWSKI
NO. REVISIONS		DATE	06/03/07
		DATE	2006/01/02

CH2MHILL
 Frederickson Cooper
 ARCHITECTS

EarthTech
 A Tyco International Ltd. Company

ENGINEER'S SEAL
 ORIGINAL SIGNED BY
 S.R. BILEVICIUS
 2006/03/07

THE CITY OF WINNIPEG
 WATER AND WASTE DEPARTMENT
 ENGINEERING DIVISION

WATER TREATMENT PLANT
 CONSTRUCTION OF DEWATERING CELLS

CITY FILE NUMBER
 SHEET OF

CIVIL
 ROAD GEOMETRY AND GRADING DETAILS
 PART PLAN SHEET 2

CITY DRAWING NUMBER
 1-06011-D-C0402-001-02D