

NOTES :  
SEE SHEET A1 NOTES.

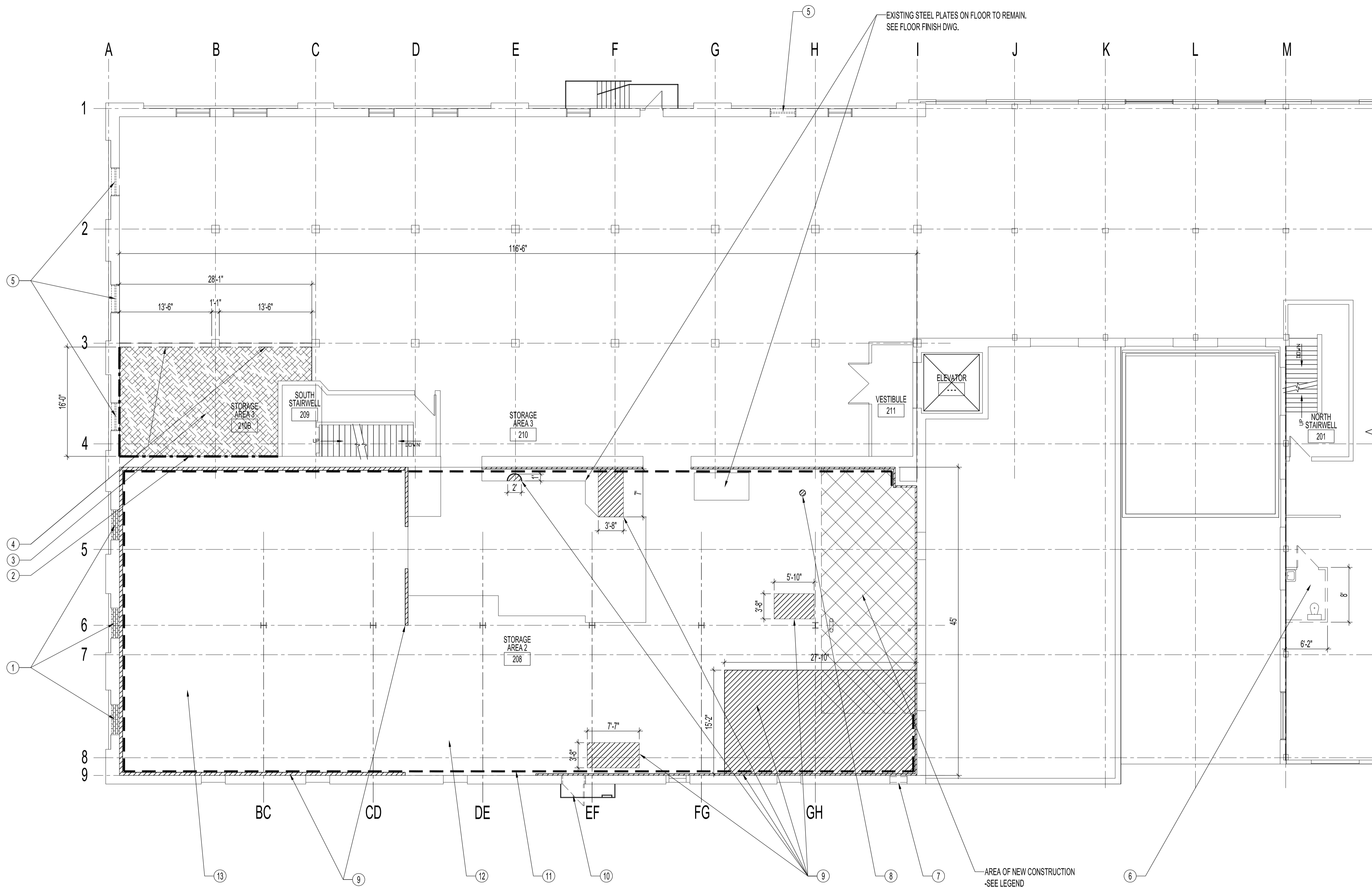

**PARTIAL SECOND FLOOR PLAN - FLOOR & WALL DEMOLITION**  
SCALE: 1/8" = 1'-0"

LEGEND	
	EXISTING DOORS TO BE DEMOLISHED -SEE NOTES (6) (10)
	EXISTING WALLS TO BE DEMOLISHED. -SEE NOTES (4) (6)
	EXISTING GLAZING UNITS TO BE DEMOLISHED. -SEE NOTE (5)
	EXISTING ORIGINAL GLAZING OPENINGS TO BE DEMOLISHED OF MASONRY BLOCK & BRICKWORK. -SEE NOTE (1)
	STORAGE AREA #3 210B EXISTING FLOORING & SUB FLOOR TO BE DEMOLISHED DOWN TO HARDWOOD FLOORING. -SEE NOTE (3)
	STORAGE AREA #2 208 AREAS TO BE FILLED W/ FLOOR LEVELLING COMPOUND FLUSH W/ EXISTING FLOOR LEVELS -SEE NOTE (9)
	STORAGE AREA #2 208 AREA OF FLOOR WHERE NEW CONSTRUCTION & NEW SUB-FLOOR IS TO BE INSTALLED. -SEE RENOVATION DWG.
	STORAGE AREA #3 210B DEMOLISH WALLS PANELING, FRAMING ETC. SEE NOTE (2)
	STORAGE AREA 208 WALL AREAS THAT REQUIRE SCRAPPING, BRICKWORK REPLACEMENT & REPOINTING. SEE NOTE (11)
 REMOVE EXISTING "ASBESTOS TILE". NOTE: ASBESTOS TILE FLOOR REMOVAL TO FOLLOW HAZARDOUS MATERIAL STANDARD PROCEDURES FOR REMOVAL.	

**DEMOLITION /RENOVATION NOTES:**

- DEMOLISH & DISCARD THREE (3) EXISTING 6" MASONRY BLOCK WALL & 4" FACEBRICK & OTHER MATERIALS IN ORIGINAL CLOSED-IN WINDOW OPENINGS. FRAME OPENINGS AS REQUIRED & PREPARE FOR NEW FIBERGLAS WINDOWS. SEE SHEETS A5 & A7.
- DEMOLISH & DISCARD EXISTING PANELING & FRAMING ON WALLS DOWN TO EXISTING BRICKWORK ON SOUTH WALL AND EXISTING GYPSUM BOARD ON EAST WALL. PATCH WALLS & PREPARE FOR PAINTING. SEE RENOVATION DWG. SEE REFLECTED CEILING PLAN FOR DEMOLITION.
- DEMOLISH & DISCARD EXISTING FLOORING, SUB-FLOORING & OTHER MATERIALS IN ENTIRE ROOM DOWN TO EXISTING HARDWOOD FLOORS. PATCH HOLES IN FLOOR & PREPARE SURFACE FOR PAINTING TO MATCH EXISTING FLOOR AREA IN STORAGE AREA 210. SEE LEGEND & FLOOR FINISH DWG.
- DEMOLISH & DISCARD EXISTING FLOOR TO CEILING WALLS BETWEEN COLUMNS & BETWEEN FLOOR JOISTS. SEE RENOVATION DWG. SEE MECH. & ELEC DWGS. FOR DEMOLITION & RENOVATION.
- DEMOLISH & DISCARD FOUR (4) EXISTING GLAZING UNITS AND FRAMES. PREPARE OPENINGS FOR NEW FIBERGLAS WINDOWS. SEE SHEETS A5 & A7.
- REMOVE & DISCARD EXISTING WALL HUNG LAVATORY & WATER CLOSET, PLUMBING FIXTURES, PIPES ETC. SEE MECH. & ELEC. DWG FOR DEMOLITION. DEMOLISH & DISCARD WALLS, DOOR & FRAME & ACOUSTIC CEILING. PATCH FLOOR, WALLS & CEILING AND PAINT TO MATCH EXISTING ON SITE IN ADJACENT AREA.
- DEMOLISH & DISCARD EXISTING ABANDONED METAL FAN & FRAME. PREPARE OPENING FOR NEW BRICKWORK ON INTERIOR & EXTERIOR. SEE NOTE (11) & LEGEND.
- DEMOLISH & DISCARD 6" Ø FLOOR DRAIN & ABANDONED PIPING EXTENSION (APPROX. 2'-0") BELOW FLOOR LEVEL. FIRE STOP FLOOR OPENING. SEE LEGEND ON A1 FOR FIRE STOPPING.
- SUPPLY & INSTALL GROUT TO EXISTING AREAS FLUSH WITH EXISTING FLOOR SURFACES. SOME AREAS REQUIRE REMOVAL OF CONCRETE EDGES FLUSH WITH EXISTING FLOOR. GROUTED AREA TO BE PREPARED & TREATED FOR A PAINT FINISH. ADDITIONAL AREAS MAY REQUIRE PATCHING THAT ARE NOT SHOWN ON DWG. TOTAL AREA EQUALS 770 SQ. FT.
- DEMOLISH & DISCARD EXISTING EXIT DOOR DOWN TO FRAME. PREPARE OPENING FOR NEW ENCLOSURE. SEE RENOVATION DWG.
- SCRAPE ALL WALLS OF LOOSE PAINT, GLUES, OTHER MATERIALS & DIRT IN AREA SHOWN. SUPPLY & INSTALL BRICKWORK, REPOINTING, (WEATHER-TIGHT) TO PATCH ENTIRE STORAGE AREA 208 AS REQUIRED. TOTAL REPLACEMENT & REPOINTING IS APPROX. 200 SQ. FT. SEE LEGEND.
- ENTIRE FLOOR IN STORAGE 208 TO BE WASHED & CLEANED TO TAKE NEW PAINT OR NEW SUB FLOOR IN RENOVATED AREA. SEE FLOOR FINISH DWG.

ORIGINAL STAMPED BY: R.K.FOK LI Arch.  
DATE: 2008.12.02

SEE ADDENDUM 1 BID OPPORTUNITY 878-2008 MMK 2008.12.03  
-ADDED FLOORING NOTE IN LEGEND

NO.	REVISION/DESCRIPTION	BY	DATE

DRAWN BY: MMK  
DATE: 2008.11.25  
CHECKED BY: USER APPROVAL  
APPROVED

CITY OF WINNIPEG  
PLANNING, PROPERTY AND  
DEVELOPMENT DEPARTMENT  
CIVIC ACCOMMODATIONS DIVISION  
300 - 65 GARRY ST. R3C 4K4

PROJECT  
SURPLUS STORAGE FACILITY  
MAIN & SECOND FLOOR RENOVATION

311 ROSS AVENUE  
SHEET TITLE

PARTIAL SECOND FLOOR PLAN  
FLOOR & WALL  
DEMOLITION /RENOVATION

SCALE: AS SHOWN  
PROJECT NO.: 2008-016-02  
SHEET NO.: A3R1