

FINISH NOTES

- ① ALL FINISHES LISTED ON THE FINISH LEGEND ON DRAWING A1.5 ARE THE SELECTED PRODUCTS OF THE PUBLIC WORKS DEPARTMENT FOR DURABILITY AND FUNCTIONALITY. HOWEVER ALTERNATE FINISHES AND OR PRODUCTS MAY BE CONSIDERED AS AN APPROVED SUBSTITUTE IN ACCORDANCE WITH B7 AS PER THE TENDER DOCUMENTS.
- ② 4" HIGH RUBBER COVERED BASE REQUIRED WITH NEW CARPET TILE. RUBBER BASE TO BE JOHNSONITE REGULAR STANDARD TOE SERIES. 6" HIGH REQUIRED IN RECEPTION 102 ON DESK BASE ONLY.
- ③ QUARRY TILE TO BE INSTALLED IN A "BRICK" LAYOUT AS DRAWN. GROUT TO BE EPOXY GROUT; 4" HIGH QUARRY TILE BASE WHEREVER FLOOR TILE IS LOCATED. FLOOR TO BE SKIM COATED AND FLOATED TO PREPARE FLOOR FOR NEW FLOOR TILE.
- ④ TRANSITION EDGES BETWEEN FLOORING TYPES REQUIRED. REFER TO FINISH LEGEND.
- ⑤ ALL EXISTING WALLS TO BE REPAINTED. LATEX ACRYLIC LOW VOC PAINT REQUIRED. TWO FINISH COATS REQUIRED. PATCH AND FILL ANY EXISTING DAMAGE TO PREPARE WALLS FOR PAINTING.
- ⑥ NEW WALLS TO BE PAINTED WITH ONE PRIMER COAT, TWO FINISH COATS OF LATEX ACRYLIC LOW VOC PAINT REQUIRED. PATCH AND FILL ANY EXISTING HOLES TO PREPARE WALLS FOR PAINTING. PAINT SAMPLES TO BE SUBMITTED FOR APPROVAL TO C.O.W PRIOR TO PAINTING.
- ⑦ EXISTING CHERRY WOOD WALL PANELING TO REMAIN.
- ⑧ NEW WOOD WALL PANELING TO MATCH EXISTING SPECIES REQUIRED. 24" X 24" SQUARE PANELS WITH POLISHED CHROME REVEALS. STAIN SAMPLES TO BE SUBMITTED FOR APPROVAL PRIOR TO CONSTRUCTION.
- ⑨ NOT USED.
- ⑩ PROVIDE FLOOR EXPANSION JOINT IN TILE. SITE CONFIRM BEST LOCATION TO DEAL WITH FLOOR HEAVE IN VESTIBULE 100. PROVIDE ALLOWANCE FOR EXPANSION JOINTS IN LOBBY 101 AND MEDIA AREA 106. SITE CONFIRM AFTER DEMOLITION IF REQUIRED IN THESE TWO AREAS RECEIVING TILE.
- ⑪ INSTALLATION OF TILE AS PER N.M.S SECTION 09 03 15 PORCELAIN TILING, INCLUDED IN THE TENDER DOCUMENTS

FINISH LEGEND

- ACT-1: ACOUSTIC CEILING TILE
 CGC CEILINGS; MARS HIGH NRC LOGIX FIELD PANELS # 86160
 COLOR: WHITE
 SIZE: 24"x60" (CONFIRM SIZE ON SITE)
 EDGE: SQUARE EDGE (SQ)
 TO BE INSET INTO EXISTING CEILING GRID
- CPT-1: CARPET TILE
 MANUFACTURER: SHAW CONTRACT
 STYLE: DIRECTION TILE 5T071; 100% SOLUTION DYED NYLON
 COLOR: VISTA 69481; SIZE: 24"x24"; 1/12" GAUGE
 INSTALLATION: MONOLITHIC
 USE LOW VOC QUICK RELEASE ADHESIVE; CONTRACTOR TO PROVIDE 3 BOXES EXTRA MATERIAL
- CG-1: CORNER GUARDS
 FROST # MODEL #1117; 4"D x4"W X 40" H
 18 GA. STAINLESS STEEL TYPE 304 #4 BRUSHED FINISH
 PLAM-1: P.E.T IMBEDDED LAMINATE PRODUCT
 FORMATIONS INC; ONBORD 3/2" THICK PANELS; SIZE: 4'X9'
 COLOR: SERICA CHARCOAL NL 7462; MATTE FINISH
 DISTRIBUTED BY FORMATIONS WINNIPEG.
- PT-1: PAINT (MAIN)
 PRODUCT: DULUX PAINTS
 COLOR: DLX1008-2 STORM'S COMING
 FINISH: EGGSHELL- 1 PRIMER COAT, 2 FINISH COATS
- PT-2 PAINT (ACCENT WALL COLOR)
 PRODUCT: DULUX PAINTS
 COLOR: DLX1010-5 DOWNPOUR
 FINISH: EGGSHELL- 1 PRIMER COAT, 2 FINISH COATS
- PT-3 PAINT (DOOR FRAME COLOR)
 PRODUCT: DULUX PAINTS
 COLOR: DLX1010-6 UP IN SMOKE
 FINISH: SEMIGLOSS- 1 PRIMER COAT, 2 FINISH COATS
- PT-4: PAINT (CEILING)
 PRODUCT: BENJAMIN MOORE PAINTS REGAL SELECT LATEX PAINT
 COLOR: OC-17 WHITE DOVE
 FINISH: FLAT- 1 PRIMER COAT, (NEW DRYWALL) 2 FINISH COATS
- QT-1: QUARRY TILE
 PRODUCT: OLYMPIA TILE ARKISTONE SERIES; 12"x24"
 COLOR: SILVER MC.AK.SK 1224 MT
 GROUT TO BE MAPEI EPOXY GROUT; COLOR TO BE SELECTED.
 4" HIGH QUARRY TILE BASE
 INSTALLATION: BRICK LAYOUT AS DRAWN.
- RB-1: RUBBER BASE
 JOHNSONITE STANDARD TOE WALL BASE
 HEIGHT: 4" HIGH
 COLOR: FROM COLOR GROUP A-TO BE SELECTED.
- RB-2: RUBBER BASE
 JOHNSONITE STANDARD TOE WALL BASE
 HEIGHT: 6" HIGH
 COLOR: FROM COLOR GROUP A-TO BE SELECTED.
- SS-1: SOLID SURFACE COUNTERTOP
 PRODUCT: WILSONART SOLID SURFACE
 COLOR: 9208CS WHITE STONE
 SHEEN/ FINISH LEVEL: MATTE
 THICKNESS: 0.50" THICK
- ST-1: WOOD STAIN
 COLOR TO MATCH EXISTING DOORS AND WOOD PANELS ON SITE. CONTRACTOR TO PROVIDE COLOR SAMPLES ON SPECIFIED WOOD VENEER FOR APPROVAL.
- TR-1: ADAPTOR TRANSITION STRIP - CARPET TO CARPET
 JOHNSONITE CTA-XX-A; COLOR TO BE SELECTED BY C.O.W
 CONTRACTOR TO ENSURE PROFILE TO SUIT TRANSITION
- TR-2: WHEELED TRAFFIC TRANSITION STRIP- CARPET TO TILE
 JOHNSONITE CTA-XX-J; COLOR TO BE SELECTED BY C.O.W
 CONTRACTOR TO ENSURE PROFILE TO SUIT TRANSITION
- TR-3: EDGE GUARD
 SCHLUTER SCHIENE -A EDGE PROFILE
 CONTRACTOR TO ENSURE PROFILE TO SUIT TRANSITION
- WF-1: INTERIOR COLORED WINDOW FILM
 MACTAC COLORED GLASS FILM- CITY OF WINNIPEG BLUE
 LOCATION: OFFICE /MEETING ROOM WINDOWS

NOTES:
 THESE DRAWINGS SHALL NOT BE SCALED.
 THE CONTRACTOR SHALL VISIT THE SITE AND SATISFY ONESELF ALL DIMENSIONS, DATUM, AND DETAILED INFORMATION SHOWN ARE CORRECT.
 THE CONTRACTOR IS TO REVIEW AND COORDINATE ALL ARCHITECTURAL, MECHANICAL, ELECTRICAL, AND STRUCTURAL DRAWINGS FOR ADDITIONAL OPENINGS THROUGH FLOORS, WALLS, AND CEILINGS FOR DUCT, PIPE & ELECTRICAL RISERS AND ALL OPENINGS NOT SHOWN ON DRAWINGS.
 ALL OPENINGS THROUGH FIRE ASSEMBLIES ARE TO BE FIRE STOPPED AND SEALED WITH ULC APPROVED FIRE STOPPING TO MAINTAIN THE INTEGRITY OF THE FIRE SEPARATION, AND PROVIDE A SMOKE-TIGHT BARRIER.
 ALL PRODUCTS AND MATERIALS TO BE USED AND INSTALLED SHALL CONFORM WITH MANUFACTURER'S SPECIFICATIONS & APPLICABLE CODES.
 THE CONTRACTOR SHALL BE RESPONSIBLE TO PATCH AND MAKE GOOD ALL EXISTING CONSTRUCTION AFFECTED BY THE REMOVAL OF ALL ITEMS FORMING THE PART OF THE RENOVATION WORK.
 WHERE NEW FLOORING AND BASE IS TO BE INSTALLED IN EXISTING AREAS (REFER TO FLOOR PLAN AND ROOM SCHEDULE) THE EXISTING FLOORING SURFACE AND BASE MUST BE REMOVED, UNLESS OTHERWISE NOTED. ALL FLOOR SURFACES SHALL BE PREPARED IN ACCORDANCE TO MANUFACTURER'S RECOMMENDATIONS FOR INSTALLATION OF NEW FLOOR.
 WHERE PAINTING OF EXISTING WALLS IS INDICATED ON THE ROOM SCHEDULE, THESE WALLS MUST BE CLEANED OF ANY EXISTING WALL COVERING, PATCHED & PREPARED TO ACCEPT NEW MATERIAL, UNLESS OTHERWISE NOTED.

ORIGINAL STAMPED BY: FIRST LAST, XXXX
 DATE: YEAR.MM.DD

2	ADDENDUM # 2	MAR. 17, 2021
1	ISSUED FOR CONSTRUCTION	MAR. 1, 2021
No.	REVISION/DESCRIPTION	BY DATE

DATE	2021.03.01	USER	APPROVAL
DRAWN	KJN	CHECKED	KJN
DESIGNED	KJN	APPROVED	

THE CITY OF WINNIPEG
 PLANNING, PROPERTY AND
 DEVELOPMENT DEPARTMENT
 MUNICIPAL ACCOMMODATIONS DIVISION
 3-65 GARRY STREET, R3C 4K4

PROJECT
 PUBLIC WORKS DEPARTMENT
 SECURITY AND ACCESSIBILITY UPGRADES

1155 PACIFIC AVENUE, WINNIPEG, MB. TENDER # 139-2021

SHEET TITLE
 FLOOR AND FINISH PLAN
 INTERIOR FINISHES

SCALE: 1/4"=1'-0"
 PROJECT No.: 2019-002
 SHEET No.: A1.3R1

DRAWING SHEET SIZE: A1 (841mm x 594mm) PLOT 1:1

1 NEW FLOOR AND FINISH PLAN
 SCALE: 1/4"=1'-0"

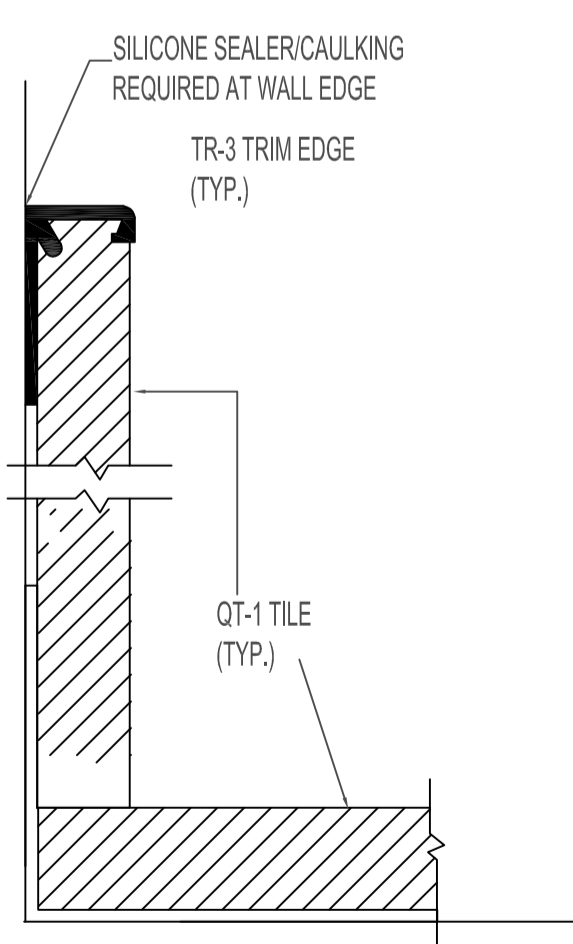

2 TILE SCHLUTER TRIM DETAIL
 SCALE: N.T.S

ROOM FINISH SCHEDULE

ROOM NO.	ROOM NAME	FLOOR	BASE	NORTH WALL	SOUTH WALL	EAST WALL	WEST WALL	CEILING	CEILING HEIGHT	NOTES
100	VESTIBULE	QT-1	QT-1	PT-1	PT-1	PT-1	PT-1	EX.GWB/PT-4	8'-6"	NOTE:3
101	LOBBY	QT-1	QT-1	N/A	PT-1	PT-1	PT-1	EX.GWB/PT-4	8'-6"	NOTE:3
102	RECEPTION/ PERMITS	CPT-1	RB-1&2	WD/EX	N/A	PT-1	PT-1	EX.GWB/PT-4	VARIES	NOTE:1
103	CORRIDOR	CPT-1	RB-1	PT-2	N/A	PT-1	PT-2	ACT-1/PT-4	8'-6"	NOTE:1
104	MEETING ROOM	CPT-1	RB-1	PT-1	PT-1	GL/ PT-1	PT-2	ACT-1	8'-6"	NOTE:1
105	PARKS BOOKING OFFICE	CPT-1	RB-1	PT-1	PT-1	GL/ PT-1	ST-1/PT-2	ACT-1	8'-6"	NOTE:1
106	MEDIA AREA	CPT-1	CPT-1	PT-2	PT-2	PT-1	WD/ST-1	ACT-1	8'-6"	NOTE:1
107	OPEN OFFICE AREA	EX	EX	PT-2	EX	PT-2	N/A	EX ACT	8'-6"	NOTE:1NOTE:4
111	OPEN OFFICE AREA	EX	EX	N/A	PT-2	N/A	N/A	EX ACT	8'-6"	NOTE:1NOTE:4

ABBREVIATIONS: ACT.-ACOUSTIC TILE CPT - CARPET TILE EX.- EXISTING GL. - GLASS PT. -PAINT RB.- RUBBER BASE
 QT.- QUARRY TILE ST- STAINED WOOD WD.- EXISTING WOOD PANELS

NOTE: 1- ALL NEW DOORS ARE MAPLE WOOD VENEER AND TO BE STAINED TO MATCH EXISTING. FRAMES TO BE HOLLOW METAL PAINTED PT-3.
 NOTE: 2- REFER TO INTERIOR ELEVATIONS FOR PAINT LOCATIONS.
 NOTE: 3- LOBBY AND VESTIBULE DOORS AND FRAMES PREFINISHED AND NOT TO BE PAINTED
 NOTE: 4- BOTH SIDES OF NEW WALL TO BE PAINTED.