

NOTES:
THIS DRAWING MUST NOT BE SCALED.
THE CONTRACTOR SHALL VERIFY ALL DIMENSIONS, DATUMS, AND LEVELS PRIOR TO COMMENCEMENT OF WORK. ALL ERRORS AND OMISSIONS TO BE REPORTED TO THE CONTRACT ADMINISTRATOR BEFORE PROCEEDING.
VARIATIONS AND MODIFICATIONS TO WORK SHOWN ON THESE DRAWINGS SHALL NOT BE CARRIED OUT WITHOUT WRITTEN PERMISSION OF THE CONTRACT ADMINISTRATOR.
THIS DRAWING IS THE EXCLUSIVE PROPERTY OF NUMBER TEN ARCHITECTURAL GROUP AND THE COPYRIGHT IN THE SAME BEING ASSIGNED TO THEM. IT MAY BE REPRODUCED ONLY WITH THE PERMISSION OF THE CITY OF WINNIPEG.

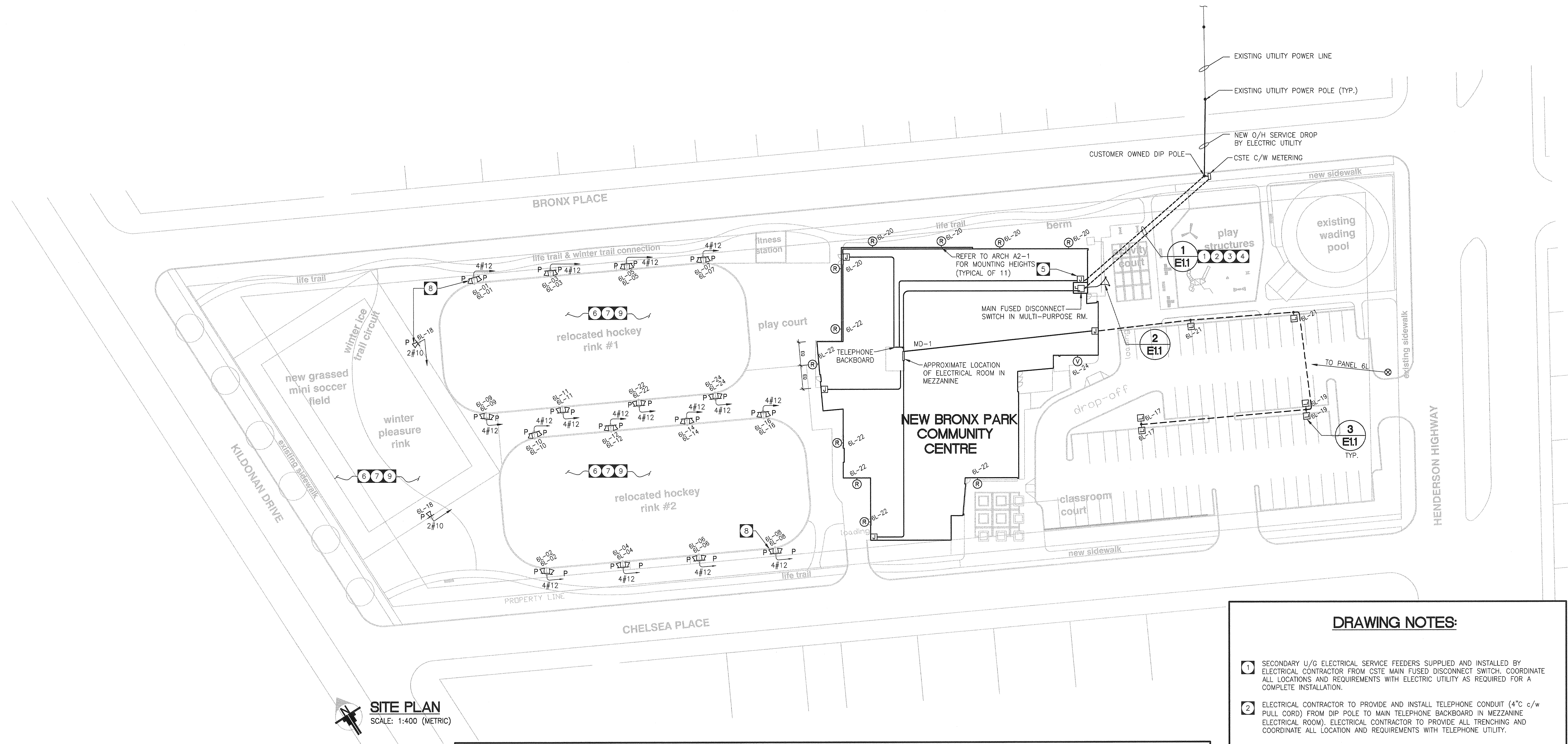

DRAWING LIST	
E-10	ELECTRICAL DEMOLITION SITE PLAN
E-11	ELECTRICAL SITE PLAN
E-20	ELECTRICAL LIGHTING LAYOUT - MAIN FLOOR
E-30	ELECTRICAL POWER & SYSTEMS LAYOUT - MAIN FLR
E-40	ELECTRICAL MEZZANINE & DETAILS
E-50	ELECTRICAL PANEL SCHEDULES
E-51	ELECTRICAL SINGLE LINE DIAGRAM & SCHEDULES

LEGEND			
	STRIP FLUORESCENT LIGHT (CA DENOTES TYPE)		DUPLEX RECEPTACLE - CEILING MOUNTED
	1'x4' FLUORESCENT LIGHT (A DENOTES TYPE)		DUPLEX RECEPTACLE
	H.I.D. OR INCANDESCENT FIXTURE (C DENOTES TYPE)		DUPLEX RECEPTACLE - ABOVE COUNTER (GFG)
	WALL MOUNTED LIGHT FIXTURE (D DENOTES TYPE)		DUPLEX RECEPTACLE - GROUND FAULT CIRCUIT INTERRUPTER
	LIGHT STANDARD (G DENOTES TYPE)		FOURPLEX RECEPTACLE (QUAD)
	LIGHT STANDARD (2 DENOTES LAMP COUNT)		JUNCTION BOX CEILING MOUNTED
	LIGHT FIXTURE ON NIGHT LIGHT CIRCUIT		120V JUNCTION BOX WALL MOUNTED
	EMERGENCY LIGHT (REMOTE - 2 HEADS)		DOOR OPERATING CONTROL PUSH BUTTON
	EXIT LIGHT C/W DIRECTIONAL ARROWS AS SHOWN		DIRECT CONNECT
	EMERGENCY BATTERY BANK UNIT C/W HEAD LIGHTS		POWER PANELBOARD - SURFACE MOUNT/FLUSH MOUNT
	SINGLE POLE SWITCH (3 DENOTES 3 WAY SWITCH)		SYSTEM PANELBOARD - SURFACE MOUNT/FLUSH MOUNT
	MOTION SENSOR SWITCH (WALL MOUNTED)		TRANSFORMER
	DIMMER SWITCH		TELEPHONE BACKBOARD
	PUSH BUTTON		VOICE/DATA OUTLET
	TIMECLOCK		DOOR CONTACT (FLUSH IN FRAME)
	NURSE CALL SYSTEM DOME LIGHT		WIRE GUARD
	PUBLIC ADDRESS SYSTEM SPEAKER		FUSED DISCONNECT SWITCH
			MOTOR AND DISCONNECT
			BASEBOARD HEATER (1000 DENOTES 1000 WATTS)
			FORCE FLOW HEATER
			UNIT HEATER
			THERMOSTAT
			SPEED CONTROL SWITCH
			SMOKE DETECTOR (ADDRESSABLE)
			HEAT DETECTOR (COMBINATION)
			MANUAL PULL STATION
			FIRE ALARM SIGNAL HORN & STROBE
			SIGNAL HORN
			SPRINKLER FLOW SWITCH
			SPRINKLER TAMPER PROOF VALVE
			EXISTING TO BE REMOVED
			EXISTING TO REMAIN
			RELOCATED EXISTING (SHOWN IN NEW LOCATION)

DRAWING NOTES:

- SECONDARY U/G ELECTRICAL SERVICE FEEDERS SUPPLIED AND INSTALLED BY ELECTRICAL CONTRACTOR FROM CSTE MAIN FUSED DISCONNECT SWITCH. COORDINATE ALL LOCATIONS AND REQUIREMENTS WITH ELECTRIC UTILITY AS REQUIRED FOR A COMPLETE INSTALLATION.
- ELECTRICAL CONTRACTOR TO PROVIDE AND INSTALL TELEPHONE CONDUIT (4" c/w PULL CORD) FROM DIP POLE TO MAIN TELEPHONE BACKBOARD IN MEZZANINE ELECTRICAL ROOM. ELECTRICAL CONTRACTOR TO PROVIDE ALL TRENCHING AND COORDINATE ALL LOCATION AND REQUIREMENTS WITH TELEPHONE UTILITY.
- ALL TRENCHING BY ELECTRICAL CONTRACTOR. REFER TO ALL SITE RELATED TRENCH DETAILS.
- ELECTRICAL CONTRACTOR SHALL REFER TO MECH. DWGS, ARCHITECTURAL SITE PLAN & SURVEY PLAN FOR LOCATIONS OF BURIED LINES. COORDINATION IS REQUIRED. CONFIRM ALL U/G SERVICES AND LINES ON SITE WITH APPROPRIATE UTILITIES. THIS DRAWING IS SCHEMATIC, SHALL BE USED AS A REFERENCE ONLY AND MAY NOT INDICATE EVERY BURIED LINE, PIPE OR CONDUCTOR.
- ALL SITE RELATED FEEDERS TO ENTER BUILDING AT THIS LOCATION (RUN UNDER FOUNDATION AND PROVIDE RIGID CONDUIT SLEEVE WHERE PASSING THROUGH CONCRETE FLOOR INTO BUILDING). EXTEND FEEDERS IN CONDUIT TO APPLICABLE LOADS. PROVIDE JUNCTION BOXES, FULLBOXES, SPLITTER, ETC. AS REQUIRED.
- PROVIDE SEPARATE CONTROL/SWITCHING FOR RINK LIGHTING AS FOLLOWS:
RLC-1 RINK #1
RLC-2 RINK #2
RLC-3 WINTER RINK
- PROVIDE ALL REQUIRED ADDITIONAL MOUNTING HARDWARE FOR POLE MOUNTED LUMINAIRES.
- PROVIDE PHOTO CELL CONTROL FOR LUMINAIRES INDICATED.
- REFER TO PANEL SCHEDULE FOR FEEDER SIZES.

TOWER PROJECT NO.: 6150

TOWER ENGINEERING GROUP
208 - 697 COURTON AVE. WINNIPEG, MB. R3M 0M7
TEL: (204) 925-1150 FAX: (204) 925-1155
EMAIL: towereng@towereng.ca WEB: www.towereng.ca

numberTEN architectural group
winipeg MB 204.942.0983 victoria BC 250.360.3106

architecture • interior design • graphic design

NO.	REVISED/ISSUED/ PLOTTED	DATE
△	DESIGN DEVELOPMENT SUBMISSION	31/AUG/07
△	ISSUED FOR 40% REVIEW	26/OCT/07
△	ISSUED FOR 60% REVIEW	07/DEC/07
△	ISSUED FOR 100% REVIEW	11/JAN/08
△	ISSUED FOR TENDER	18/JAN/08

NO.	REVISION/DESCRIPTION	BY	DATE
SEALS			

APCGM
Certificate of Authorization
Tower Engineering Group
No. 1918 Expiry: April 30, 2008

DRAWN BY	CHECKED BY	DATE	DATE	DATE
		2007.08.28		

CITY OF WINNIPEG
PLANNING, PROPERTY AND
DEVELOPMENT DEPARTMENT
CIVIC ACCOMMODATIONS DIVISION
300 - 65 GARRY ST. R3C 4K4

PROJECT
BRONX PARK COMMUNITY CENTRE
HOME OF
GOOD NEIGHBOURS SENIOR CENTRE
WINNIPEG, MB

SHEET TITLE
ELECTRICAL
SITE PLAN

SCALE	PROJECT NO.	SHEET NO.
AS SHOWN	PP&D 2006-065	E-1.1

DRAWING SHEET SIZE: ARCH E1 (42" x 30") PLOT 1:1