

1 PROFILE
H=1:500 V=1:20

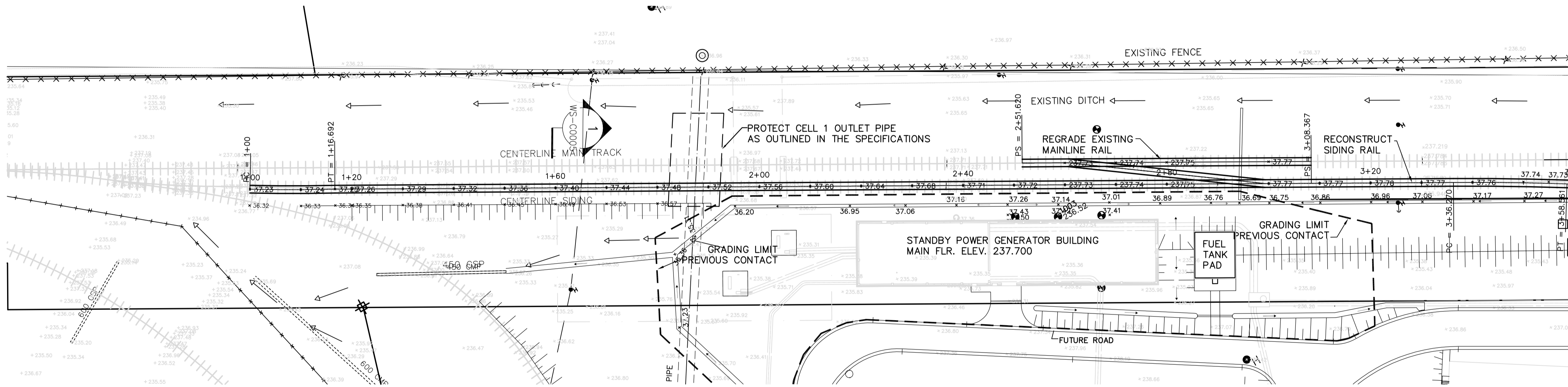

1 PLAN
1:500

BENCHMARK NOTES:

DRAWING COORDINATES ARE UTM NAD83 - SCALE FACTOR 0.99983

B.M. No.	NORTHING	EASTING	ELEVATION
PILE 136	5523873.734	647764.406	236.242
PILE 133	5523256.606	647782.387	236.056

NOTE: PILE No. 136 MAY BE REVISED PRIOR TO CONSTRUCTION. CONTRACT ADMINISTRATOR TO PROVIDE NEW ELEVATION AND COORDINATES.

- REFERENCE NOTES:**
- A. ADD 200.00 TO DESIGN GRADES OBTAIN GEODETIC DATUM
 - B. ALL EXISTING UNDERGROUND UTILITIES SHALL BE CONFIRMED PRIOR TO CONSTRUCTION.
 - C. ALL SITE SURFACE WORKS SHALL BE IN ACCORDANCE WITH THE C.O.W. STANDARD CONSTRUCTION SPECIFICATIONS

INFORMATION ONLY

150 mm W.M.	WATERMAIN	150 mm W.M.	HYDRO	CONCRETE	ASPHALT	PROPERTY LINE	SURVEY BAR	ELEVATION	TREE	ANODE	CONCRETE SIDEWALK	FENCE	EXISTING	LEGEND - PLAN	PROPOSED	EXISTING	LEGEND - PLAN	PROPOSED	EXISTING	LEGEND - PLAN	PROPOSED	EXISTING	LEGEND - PLAN	PROPOSED
⊕	HYDRANT	⊕	M.T.S.	▒	▒	---	—	232.750	⊕	—	▒	—	▒	▒	▒	▒	▒	▒	▒	▒	▒	▒	▒	▒
⊕	VALVE	⊕	CONCRETE	▒	▒	---	—	232.750	⊕	—	▒	—	▒	▒	▒	▒	▒	▒	▒	▒	▒	▒	▒	▒
⊕	LAND DRAINAGE SEWER	⊕	ASPHALT	▒	▒	---	—	232.750	⊕	—	▒	—	▒	▒	▒	▒	▒	▒	▒	▒	▒	▒	▒	▒
⊕	WASTEWATER SEWER	⊕	PROPERTY LINE	▒	▒	---	—	232.750	⊕	—	▒	—	▒	▒	▒	▒	▒	▒	▒	▒	▒	▒	▒	▒
⊕	MANHOLE	⊕	SURVEY BAR	▒	▒	---	—	232.750	⊕	—	▒	—	▒	▒	▒	▒	▒	▒	▒	▒	▒	▒	▒	▒
⊕	CATCH BASIN	⊕	ELEVATION	▒	▒	---	—	232.750	⊕	—	▒	—	▒	▒	▒	▒	▒	▒	▒	▒	▒	▒	▒	▒
⊕	CURB INLET	⊕	TREE	▒	▒	---	—	232.750	⊕	—	▒	—	▒	▒	▒	▒	▒	▒	▒	▒	▒	▒	▒	▒
⊕	JUNCTIONS	⊕	ANODE	▒	▒	---	—	232.750	⊕	—	▒	—	▒	▒	▒	▒	▒	▒	▒	▒	▒	▒	▒	▒
⊕	CULVERT	⊕	CONCRETE SIDEWALK	▒	▒	---	—	232.750	⊕	—	▒	—	▒	▒	▒	▒	▒	▒	▒	▒	▒	▒	▒	▒
⊕	GAS	⊕	FENCE	▒	▒	---	—	232.750	⊕	—	▒	—	▒	▒	▒	▒	▒	▒	▒	▒	▒	▒	▒	▒
⊕	EXISTING	⊕	LEGEND - PLAN	▒	▒	---	—	232.750	⊕	—	▒	—	▒	▒	▒	▒	▒	▒	▒	▒	▒	▒	▒	▒
⊕	PROPOSED	⊕	EXISTING	▒	▒	---	—	232.750	⊕	—	▒	—	▒	▒	▒	▒	▒	▒	▒	▒	▒	▒	▒	▒

<p>Certificate of Authorization Earth Tech Canada Inc. No. 730</p>	<p>B.M. ELEV.</p> <table border="1"> <tr><td>02</td><td>ISSUED FOR CONSTRUCTION</td><td>07-05-25</td><td>PAAP</td></tr> <tr><td>01</td><td>792-2006 ADDENDUM 3</td><td>07/03/26</td><td>JC</td></tr> <tr><td>00</td><td>ISSUED FOR TENDER</td><td>07/01/31</td><td>JC</td></tr> <tr><td>NO.</td><td>REVISIONS</td><td>DATE</td><td>BY</td></tr> </table>	02	ISSUED FOR CONSTRUCTION	07-05-25	PAAP	01	792-2006 ADDENDUM 3	07/03/26	JC	00	ISSUED FOR TENDER	07/01/31	JC	NO.	REVISIONS	DATE	BY	<p>Frederickson Cooper ARCHITECTS</p> <p>DESIGNED BY: BSK DRAWN BY: BSK</p> <p>SCALE: 1:500</p> <p>DATE: 2007/01/31</p>	<p>EarthTech A Tyco International Ltd. Company</p> <p>CHECKED BY: JC APPROVED BY: AHL</p> <p>RELEASED FOR CONSTRUCTION BY: R. SOROKOWSKI</p> <p>DATE: 2007/01/31</p>	<p>ENGINEER'S SEAL</p> <p>ORIGINAL SIGNED BY: J.N. CRANG 07/11/09</p> <p>CONSULTANT DRAWING NO. WS-C0003</p>	<p>THE CITY OF WINNIPEG WATER AND WASTE DEPARTMENT ENGINEERING DIVISION</p> <p>WATER TREATMENT PLANT BULK CHEMICAL BUILDING SODIUM HYPOCHLORITE AND CHEMICAL STORAGE BUILDINGS</p> <p>CITY FILE NUMBER SHEET OF CITY DRAWING NUMBER 1-06015-A-C0003-001-020</p>
		02	ISSUED FOR CONSTRUCTION	07-05-25	PAAP																
01	792-2006 ADDENDUM 3	07/03/26	JC																		
00	ISSUED FOR TENDER	07/01/31	JC																		
NO.	REVISIONS	DATE	BY																		
<p>Certificate of Authorization Earth Tech Canada Inc. No. 730</p>																					