

SEWER SERVICE INFORMATION
REFERENCE MANHOLE MH20004070

DIST. FROM REF. MANHOLE	JUNCTION DIA.	CLOCK REF.	SERVICE TYPE
2.1	100	10	CN
5.4	150	02	JN
13.3	150	10	CX
15.5	150	10	JN
16.3	150	02	CN
20.2	100	02	JX
32.9	150	10	CNI
38.8	100	09	JN
39.6	100	02	JN
55.8	150	02	CNI
55.9	150	10	JN
56.6	150	03	JN
67.3	150	02	JN
76.8	100	10	JN
77.7	150	02	JN

ALL JUNCTION INFORMATION BASED ON CCTV INSPECTION

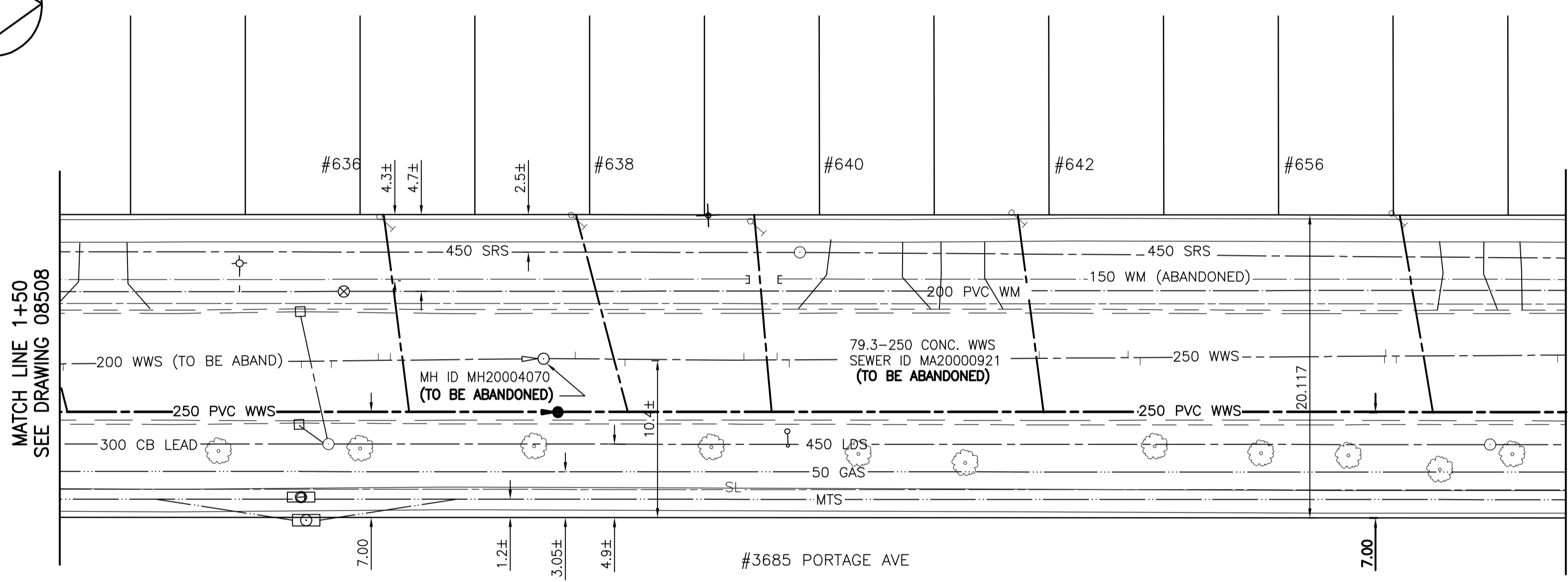

WATER SERVICE INFORMATION

ADDRESS	SIZE (mm) & TYPE (STREET)	DIST TO PROP	SHORT & LONG MEASUREMENT	CORP LOCATION	REMARKS
636 KNOX ST. RESIDENTIAL	19 COPPER	5.2	7.1 NSL BLDG	8.5 N 2ND HYD N OF PORTAGE AVE	--
638 KNOX ST. RESIDENTIAL	19 COPPER	5.2	2.7 NSL BLDG	22.9 N 2ND HYD N OF PORTAGE AVE	--
640 KNOX ST. RESIDENTIAL	19 COPPER	5.2	1.5 NSL BLDG	33.8 N 2ND HYD N OF PORTAGE AVE	--
642 KNOX ST. RESIDENTIAL	19 COPPER	5.2	1.2 NSL BLDG	51.8 N 3RD HYD N OF PORTAGE AVE	--
656 KNOX ST. RESIDENTIAL	19 COPPER	5.2	11.1 NSL BLDG	76.5 N 3RD HYD N OF PORTAGE AVE	--
3685 PORTAGE COMMERCIAL	UNKNOWN	UNKNOWN	UNKNOWN	UNKNOWN	--

SEWER SERVICE INFORMATION

ADDRESS	SIZE	PROPERTY LINE LOCATION	JUNCTION LOCATION
636 KNOX ST. RESIDENTIAL	UNKNOWN	NO INFO AVAILABLE	NO INFO AVAILABLE
638 KNOX ST. RESIDENTIAL	UNKNOWN	NO INFO AVAILABLE	NO INFO AVAILABLE
640 KNOX ST. RESIDENTIAL	UNKNOWN	NO INFO AVAILABLE	NO INFO AVAILABLE
642 KNOX ST. RESIDENTIAL	UNKNOWN	NO INFO AVAILABLE	NO INFO AVAILABLE
656 KNOX ST. RESIDENTIAL	UNKNOWN	NO INFO AVAILABLE	NO INFO AVAILABLE
3685 PORTAGE COMMERCIAL	UNKNOWN	NO INFO AVAILABLE	NO INFO AVAILABLE

WARNING

IF POWER EQUIPMENT OR EXPLOSIVES ARE TO BE USED FOR EXCAVATION ON THIS PROJECT THE CONTRACTOR MUST:
1) NOTIFY THE GAS COMPANY OF THE PROPOSED LOCATION OF EXCAVATION.
2) TAKE PRECAUTION TO AVOID DAMAGE TO GAS COMPANY INSTALLATIONS.
SEE PROVINCIAL REGULATION 140/92 FOR DETAILS

METRIC

WHOLE NUMBERS INDICATE MILLIMETRES
DECIMALIZED NUMBERS INDICATE METRES

NOTES:

- STATIONS ALONG W P OF KNOX ST.
- ALL SEWER SERVICES TO BE RENEWED TO P.
- NEW SEWER TO BE INSTALLED BY TRENCHLESS METHODS.

BENCH MARK: N.W. COR. BUCHANAN BLVD. & FAIRLANE AVE., TBLT ON TOP OF 0.05m DIA. x 2.4m IRON PIPE ON W.L. OF BUCHANAN BLVD. & 2m S. OF N.L. FAIRLANE AVE.

BID OPPORTUNITY 391-2008



LEGEND-PLAN	PROPOSED	EXISTING	LEGEND-PLAN	PROPOSED	EXISTING	LEGEND-PROFILE	PROPOSED	EXISTING
150 WM	150 WM	150 WM	HYDRO	HYDRO	HYDRO	150 WM	150 WM	150 WM
300 LDS	300 LDS	300 LDS	M.T.S.	M.T.S.	M.T.S.	300 LDS	300 LDS	300 LDS
250 WWS	250 WWS	250 WWS	CONCRETE	CONCRETE	CONCRETE	250 WWS	250 WWS	250 WWS
MANHOLE	MANHOLE	MANHOLE	ASPHALT	ASPHALT	ASPHALT	LAND DRAINAGE SEWER	LAND DRAINAGE SEWER	LAND DRAINAGE SEWER
CATCH BASIN	CATCH BASIN	CATCH BASIN	SIDEWALK	SIDEWALK	SIDEWALK	WASTE WATER SEWER	WASTE WATER SEWER	WASTE WATER SEWER
CURB INLET	CURB INLET	CURB INLET	PROPERTY LINE	PROPERTY LINE	PROPERTY LINE	Q PROFILE	Q PROFILE	Q PROFILE
JUNCTIONS	JUNCTIONS	JUNCTIONS	SURVEY BAR	SURVEY BAR	SURVEY BAR	NORTH OR WEST GUTTER	NORTH OR WEST GUTTER	NORTH OR WEST GUTTER
CULVERT	CULVERT	CULVERT	DITCH	DITCH	DITCH	SOUTH OR EAST GUTTER	SOUTH OR EAST GUTTER	SOUTH OR EAST GUTTER
GAS	GAS	GAS	CURB STOP	CURB STOP	CURB STOP	NORTH OR WEST P	NORTH OR WEST P	NORTH OR WEST P
EXISTING	LEGEND-PLAN	PROPOSED	TREE	TREE	TREE	SOUTH OR EAST P	SOUTH OR EAST P	SOUTH OR EAST P
			FENCE	FENCE	FENCE	NORTH OR WEST DITCH	NORTH OR WEST DITCH	NORTH OR WEST DITCH
						SOUTH OR EAST DITCH	SOUTH OR EAST DITCH	SOUTH OR EAST DITCH

LOCATION APPROVED UNDERGROUND STRUCTURES

SUPV. U/G STRUCTURES COMMITTEE	DATE

NOTE:
LOCATION OF UNDERGROUND STRUCTURES AS SHOWN ARE BASED ON THE BEST INFORMATION AVAILABLE BUT NO GUARANTEE IS GIVEN THAT THE GIVEN LOCATIONS ARE EXACT. CONFIRMATION OF EXISTENCE AND EXACT LOCATION OF ALL SERVICES MUST BE OBTAINED FROM THE INDIVIDUAL UTILITIES BEFORE PROCEEDING WITH CONSTRUCTION.

B.M. 40-035
ELEV. 239.659m

NO.	REVISIONS	DATE	BY

Stantec Consulting Ltd.
905 Waverley Street, Winnipeg, Manitoba
Tel 204-489-5900 Fax 204-453-9012

DESIGNED BY K.T.C.	CHECKED BY J.K.H.
DRAWN BY W.B.G.	APPROVED BY H.A.K.
HOR. SCALE: 1:250	RELEASED FOR CONSTRUCTION: DATE
VERTICAL: 1:50	

ENGINEER'S SEAL
PROVINCE OF MANITOBA
REGISTERED PROFESSIONAL ENGINEER
H.A. KATZ
CONSULTANT DRAWING NO.
C-207

THE CITY OF WINNIPEG
Winnipeg WATER AND WASTE DEPARTMENT

2008 WATERMAIN RENEWALS, SEWER RENEWALS AND EXTERNAL POINT REPAIRS - CONTRACT 7
KNOX STREET
3RD MH S OF LAVINA AVE TO MH AT LAVINA AVE
STA. 1+50 TO STA. 2+50
200 & 250 WASTEWATER SEWER RENEWAL

SHEET 7	OF 26
CAD FILE DRAWING NUMBER 10340c-206-702.dwg	
CITY DRAWING NUMBER 08509	