

234
232
230
228
226
224
222
220

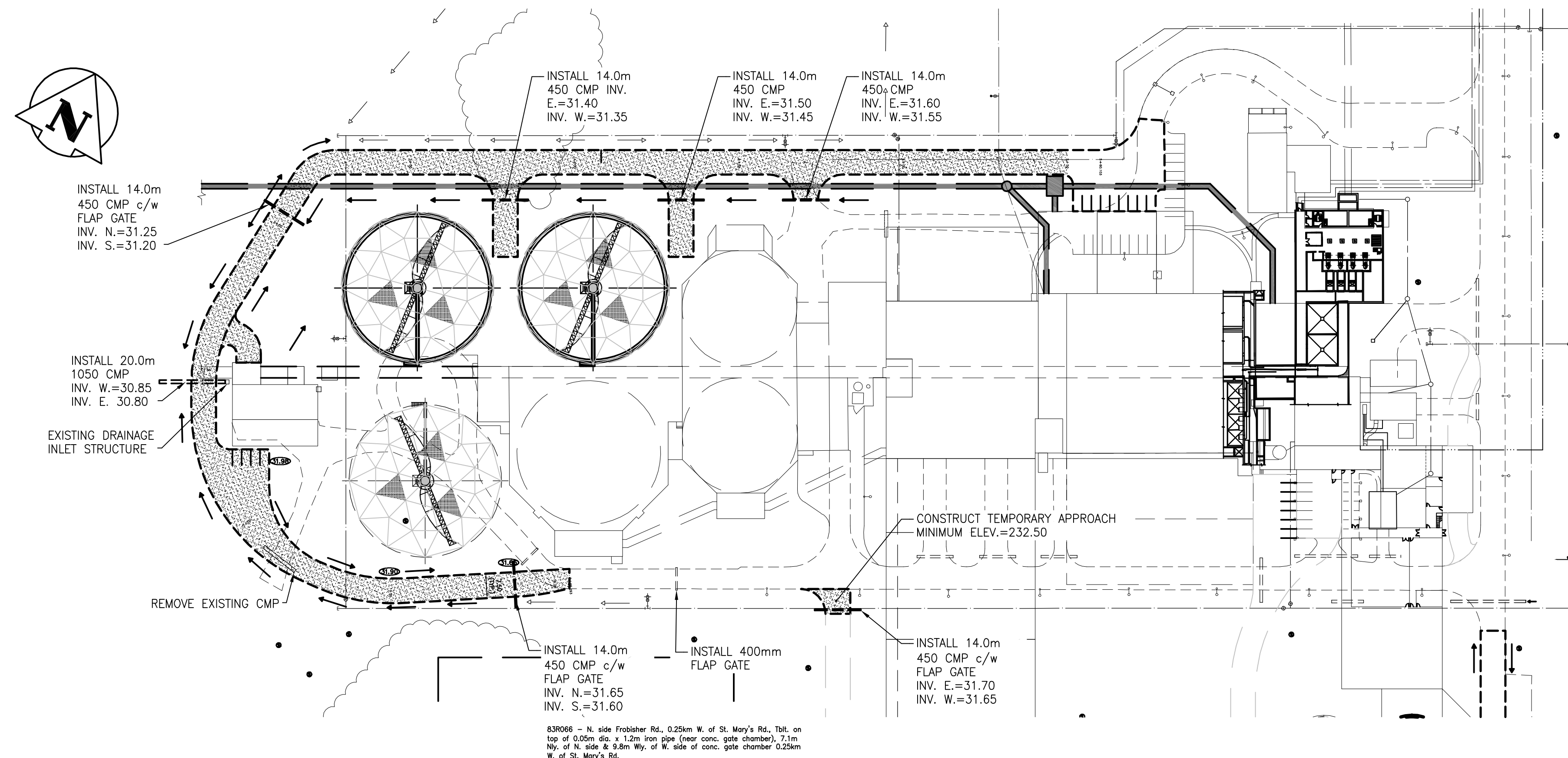
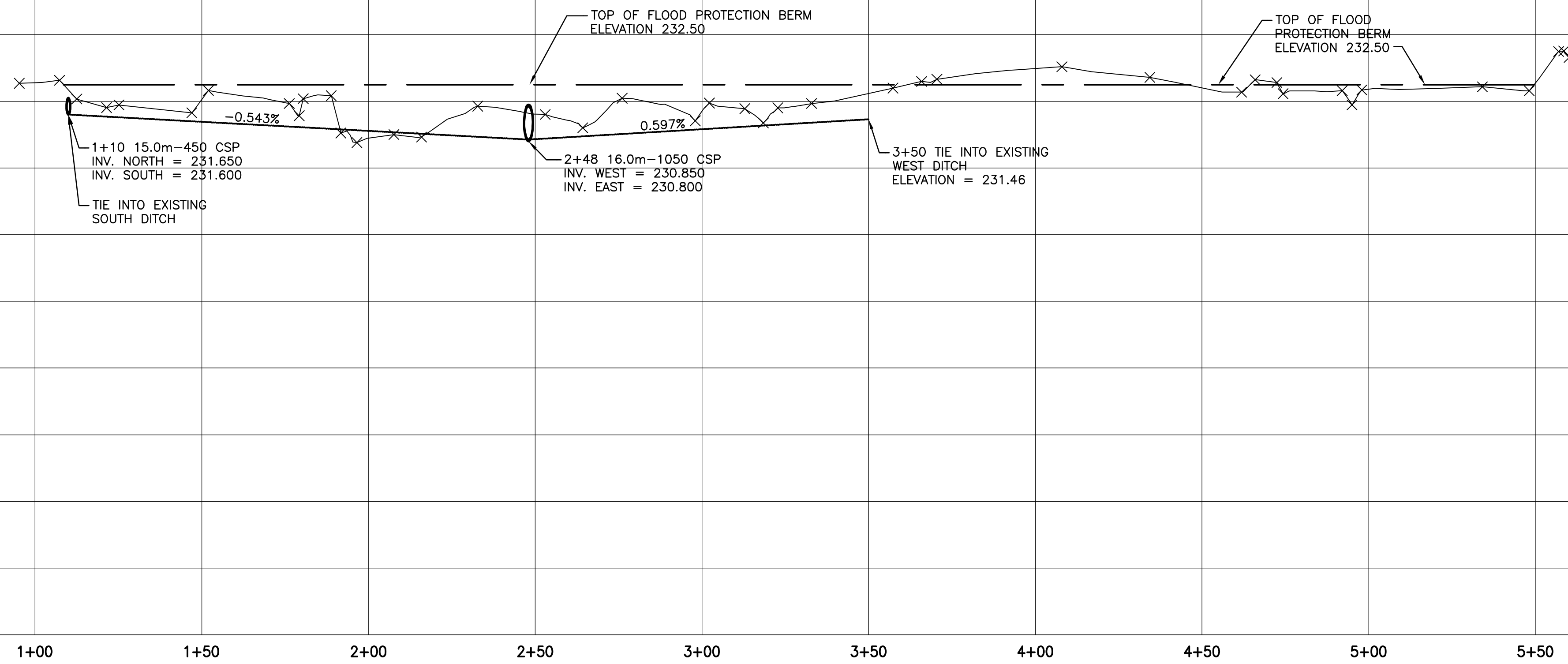

WARNING

IF POWER EQUIPMENT OR EXPLOSIVES ARE TO BE USED FOR EXCAVATION ON THIS PROJECT THE CONTRACTOR MUST:
1) NOTIFY THE GAS COMPANY OF THE PROPOSED LOCATION OF EXCAVATION.
2) TAKE PRECAUTION TO AVOID DAMAGE TO GAS COMPANY INSTALLATIONS.
SEE PROVINCIAL REGULATION 140/92 FOR DETAILS

METRIC

WHOLE NUMBERS INDICATE MILLIMETRES
DECIMALIZED NUMBERS INDICATE METRES

APEGM
Certificate of Authorization
Stantec Consulting Ltd.
No. 1301 Expiry: April 30, 2009

| | | | | | | | | | |
|---------|---------------------|---------|----------|---------------|----------|---------|----------------------|---------|----------|
| 150 WM | WATERMAIN | 150 WM | EXISTING | HYDRO | EXISTING | 150 WM | WATERMAIN | 150 WM | EXISTING |
| + | HYDRANT | + | --- | M.T.S. | --- | + | HYDRANT, VALVE | + | --- |
| ⊗ | VALVE | ⊗ | --- | CONCRETE | --- | + | LAND DRAINAGE SEWER | + | --- |
| 300 L2S | LAND DRAINAGE SEWER | 300 L2S | --- | ASPHALT | --- | 250 WWS | WASTE WATER SEWER | 250 WWS | --- |
| 250 WWS | WASTE WATER SEWER | 250 WWS | --- | SIDEWALK | --- | × | Q PROFILE | --- | --- |
| ○ | MANHOLE | ● | --- | PROPERTY LINE | --- | □ | NORTH OR WEST GUTTER | --- | --- |
| ▽ | CATCH BASIN | ■ | --- | SURVEY BAR | --- | ○ | SOUTH OR EAST GUTTER | --- | --- |
| ▽ | CURB INLET | ▽ | --- | DITCH | --- | ◇ | NORTH OR WEST R | --- | --- |
| + | JUNCTIONS | + | 31.334 | ELEVATION | 32.23 | ○ | SOUTH OR EAST R | --- | --- |
| --- | CULVERT | --- | --- | | --- | △ | NORTH OR WEST DITCH | --- | --- |
| --- | GAS | --- | --- | | --- | ▽ | SOUTH OR EAST DITCH | --- | --- |
| --- | EXISTING | --- | --- | --- | --- | --- | --- | --- | --- |
| --- | LEGEND-PLAN | --- | --- | --- | --- | --- | --- | --- | --- |
| --- | PROPOSED | --- | --- | --- | --- | --- | --- | --- | --- |
| --- | LEGEND-PROFILE | --- | --- | --- | --- | --- | --- | --- | --- |
| --- | PROPOSED | --- | --- | --- | --- | --- | --- | --- | --- |

LOCATION APPROVED UNDERGROUND STRUCTURES

SUPV. U/G STRUCTURES COMMITTEE DATE

NOTE:
LOCATION OF UNDERGROUND STRUCTURES AS SHOWN ARE BASED ON THE BEST INFORMATION AVAILABLE BUT NO GUARANTEE IS GIVEN THAT ALL EXISTING UTILITIES ARE SHOWN OR THAT THE GIVEN LOCATIONS ARE EXACT. CONFIRMATION OF EXISTENCE AND EXACT LOCATION OF ALL SERVICES MUST BE OBTAINED FROM THE INDIVIDUAL UTILITIES BEFORE PROCEEDING WITH CONSTRUCTION.

B.M. 81-007
ELEV. 230.438

| | | | |
|-----|-----------|------|----|
| NO. | REVISIONS | DATE | BY |
| | | | |

Stantec Consulting Ltd.
905 Waverley Street, Winnipeg, Manitoba
Tel 204-489-5900 Fax 204-453-9012

| | | | |
|-------------|--------|----------------------------|--------|
| DESIGNED BY | B.J.R. | CHECKED BY | H.A.K. |
| DRAWN BY | W.A. | APPROVED BY | B.J.R. |
| HOR. SCALE: | 1:1000 | RELEASED FOR CONSTRUCTION: | |
| VERTICAL: | 1:100 | DATE | |

ENGINEER'S SEAL
PROVINCE OF MANITOBA
B.J. RANSOM
MEMBER 22122
REGISTERED PROFESSIONAL ENGINEER

THE CITY OF WINNIPEG
WATER AND WASTE DEPARTMENT

Winnipeg

SOUTH END WATER POLLUTION CONTROL CENTRE
FLOOD PROTECTION BERM
SITE PLAN AND SECTIONS

BID OPPORTUNITY No. 489 - 2008
CITY DRAWING NUMBER I-0102A-D-C0001-003-00
SHEET 4 OF 6

U:\11208\1\1\Drawings\DWG\Sheet\1-0102A-D-C0001-003-000.dwg
2008-06-10 09:49:41 By: wmmiller