

NOTE: CHAINAGES SHOWN ARE ALONG W R OF KNOX ST.

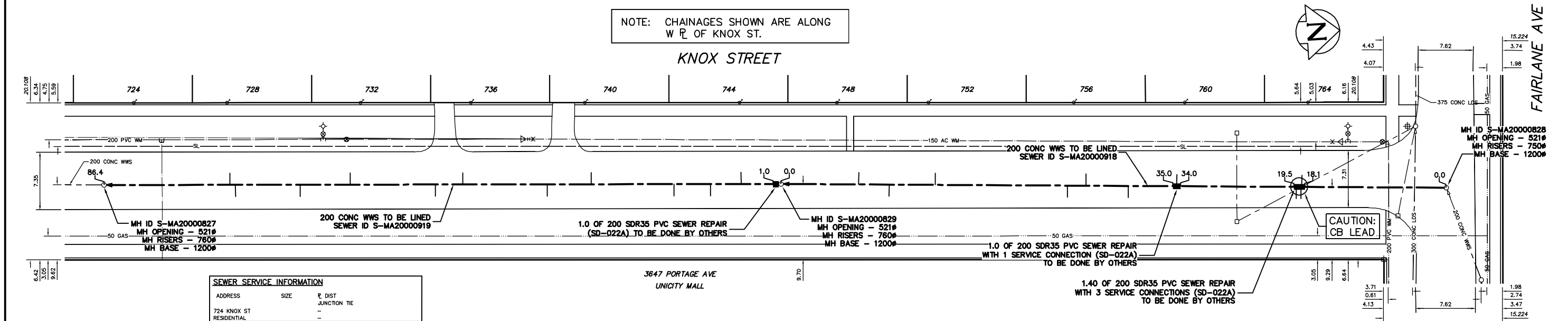

ADDRESS	SIZE	℄ DIST JUNCTION TIE
724 KNOX ST RESIDENTIAL	-	-
728 KNOX ST RESIDENTIAL	3.96 N OF SL	69.63 S 1ST S FAIRLANE AVE
732 KNOX ST RESIDENTIAL	7.06 N OF SL	53.38 S 1ST S FAIRLANE AVE
736 KNOX ST RESIDENTIAL	4.17 N OF SL	38.14 S 1ST S FAIRLANE AVE
740 KNOX ST RESIDENTIAL	-	-
744 KNOX ST RESIDENTIAL	8.08 N OF SL	3.67 S 1ST S FAIRLANE AVE
748 KNOX ST RESIDENTIAL	-	-
752 KNOX ST RESIDENTIAL	1.58 N OF SL	-
756 KNOX ST RESIDENTIAL	65.56 S MH AT FAIRLANE AVE	-
760 KNOX ST RESIDENTIAL	-	-
764 KNOX ST RESIDENTIAL	4.59 N OF SL	16.51 S MH AT FAIRLANE AVE

SEWER JUNCTION INFORMATION FROM SEWER VIDEO INSPECTION SEWER ID S-MA20000919			
DISTANCE FROM MH ID S-MH20000829			
5.1	S	100#	WEST CNI
9.0	S	100#	EAST JN
13.7	S	100#	EAST CNI
24.3	S	100#	WEST JN
29.9	S	100#	EAST CX
40.7	S	100#	WEST CN
44.2	S	100#	EAST CNI
55.1	S	100#	WEST JN
61.5	S	100#	EAST CNI
69.8	S	100#	EAST JN
70.5	S	100#	WEST JN

SEWER JUNCTION INFORMATION FROM SEWER VIDEO INSPECTION SEWER ID S-MA20000918			
DISTANCE FROM MH ID S-MH20000828			
18.5	S	100#	WEST JN
18.6	S	100#	EAST CX
19.2	S	100#	EAST JN
34.5	S	100#	WEST CX
40.7	S	150#	EAST CN
46.1	S	100#	WEST CXI
48.5	S	100#	EAST CNI
65.4	S	100#	WEST CX
71.3	S	100#	EAST CXI
75.2	S	100#	WEST CXI

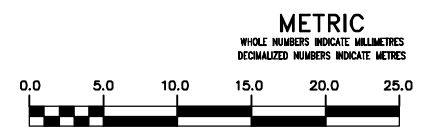

**WARNING**  
IF POWER EQUIPMENT OR EXPLOSIVES ARE TO BE USED FOR EXCAVATION ON THIS PROJECT THE CONTRACTOR MUST:  
1) NOTIFY THE GAS COMPANY OF THE PROPOSED LOCATION OF EXCAVATION.  
2) TAKE PRECAUTION TO AVOID DAMAGE TO GAS COMPANY INSTALLATIONS.  
SEE PROVINCIAL REGULATION 210/72 FOR DETAILS

200 WM	WATERMAIN	200 WM	SL, HYDRO	150 WM	WATERMAIN	150 WM
⊕	HYDRANT	⊕	MTS	+	HYDRANT	+
⊙	VALVE	⊙	TRAFFIC SIGNALS	⊙	VALVE	⊙
525 LDS	LAND DRAINAGE SEWER	525 LDS	GAS	50 GAS	300 LDS	LAND DRAINAGE SEWER
375 WWS	WASTEWATER SEWER	375 WWS	SURVEY BAR	250 WWS	250 WWS	WASTEWATER SEWER
○	MANHOLE	●	FENCE	⊕	⊕	PROFILE
□	CATCH BASIN	■	POLE - HYDRO, MTS	=====	=====	GROUND ABOVE PIPE
▽	CURB INLET	▽	CURB STOP	⊕	⊕	DITCH (NORTH & WEST)
⊕	JUNCTIONS	⊕	GUY ANCHOR	⊕	⊕	DITCH (SOUTH & EAST)
⊕	CULVERT	⊕	LIGHT STANDARD	⊕	⊕	GUTTER (NORTH & WEST)
⊕	ANODE	⊕	TREE	⊕	⊕	GUTTER (SOUTH & EAST)
EXISTING	LEGEND-PLAN	PROPOSED	EXISTING	LEGEND-PLAN	PROPOSED	EXISTING
EXISTING	LEGEND-PROFILE	PROPOSED	EXISTING	LEGEND-PROFILE	PROPOSED	EXISTING

LOCATION APPROVED UNDERGROUND STRUCTURES

SUPV. U/G STRUCTURES COMMITTEE DATE

NOTE: LOCATION OF UNDERGROUND STRUCTURES AS SHOWN ARE BASED ON THE BEST INFORMATION AVAILABLE BUT NO GUARANTEE IS GIVEN THAT THE GIVEN LOCATIONS ARE EXACT. CONFIRMATION OF EXISTENCE AND EXACT LOCATION OF ALL SERVICES MUST BE OBTAINED FROM THE INDIVIDUAL UTILITIES BEFORE PROCEEDING WITH CONSTRUCTION.

NO.	REVISIONS	DATE	BY

CITY OF WINNIPEG WATER AND WASTE ENGINEERING DIVISION

DESIGNED BY SC/DB CHECKED BY SC

DRAWN BY CJH APPROVED BY KZ

HOR. SCALE 1:250 VERTICAL 1:50

RELEASED FOR CONSTRUCTION

DATE 2008 07 08

ENGINEER'S SEAL

ORIGINAL SIGNED BY K.R. ZUREK 08/07/08

BID OPPORTUNITY: 499-2008  
FILENAME: 8605.dwg  
PLOT DATE: 2008 07 08

**THE CITY OF WINNIPEG**  
WATER AND WASTE DEPARTMENT

2008 SEWER RENEWALS BY CIPP LINING

**KNOX STREET**  
MH AT FAIRLANE AVENUE TO 2ND MH S OF FAIRLANE AVENUE

SHEET 7 OF 24  
CITY DRAWING NUMBER 8605