

ADDRESS	SIZE	Ø DIST	JUNCTION TIE
2193 PORTAGE AVE	RESIDENTIAL		
2194 PORTAGE AVE	RESIDENTIAL		
2199 PORTAGE AVE	RESIDENTIAL		
2208 PORTAGE AVE	RESIDENTIAL		
2214 PORTAGE AVE	RESIDENTIAL		
2235 PORTAGE AVE	RESIDENTIAL		
2238 PORTAGE AVE	RESIDENTIAL		
2245 PORTAGE AVE	RESIDENTIAL		

SEWER JUNCTION INFORMATION FROM SEWER VIDEO INSPECTION SEWER ID S-MA20005130			
DISTANCE FROM MH ID S-MH20004683			
2.3	W	150Ø	NORTH CNI
34.2	W	150Ø	SOUTH CNI
45.6	W	150Ø	NORTH JX
52.5	W	150Ø	NORTH JI
71.4	W	100Ø	NORTH CNI

NOTE: CHAINAGES SHOWN ARE ALONG N P OF PORTAGE AVE.

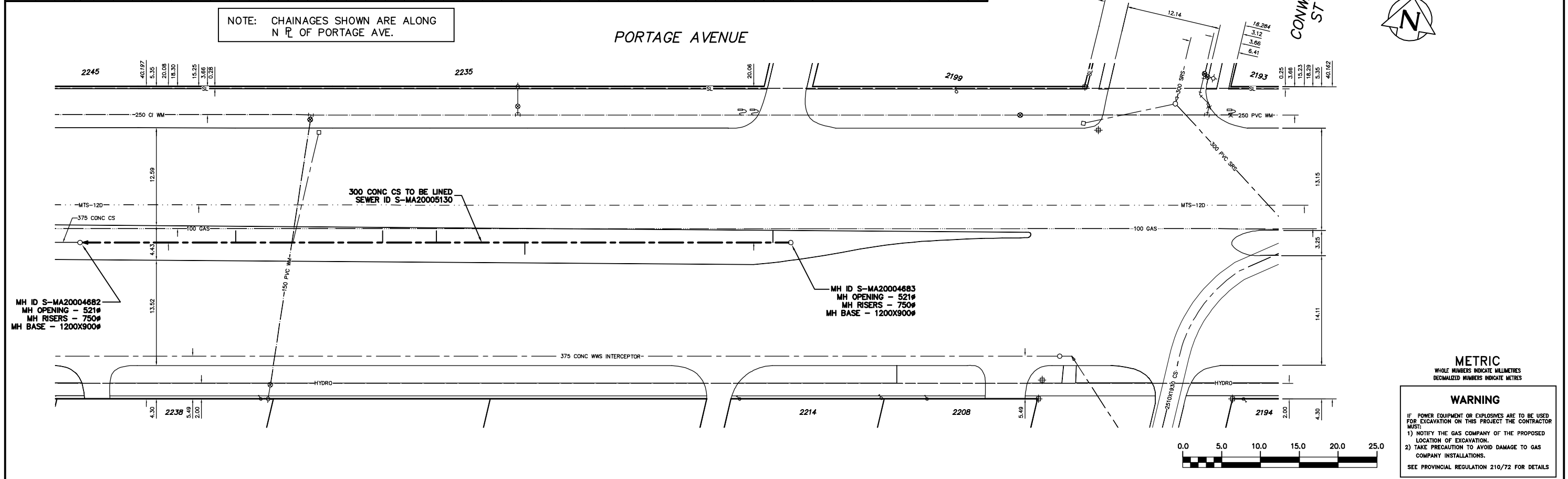

METRIC
WHOLE NUMBERS INDICATE MILLIMETRES
DECIMALIZED NUMBERS INDICATE METRES

WARNING
IF POWER EQUIPMENT OR EXPLOSIVES ARE TO BE USED FOR EXCAVATION ON THIS PROJECT THE CONTRACTOR MUST:
1) NOTIFY THE GAS COMPANY OF THE PROPOSED LOCATION OF EXCAVATION.
2) TAKE PRECAUTION TO AVOID DAMAGE TO GAS COMPANY INSTALLATIONS.
SEE PROVINCIAL REGULATION 210/72 FOR DETAILS

200 WM	WATERMAIN	200 WM	SL, HYDRO	150 WM	WATERMAIN	150 WM
⊕	HYDRANT	⊕	MTS	+	HYDRANT	+
⊙	VALVE	⊙	TRAFFIC SIGNALS	+	VALVE	+
525 LDS	LAND DRAINAGE SEWER	525 LDS	GAS	50 GAS	300 LDS	LAND DRAINAGE SEWER
375 WWS	WASTEWATER SEWER	375 WWS	SURVEY BAR	250 WWS	250 WWS	WASTEWATER SEWER
○	MANHOLE	●	FENCE	— X —	⊕	PROFILE
□	CATCH BASIN	■	POLE - HYDRO, MTS	=====	=====	GROUND ABOVE PIPE
▽	CURB INLET	▽	CURB STOP	⊕	⊕	DITCH (NORTH & WEST)
⊕	JUNCTIONS	⊕	GUY ANCHOR	⊕	⊕	DITCH (SOUTH & EAST)
—	CULVERT	—	LIGHT STANDARD	⊕	⊕	GUTTER (NORTH & WEST)
⊕	ANODE	⊕	TREE	⊕	⊕	GUTTER (SOUTH & EAST)
EXISTING	LEGEND-PLAN	PROPOSED	EXISTING	LEGEND-PLAN	PROPOSED	EXISTING
				LEGEND-PROFILE	PROPOSED	

LOCATION APPROVED	B.M. ELEV.	FIELD BOOK #:
UNDERGROUND STRUCTURES	POSTED TO LBIS	
SUPV. U/G STRUCTURES COMMITTEE	DATE	
NOTE:		
LOCATION OF UNDERGROUND STRUCTURES AS SHOWN ARE BASED ON THE BEST INFORMATION AVAILABLE BUT NO GUARANTEE IS GIVEN THAT ALL EXISTING UTILITIES ARE SHOWN OR THAT THE GIVEN LOCATIONS ARE EXACT. CONFIRMATION OF EXISTENCE AND EXACT LOCATION OF ALL SERVICES MUST BE OBTAINED FROM THE INDIVIDUAL UTILITIES BEFORE PROCEEDING WITH CONSTRUCTION.		
NO.	REVISIONS	DATE BY

CITY OF WINNIPEG
WATER AND WASTE
ENGINEERING DIVISION

DESIGNED BY: DB/SC
CHECKED BY: SC
DRAWN BY: C/JH
APPROVED BY: KZ
HOR. SCALE: 1:250
VERTICAL: 1:50
DATE: 2008 07 08

ENGINEER'S SEAL
ORIGINAL SIGNED BY K.R. ZUREK 08/07/08
BID OPPORTUNITY: 499-2008
FILENAME: 8613.dwg
PLOT DATE: 2008 07 08

THE CITY OF WINNIPEG
WATER AND WASTE DEPARTMENT

2008 SEWER RENEWALS
BY CIPP LINING
PORTAGE AVENUE
1ST MH W OF CONWAY STREET TO
2ND MH W OF CONWAY STREET

SHEET 15 OF 24
CITY DRAWING NUMBER
8613