

BANNATYNE AVENUE

KING STREET

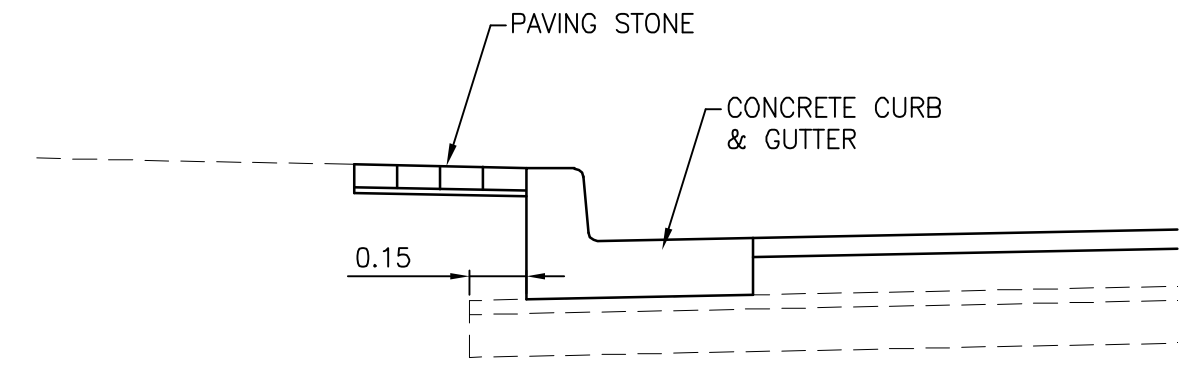
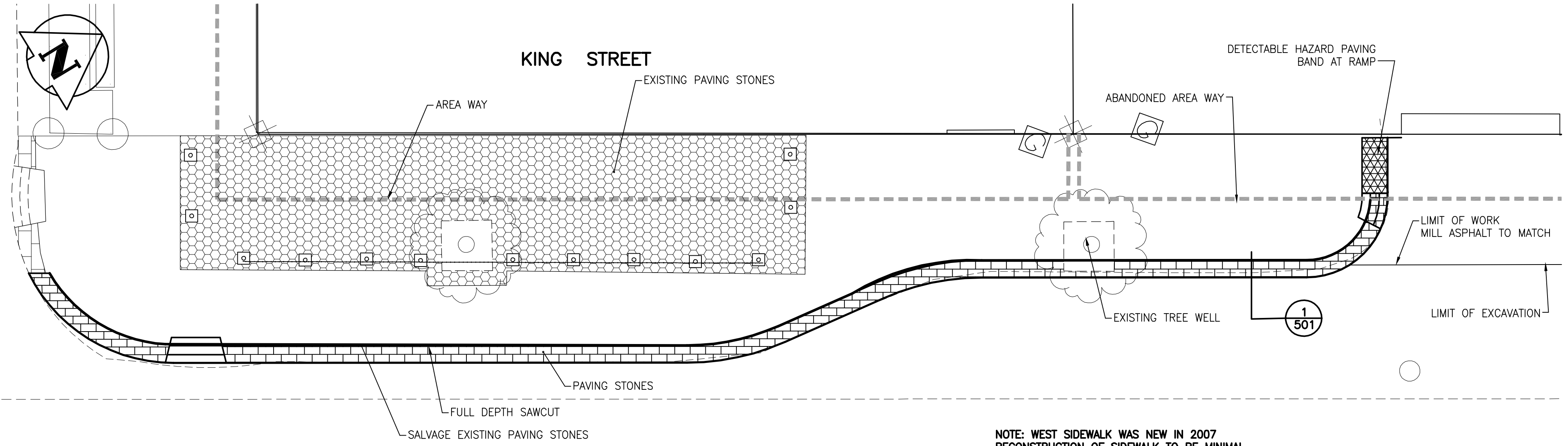

1 CURB DETAIL 1:20

NOTE: WEST SIDEWALK WAS NEW IN 2007 RECONSTRUCTION OF SIDEWALK TO BE MINIMAL

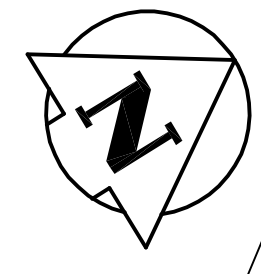

KING STREET

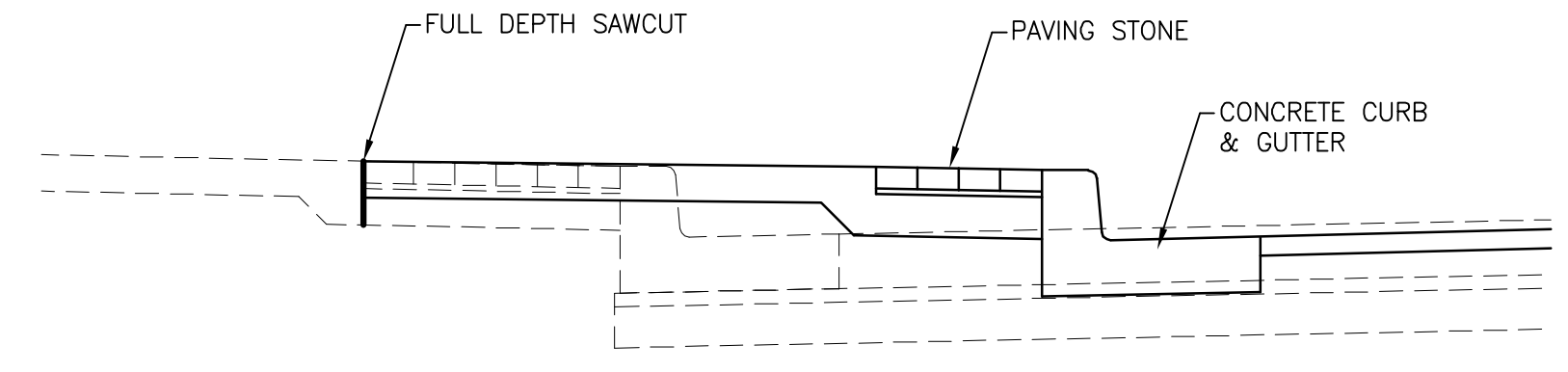
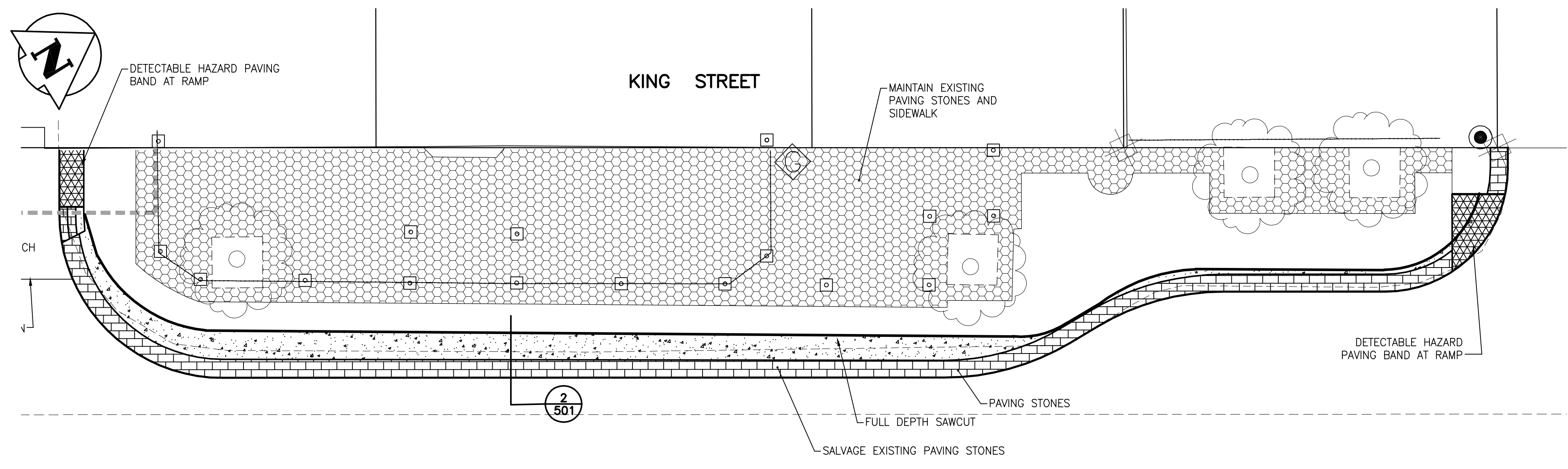

2 CURB DETAIL 1:20

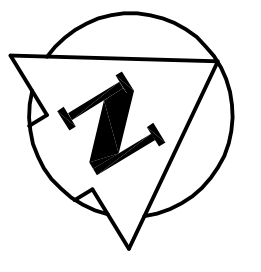

KING STREET

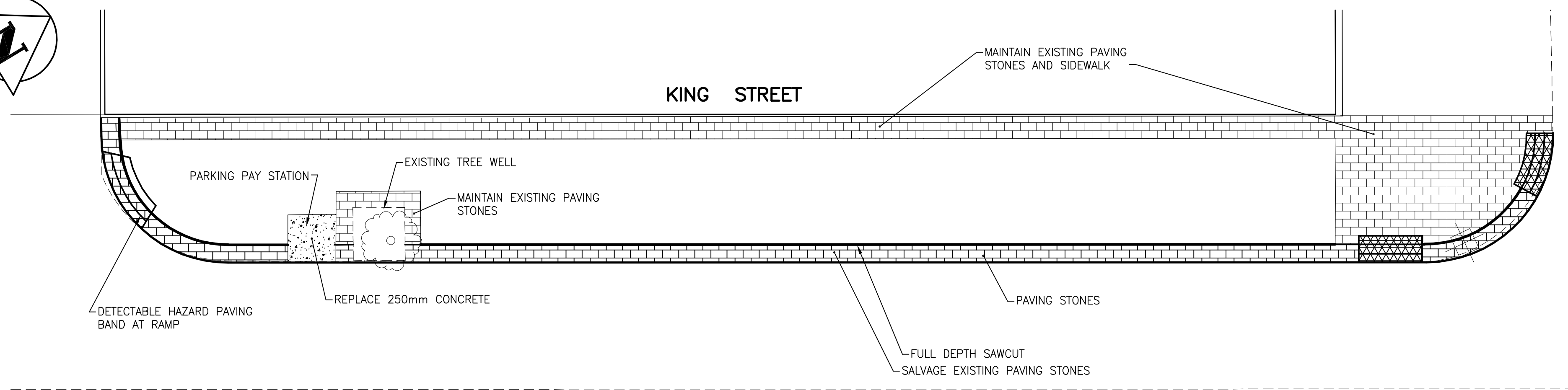

WILLIAM AVENUE

WARNING

IF POWER EQUIPMENT OR EXPLOSIVES ARE TO BE USED FOR EXCAVATION ON THIS PROJECT THE CONTRACTOR MUST:

- 1) NOTIFY THE GAS COMPANY OF THE PROPOSED LOCATION OF EXCAVATION.
- 2) TAKE PRECAUTION TO AVOID DAMAGE TO GAS COMPANY INSTALLATIONS.

SEE PROVINCIAL REGULATION 140/92 FOR DETAILS

METRIC

WHOLE NUMBERS INDICATE MILLIMETRES
DECIMALIZED NUMBERS INDICATE METRES

EXISTING	LEGEND-PLAN	PROPOSED	EXISTING	LEGEND-PLAN	PROPOSED	EXISTING	LEGEND-PROFILE	PROPOSED
150 WM	WATERMAIN	150 WM	HYDRANT	HYDRANT	HYDRANT	150 WM	WATERMAIN	150 WM
+	HYDRANT	+	+	HYDRANT	+	+	HYDRANT, VALVE	+
⊙	VALVE	⊙	⊙	VALVE	⊙	⊙	LAND DRAINAGE SEWER	⊙
300 LBS	LAND DRAINAGE SEWER	300 LBS	---	LAND DRAINAGE SEWER	---	300 LBS	LAND DRAINAGE SEWER	300 LBS
250 WWS	WASTE WATER SEWER	250 WWS	---	WASTE WATER SEWER	---	250 WWS	WASTE WATER SEWER	250 WWS
○	MANHOLE	●	---	MANHOLE	●	○	PROPERTY LINE	---
□	CATCH BASIN	⊕	---	CATCH BASIN	⊕	○	SURVEY BAR	---
▽	CURB INLET	▽	---	CURB INLET	▽	◇	DITCH	---
+	JUNCTIONS	+	31.334	JUNCTIONS	+	◇	ELEVATION	31.334
---	CULVERT	---	---	CULVERT	---	△	NORTH OR WEST DITCH	---
---	GAS	---	---	GAS	---	▽	SOUTH OR EAST DITCH	---

LOCATION APPROVED UNDERGROUND STRUCTURES

SUPV. U/G STRUCTURES COMMITTEE DATE

NOTE: LOCATION OF UNDERGROUND STRUCTURES AS SHOWN ARE BASED ON THE BEST INFORMATION AVAILABLE BUT NO GUARANTEE IS GIVEN THAT ALL EXISTING UTILITIES ARE SHOWN OR THAT THE GIVEN LOCATIONS ARE EXACT. CONFIRMATION OF EXISTENCE AND EXACT LOCATION OF ALL SERVICES MUST BE OBTAINED FROM THE INDIVIDUAL UTILITIES BEFORE PROCEEDING WITH CONSTRUCTION.

B.M. ELEV.	NO.	REVISIONS	DATE	BY
	0	ISSUED FOR TENDER	08.07.14	R.P.K.

Stantec Consulting Ltd.
905 Waverley Street, Winnipeg, Manitoba
Tel 204-489-5900 Fax 204-453-9012

DESIGNED BY: V.M.M.	CHECKED BY: V.M.M.
DRAWN BY: T.G.	APPROVED BY: R.P.K.
HOR. SCALE: 1:75	RELEASED FOR CONSTRUCTION: DATE
VERTICAL: DATE	DATE 08.06.10

ENGINEER'S SEAL

ORIGINAL SEALED BY
R.P. KURYLKO
P. ENG.
08/07/14

CONSULTANT DRAWING NO.
C-501

THE CITY OF WINNIPEG
PUBLIC WORKS DEPARTMENT
TRANSPORTATION ENGINEERING DIVISION

KING STREET-RECONSTRUCTION
OLD MARKET SQUARE - PHASE 1

KING STREET
WEST SIDE - LANDSCAPING

SHEET 3 OF 16
CAD FILE DRAWING NUMBER 04780c-501-696.dwg
CITY DRAWING NUMBER P-3295-03

V:\137\winnipeg\13704780\winnipeg\02_design\sheet\021696c-501-696.dwg 2008-07-14 11:21 AM By: spgl