

LEGEND	
	IN GRADE UPLIGHT FIXTURE TYPE "A"
	15A DUPLEX RECEPTACLE
	30A RECEPTACLE
	50A RECEPTACLE

- NOTES:**
- PROVIDE AND/OR RE-USE EXISTING CIRCUIT BREAKERS IN EXISTING 400A DISTRIBUTION PANEL TO FEED THE FOLLOWING ELECTRICAL EQUIPMENT ALONG KING STREET:
 - 7-15A, 1P BREAKERS FOR 15A RECEPTACLE BOXES
 - 1-15A, 1P BREAKER FOR SIX PLANTER UPLIGHT FIXTURES
 - 1-30A, 2P BREAKER FOR 30A RECEPTACLE BOX
 - 1-50A, 2P BREAKER FOR 50A RECEPTACLE BOX
 - PROVIDE AND/OR RE-USE EXISTING CIRCUIT BREAKERS IN RELOCATED POWER DISTRIBUTION PANEL 3 TO FEED THE FOLLOWING ELECTRICAL EQUIPMENT ALONG BANNATYNE AVENUE AND ALBERT STREET:
 - 12-15A, 1P BREAKERS FOR 15A RECEPTACLE BOXES
 - 1-15A, 1P BREAKER FOR FOUR PLANTER UPLIGHT FIXTURES
 - 1-15A, 1P BREAKER FOR TRENCH HEAT TRACE CABLE
 - 3-30A, 2P BREAKERS FOR 30A RECEPTACLE BOXES
 - 3-50A, 2P BREAKERS FOR 50A RECEPTACLE BOXES
 - RELOCATED STITTSVILLE LIGHT FIXTURES TO BE MOUNTED ON CONCRETE BASE AS SHOWN ON E-501.
 - NEW HEAT TRACE CABLE TO BE INSTALLED INSIDE ONE 25mm DIAMETER RIGID ALUMINUM CONDUIT LAYING IN BOTTOM OF PARKADE PREFABRICATED DRAINAGE TRENCH. INSTALL CABLE, TERMINATION KIT, HEAT SHRINK, END SEALS, ETC., AS PER MANUFACTURER'S INSTALLATION REQUIREMENTS. REFER TO CIVIL DRAWINGS FOR PREFABRICATED DRAINAGE TRENCH DETAILS.

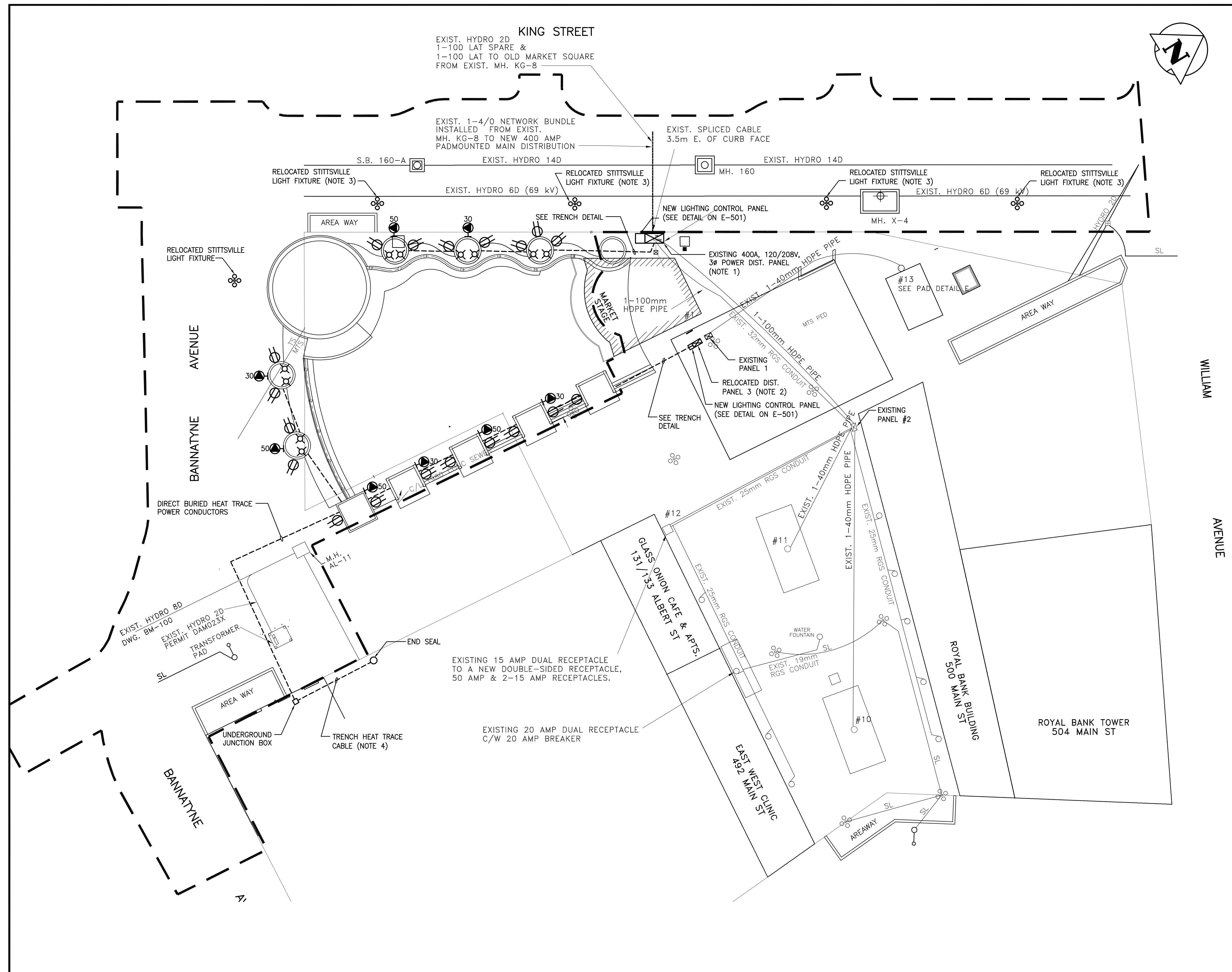

WARNING

IF POWER EQUIPMENT OR EXPLOSIVES ARE TO BE USED FOR EXCAVATION ON THIS PROJECT THE CONTRACTOR MUST:

- 1) NOTIFY THE GAS COMPANY OF THE PROPOSED LOCATION OF EXCAVATION.
- 2) TAKE PRECAUTION TO AVOID DAMAGE TO GAS COMPANY INSTALLATIONS.

SEE PROVINCIAL REGULATION 140/92 FOR DETAILS

METRIC

WHOLE NUMBERS INDICATE MILLIMETRES
DECIMALIZED NUMBERS INDICATE METRES

LOCATION APPROVED UNDERGROUND STRUCTURES		B.M. ELEV.
SUPV. U/G STRUCTURES COMMITTEE	DATE	
NOTE: LOCATION OF UNDERGROUND STRUCTURES AS SHOWN ARE BASED ON THE BEST INFORMATION AVAILABLE BUT NO GUARANTEE IS GIVEN THAT ALL EXISTING UTILITIES ARE SHOWN OR THAT THE GIVEN LOCATIONS ARE EXACT. CONFIRMATION OF EXISTENCE AND EXACT LOCATION OF ALL SERVICES MUST BE OBTAINED FROM THE INDIVIDUAL UTILITIES BEFORE PROCEEDING WITH CONSTRUCTION.		
0	ISSUED FOR TENDER	08.07.14 D.W.D.
NO. REVISIONS	DATE	BY

Stantec Consulting Ltd.	
905 Waverley Street, Winnipeg, Manitoba Tel 204-489-5900 Fax 204-453-9012	
DESIGNED BY D.G.	CHECKED BY D.W.D.
DRAWN BY D.G.	APPROVED BY D.W.D.
HOR. SCALE: 1:250	RELEASED FOR CONSTRUCTION:
VERTICAL:	DATE
08.06.10	

ENGINEER'S SEAL

ORIGINAL SEALED BY
D.W. DOWHAN
P. ENG.
08/07/14

CONSULTANT DRAWING NO.
E-102

THE CITY OF WINNIPEG
PUBLIC WORKS DEPARTMENT
TRANSPORTATION ENGINEERING DIVISION

Winnipeg

KING STREET-RECONSTRUCTION
OLD MARKET SQUARE - PHASE 1

OLD MARKET SQUARE
ELECTRICAL NEW WORKS

SHEET **15** OF **15**
CAD FILE DRAWING NUMBER **04780e-102-696.dwg**
CITY DRAWING NUMBER **P-3295-14**

V:\1137\04780e-102-696.dwg (04780e-102-696.dwg) 2008-07-14 11:30AM By: jgd