

EXCAVATE, REMOVE & STOCKPILE EXISTING LIMESTONE PATHWAY FULL DEPTH INCLUDING BASE COURSES. REUSE MATERIALS AND BASE COURSES WHERE POSSIBLE. SUPPLY AND INSTALL SOD AND TOPSOIL. GRADE TO DRAIN.

EXISTING DECIDUOUS TREES TO REMAIN
PROTECT DURING CONSTRUCTION
EXISTING BOLLARDS TO REMAIN

EXTEND LIMESTONE PATHWAY TO MEET EXISTING. ENSURE POSITIVE DRAINAGE IN ALL AREAS.

GENERAL NOTES

1. CONTRACTOR TO CONFIRM LOCATION OF ALL UTILITIES PRIOR TO CONSTRUCTION.
2. CONTRACTOR TO CONFIRM ALL DIMENSIONS AND REPORT ANY DISCREPANCIES TO CONTRACT ADMINISTRATOR PRIOR TO CONSTRUCTION.
3. LAYOUT TO BE APPROVED BY CONTRACT ADMINISTRATOR PRIOR TO ANY CONSTRUCTION OR REMOVALS.
4. ALL DIMENSIONS ARE IN METRIC UNLESS OTHERWISE NOTED. DECIMAL NUMBERS INDICATE METERS.
5. REFER ALSO TO WRITTEN SPECIFICATIONS.
6. ALL EXISTING TREES, SIDEWALKS, CURBS, SOD, AND PAVING TO REMAIN TO BE PROTECTED DURING CONSTRUCTION TO CITY OF WINNIPEG STANDARDS. AREAS DAMAGED DURING CONSTRUCTION TO BE REPAIRED TO CITY OF WINNIPEG STANDARDS AT CONTRACTOR'S OWN COSTS.
7. CONTRACTOR TO REPAIR ALL ON AND OFF SITE SODDED AREAS, TREES, CONCRETE, ROAD PAVING AND CURBS ETC., DAMAGED DURING CONSTRUCTION TO CONTRACT ADMINISTRATOR'S SATISFACTION AND TO THE CITY OF WINNIPEG STANDARDS AT HIS OWN COST.
8. CONSTRUCTION ACCESS TO BE LIMITED TO THE ROUTES SPECIFIED ON SITE BY CONTRACT ADMINISTRATOR
9. SUITABLE CLEAN EARTH FILL MATERIAL TO BE SALVAGED AND RE-USED AS INSTRUCTED BY CONTRACT ADMINISTRATOR. REFER ALSO TO WRITTEN SPECIFICATIONS.
10. CONTRACTOR IS RESPONSIBLE FOR ALL REMOVALS AS REQUIRED TO CONSTRUCT ALL WORKS AS SHOWN ON PLANS AND DETAILS. ALL ITEMS TO BE REMOVED MUST BE DISPOSED OF LEGALLY OFF SITE.

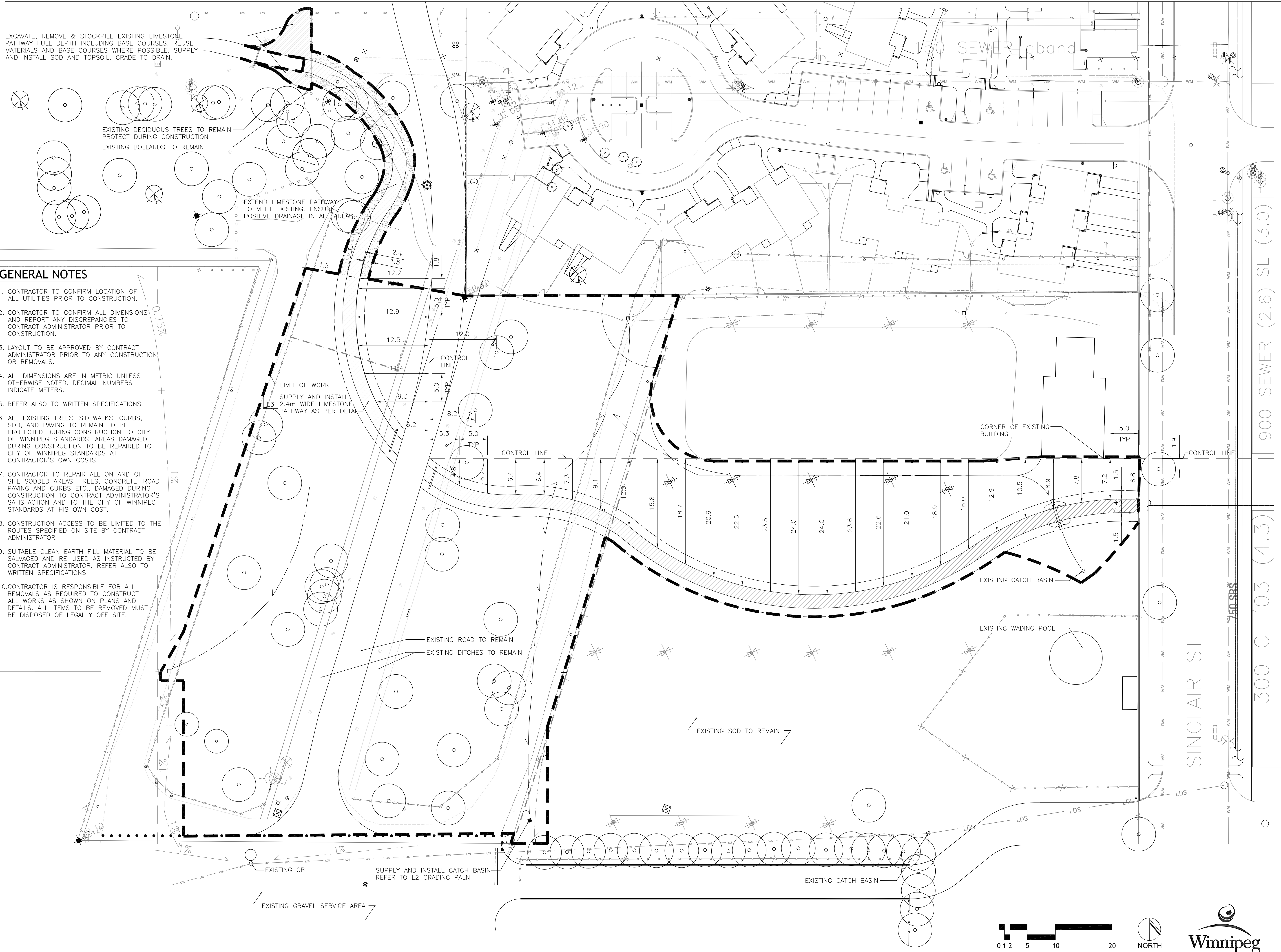

LEGEND

- LIMIT OF WORK
- EXISTING WATER MAIN
- EXISTING TELEPHONE LINE
- EXISTING LDS LINE
- PROPERTY LINE
- EXISTING FIRE HYDRANT
- EXISTING CHAIN LINK FENCE
- EXISTING CHAIN LINK FENCE TO BE REMOVED
- EXISTING CHAIN LINK FENCE TO BE REMOVED BY OTHERS
- NEW 1.2m CHAIN LINK FENCE
- EXISTING SPORTS LIGHT TO REMAIN
- NEW SWALE
- EXISTING SWALE
- NEW CATCH BASIN
- EXISTING CATCH BASIN
- EXISTING TREES TO REMAIN
- NEW LIMESTONE PATHWAY
- REPAIR SODDED AREAS
- EXISTING LIMESTONE PATHWAY TO BE REMOVED
- PROPOSED AREA OF NATURALIZATION
- SOD AND TOPSOIL
- DETAIL KEY
- 1 - DETAIL #
- LT - SHEET #

ISSUED FOR TENDER		31/07/08 TM	
No.	Revisions	Date	By
31-JUL-08			
Scale	1:300		
Designed By	Drawn By	Checked By	
SR	TM	SR	



OLD EX PARK- SGT. TOMMY PRINCE PARK PATHWAY CONNECTION

LAYOUT PLAN DIMENSIONS

Project No. 08-045 Drawing No. L1.2

