

NOTES:
 1. CONTRACTOR TO VERIFY LIMITS OF SEWER REPAIRS PRIOR TO EXCAVATION BY MEANS OF VIDEO INSPECTION.
 2. CONTRACTOR TO PROVIDE VIDEO INSPECTION OF SEWER SERVICES WITHIN LIMITS OF REPAIR IN PRESENCE OF CONTRACT ADMINISTRATOR TO DETERMINE IF SERVICE RENEWAL IS REQUIRED.
 3. ALL BACKFILL TO BE CLASS 5 BACKFILL UNDER BOULEVARDS AND CLASS 3 UNDER OR WITHIN 1.0m OF PAVEMENTS AND SIDEWALKS.

WATER SERVICE INFORMATION				
ADDRESS	SIZE/TYPE	S.C. SHORT AND LONG MEASUREMENT	CORP LOCATION	REMARKS
53 GROVE STREET RESIDENTIAL	19mm COPPER	0.2m EWL HOUSE 3.94m SSL OF ROVER	3 N OF S.C.	

SEWER SERVICE INFORMATION		
ADDRESS	SIZE	R DIST JUNCTION TIE
49 GROVE RESIDENTIAL		1.54 W of EL 36.27 W MH00012378
46 GROVE RESIDENTIAL		1.38 W of EL 35.66 W MH00012378

SEWER JUNCTION INFORMATION FROM VIDEO INSPECTION S-MA00013880	
DISTANCE FROM S-MH00012379	
61.9m EAST - 150mm CONNECTION NORTH -	
62.5m EAST - 150mm CONNECTION SOUTH -	

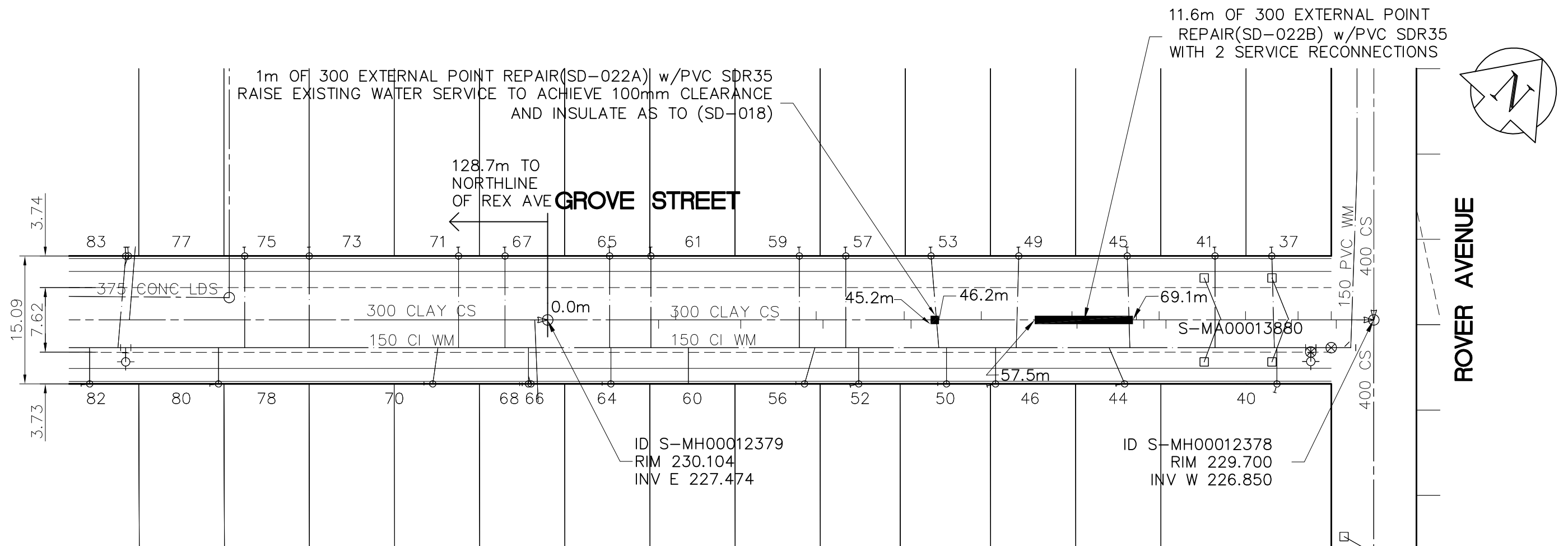

LEGEND

52.0 MEASUREMENT TO REPAIR FROM REFERENCE MH SHOWN THUS... 0.0

METRIC
 WHOLE NUMBERS INDICATE MILLIMETRES
 DECIMALIZED NUMBERS INDICATE METRES

APEGM
 Certificate of Authorization
 Earth Tech Canada Inc.
 No. 730

B.M. N.W. COR. Sutherland Ave. & Gomez St., Brass plug ELEV. in Conc. pile (to hardpan), on N.L. of Sutherland Ave., & 7.4 m W. of C.L. Pav't. of Gomez St.				ENGINEER'S SEAL 			
DESIGNED BY	PL	CHECKED BY	PL	2008 SEWER RENEWALS		SHEET OF 6 16	
DRAWN BY	JP	APPROVED BY	KWF	GROVE STREET BETWEEN REX AVENUE AND ROVER AVENUE		CITY DRAWING NUMBER 8657	
0 ISSUED FOR TENDER 2008/06/01 PL A ISSUED FOR REVIEW 2008/07/16 PL	HOR. SCALE: 1:500 VERTICAL:	RELEASED FOR CONSTRUCTION BY: K. ZUREK		CONSULTANT DRAWING NO. 104450-05			
NO. REVISIONS	DATE	BY	DATE	2008/03/31 2008/08/07			