

CHAINAGE ALONG WEST PROPERTY LINE OF CORMORANT BAY

CORMORANT BAY

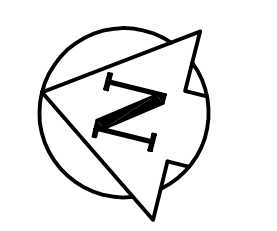

**APEGM**  
 Certificate of Authorization  
 GENIVAR Consultants  
 No. 4318 Expiry: April 30, 2009

ADDRESS & NATURE OF SERVICE	SIZE (mm) & TYPE	SHORT & LONG MEASUREMENT	REMARKS
6 Cormorant Bay Residential	19 Copper	6.9 RL COR	DRWY A3590 SEWER/08
7 Cormorant Bay Residential	19 Copper	6 LR COR	DRWY A3741 SEWER/09
10 Cormorant Bay Residential	19 Copper	8.2 RL CR OF HSE	DRWY A3566 SEWER/06
11 Cormorant Bay Residential	19 Copper	2.7 RL CR OF HSE	DRWY A3199 SEWER/06
14 Cormorant Bay Residential	19 Copper	5.2 RL CR OF HSE	DRWY A3128 SEWER/06
15 Cormorant Bay Residential	19 Copper	3.7 LR COR HSE	DRWY A3655 SEWER/06
18 Cormorant Bay Residential	19 Copper	5.4 RL COR HSE	DRWY A3562 SEWER/06
21 Cormorant Bay Residential	19 Copper	3.7 RL COR HSE	DRWY A3559 SEWER/06
22 Cormorant Bay Residential	19 Copper	8.5 RL COR HSE	DRWY A3549 SEWER/06
25 Cormorant Bay Residential	19 Copper	13 FROM L COR HSE	DRWY A3335 SEWER/06
26 Cormorant Bay Residential	19 Copper	4.8 RL COR GARAGE	DRWY A3542 SEWER/06
63 Edgewater Drive Residential	19 Copper	10.1 E/WHL	SEWER/72 TAXI 18-6-6 2900-06
64 Edgewater Drive Residential	19 Copper	2.0 FROM GARAGE	DRWY A3922 SEWER/71
89 Edgewater Drive Residential	19 Copper	9.7 LR COR	SWIMMING POOL PERMIT 23513-1982 E 1659
72 Edgewater Drive Residential	19 Copper	7.4 LR COR	DRWY G4849 A5433 SEWER/72

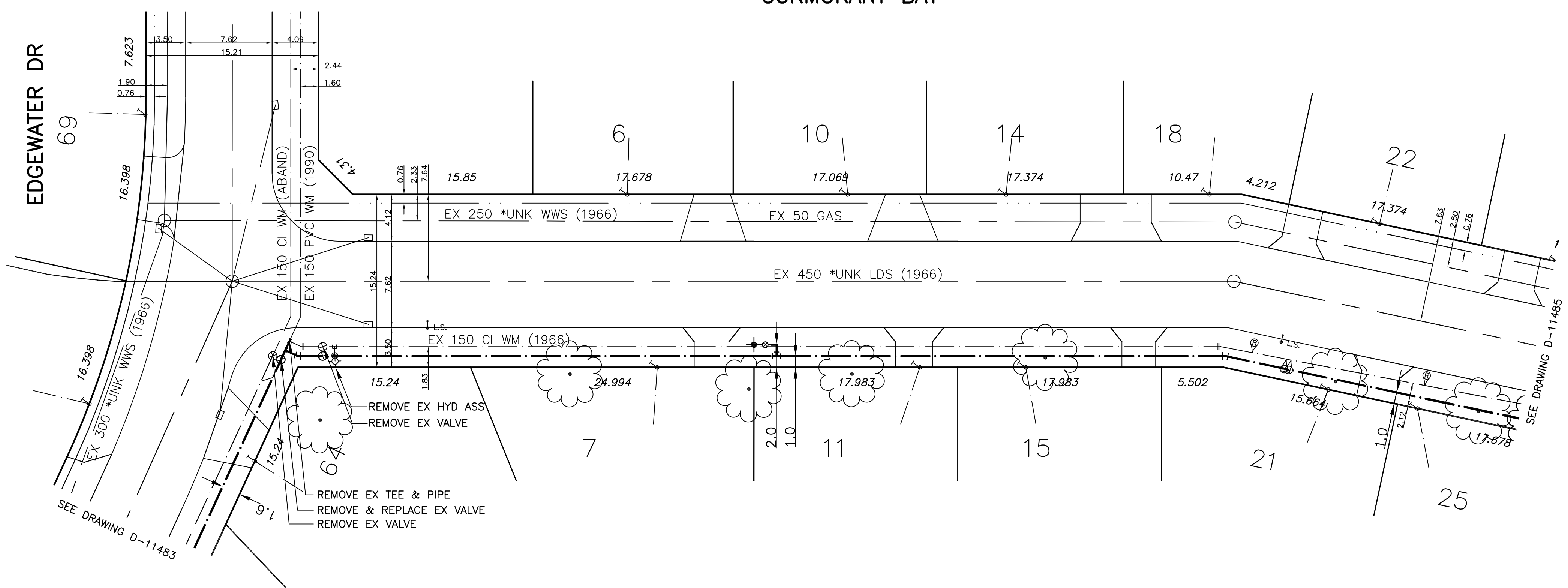

- NOTES:**
1. ALL GATE VALVES ARE COUNTER-CLOCKWISE TO OPEN WITH A BLACK OPERATING NUT.
  2. WATERMAIN TO BE INSTALLED BY TRENCHLESS METHODS.
  3. BACKFILL IS CLASS 5 WITHIN BOULEVARD AND CLASS 3 WHEN WITHIN PAVEMENT/SIDEWALK OR WHEN WITHIN 1.0m OF PAVEMENT OR SIDEWALK.
  4. WATER SERVICES ARE 19mm UNLESS OTHERWISE NOTED.
  5. MINIMUM COVER TO TOP OF WATERMAIN SHALL BE 2.4m.
  6. LOCATION OF ALL SERVICES TO BE CONFIRMED IN FIELD.
  7. EXPOSE EXISTING WATERMAIN TO CONFIRM DEPTH PRIOR TO CONSTRUCTION.
  8. ALL LEAD SERVICES TO BE RENEWED TO PROPERTY LINE.
  9. SERVICES TO BE RENEWED SHALL BE REPLACED FROM WATERMAIN TO PROPERTY LINE. ALL OTHERS TO BE RECONNECTED.

METRIC  
 WHOLE NUMBERS INDICATE MILLIMETRES  
 DECIMALIZED NUMBERS INDICATE METRES

EXISTING	LEGEND - PLAN	PROPOSED	EXISTING	LEGEND - PLAN	PROPOSED	EXISTING	LEGEND - PROFILE	PROPOSED
---	WATERMAIN	---	---	REDUCER	---	---	WATERMAIN	---
+	HYDRANT VALVE	+	+	PLUG	+	+	VALVE	+
---	LAND DRAINAGE SEWER	---	---	TRAFFIC SIGNAL	---	---	LAND DRAINAGE SEWER	---
---	WASTE WATER SEWER	---	---	GAS	---	---	WASTE WATER SEWER	---
○	MANHOLE	○	---	HYDRO	---	---	JUNCTIONS	---
□	CATCH BASIN	□	---	M.T.S.	---	---	CULVERT	---
△	CURB INLET	△	---	SURVEY BAR	---	---		---
+	TEE	+	---	CURB STOP	---	---		---
+	BEND	+	---	C.B. LEAD	---	---		---
+	ANODE	+	---	TREE	---	---		---
---		---	---	LAMP STANDARD	---	---		---

LOCATION APPROVED

SUPV. U/G STRUCTURES DATE COMMITTEE

NOTE:  
 LOCATION OF UNDERGROUND STRUCTURES AS SHOWN ARE BASED ON THE BEST INFORMATION AVAILABLE BUT NO GUARANTEE IS GIVEN THAT ALL EXISTING UTILITIES ARE SHOWN OR THAT THE GIVEN LOCATIONS ARE EXACT. CONFIRMATION OF EXISTENCE AND EXACT LOCATION OF ALL SERVICES MUST BE OBTAINED FROM THE INDIVIDUAL UTILITIES BEFORE PROCEEDING WITH CONSTRUCTION.

B.M. 55-046  
 ELEV. 231.386

**GENIVAR**  
 200 TACHE AVENUE WINNIPEG, MANITOBA R2H 1A7  
 PH: (204)-233-2113 FAX: (204)-233-2080

DESIGNED BY: DJ  
 CHECKED BY: SM  
 DRAWN BY: MBS  
 APPROVED BY: IMcK

HOR. SCALE: 1:250  
 VERT. SCALE: 1:50

RELEASED FOR CONSTRUCTION  
 SIGNED BY: S. COURNOYER P.ENG.  
 DATE: AUGUST 20 2008

ENGINEERS  
 PROVINCE OF MANITOBA  
**I. G. MCKINNON**  
 REGISTERED PROFESSIONAL ENGINEER

CONSULTANT DRAWING NO.  
 069-024-05

THE CITY OF WINNIPEG  
 WATER AND WASTE DEPARTMENT

2008 CAPITAL WORKS  
 WATERMAIN RENEWALS  
**CORMORANT BAY (WEST LEG)**  
 EDGEWATER DRIVE TO  
 110m SOUTH OF EDGEWATER DRIVE

SHEET 3 OF 5  
 CITY DRAWING NO.  
**D-11484**