

**1 FLOOR PLAN (EL. 232.28m)**  
SCALE: 1:50

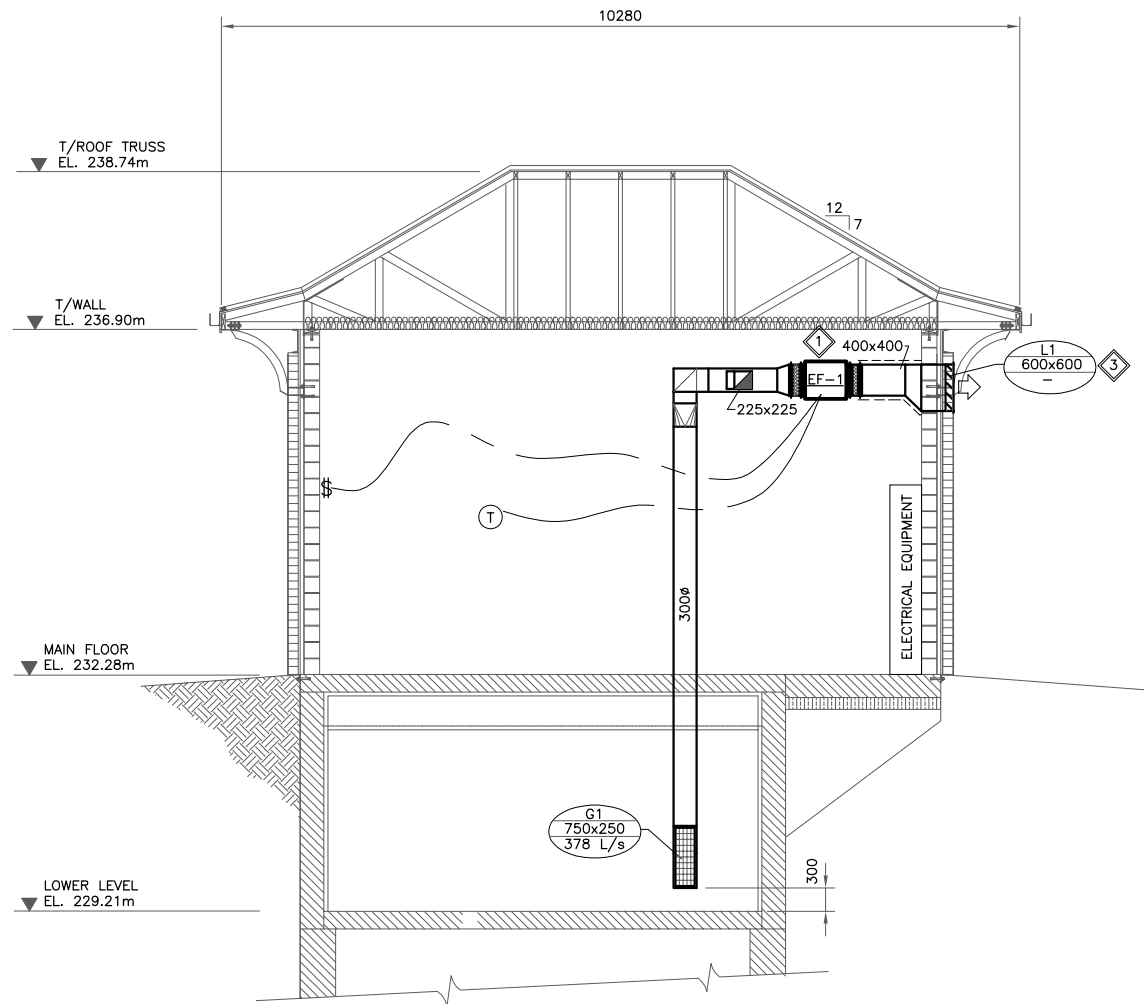

**A STATION SECTION**  
SCALE: 1:50

**GENERAL NOTES:**

- PERFORM WORK IN ACCORDANCE WITH ALL APPLICABLE CODES AND REGULATIONS.
- REVIEW EQUIPMENT LOCATIONS WITH CONTRACT ADMINISTRATOR PRIOR TO INSTALLATION.
- DUCT ROUTING INDICATED ON DRAWINGS ARE APPROXIMATE ONLY, CONFIRM IN FIELD. REROUTE DUCTING TO ELIMINATE FIELD INTERFERENCES WITH BUILDING STRUCTURES, ELECTRICAL ETC. CONFIRM CHANGES WITH CONTRACT ADMINISTRATOR.
- CONFORM TO SMACNA STANDARDS FOR SUPPLY AND INSTALLATION OF DUCTWORK.

**DEMOLITION NOTES:**

- REMOVE ALL EXISTING HEATING AND VENTILATION EQUIPMENT, INCLUDING FANS, DUCTWORK, AND CONTROLS, AND DISPOSE OF OFF SITE. OBTAIN EQUIPMENT LOCATIONS, DUCT ROUTING ETC. IN FIELD.

**KEY NOTES:**

- INSTALL NEW EXHAUST FAN EF-1 AND EF-2 AS INDICATED. PROVIDE SPRING VIBRATION ISOLATORS AND FLEXIBLE DUCT CONNECTIONS.
- INSTALL NEW UNIT HEATERS EUH-1 AND EUH-2 AS SHOWN. PROVIDE MOUNTING BRACKETS AND CONTROL WIRING (TYP).
- PROVIDE AIR INTAKE AND EXHAUST LOUVERES AS SHOWN (TYP).
- PROVIDE A 25mm THICK INSULATED GALVANIZED STEEL COVERED SLIDING CLOSURE PANEL WITH GASKETTING ON FACE TO SEAL PANEL AGAINST LOUVER FRAME. PROVIDE SLIDING SYSTEM TO SUIT. PROVIDE HANDLES FOR OPENING OF AND CLOSING PANEL. PROVIDE PANEL AND SLIDING SYSTEM SHOP DRAWING FOR REVIEW BEFORE FABRICATION.

**VENTILATION SYSTEM SEQUENCE OF OPERATION:**

- THE EXHAUST FAN EF-1 SHALL BE CONTROLLED BY A MANUAL ON/OFF SWITCH, AND A SPACE MOUNTED COOLING THERMOSTAT, AS FOLLOWS:
- EXHAUST FAN EF-1 SHALL OPERATE WHEN MANUAL OVERRIDE SWITCH IS ON.
  - WHEN MANUAL OVERRIDE SWITCH IS OFF, OPERATION OF EF-1 SHALL REFER TO AUTO MODE.
  - WHEN IN AUTO MODE EXHAUST FAN EF-1 SHALL OPERATE WHENEVER SPACE TEMPERATURE RISES ABOVE SET POINT.
  - REFER TO ELECTRICAL FOR CONTROLS DESIGN.

**LEGEND:**

- NEW EQUIPMENT OR DUCTWORK
- EXTERNALLY INSULATED DUCTWORK
- THERMOSTAT
- BACKDRAFT DAMPER C/W ACCESS DOOR
- G1 750x250 378 L/s GRILLE NO., NECK SIZE, AIR FLOW
- L1 600x600 LOUVRE NO., SIZE
- EF- EXHAUST FAN
- EUH- ELECTRIC UNIT HEATER
- \$ MANUAL SWITCH
- CONTROL WIRING

GRILLE SCHEDULE			
GRILLE No.	E.H. PRICE	DESIGNATION	COMMENTS
G1	750x250/510/F/L/A/B12		LOUVERED RETURN GRILLE

LOUVRE SCHEDULE		
LOUVRE No.	SIZE (WxH)	ACCEPTABLE MATERIAL
L1	600x600 (24"x24")	E.H.PRICE/DE439
L2	400x300 (16"x12")	E.H.PRICE/DE439

EXHAUST FAN SCHEDULE									
TAG No.	CAPACITY	E.S.P.	FRPM	VOLTAGE	MOTOR			ACCESSORIES	MAKE/MODEL
					HP	ENCL	RPM		
EF-1	378 L/s	62.5 Pa	1550	120/1/60	1/8	TEAO	1550	SPRING HANGING ISOLATORS AND BRACKETS	"GREENHECK"/SQ-120-4
EF-2	50 L/s	62.5 Pa	1550	120/1/60	1/40	TEAO	1550	SPRING HANGING ISOLATORS AND BRACKETS	"GREENHECK"/SQ-60-D

ELECTRIC UNIT HEATER SCHEDULE					
TAG No.	CAPACITY	VOLTAGE	CONTROLS	ACCESSORIES	MAKE/MODEL
EUH-1	7.5 kW	600/3/60	REMOTE SPACE THERMOSTAT	MOUNTING BRACKET AND SPACE THERMOSTAT	"CALORITECH"/GE078C
EUH-2	7.5 kW	600/3/60	REMOTE SPACE THERMOSTAT	MOUNTING BRACKET AND SPACE THERMOSTAT	"CALORITECH"/GE078C

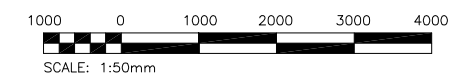

**METRIC**  
WHOLE NUMBERS INDICATE MILLIMETRES  
DECIMALIZED NUMBERS INDICATE METRES

B.M. XX-XXX ELEV. XXX.XXX  DESIGNED BY PSS DRAWN BY VJH  0 ISSUED FOR CONSTRUCTION 08/09/23 PSS NO. REVISIONS DATE BY	<b>KGS GROUP</b> <b>CONSULTING ENGINEERS &amp; PROJECT MANAGERS</b> WINNIPEG (204) 896-1209 THUNDER BAY (807) 345-2233	ENGINEER'S SEAL	<b>THE CITY OF WINNIPEG</b> WATER & WASTE DEPARTMENT  <b>RAVELSTON LAND DRAINAGE PUMPING STATION UPGRADE</b>  <b>MECHANICAL HEATING AND VENTILATION</b>	SHEET 01 OF 02
		THE ORIGINAL ISSUE REV. 0 WAS STAMPED, DATED AND SIGNED BY P.S. SILVA ON 23/09/08 D/M/Y		CAD FILE DRAWING NUMBER 08-0107-03-M001
		CHECKED BY RED APPROVED BY RELEASED FOR CONSTRUCTION:		CITY DRAWING NUMBER LD-5087
		SCALE: AS NOTED DATE 2008/07/18		CONSULTANT DRAWING NO. 08-0107-03-M1

P:\PROJECTS\2008\08-0107-03\MECH\DWGS\08-0107-03-M001.dwg