

LEGEND

- 232.00 NEW ELEVATION
- 233.20 TOW TOP OF WALL ELEVATION
- 233.20 TOP TOP OF PLINTH ELEVATION
- 232.96 EXISTING ELEVATION
- RIDGELINE
- 1% DIRECTIONAL SLOPE

GRADING NOTES

1. ALL EXISTING GRADES ARE BASED ON SURVEY INFORMATION PROVIDED BY SHEPHERD AND STEVENS. A COPY OF THE SITE SURVEY IS BOUND INTO THIS DRAWING PACKAGE. CONFIRM EXISTING GRADES ARE CORRECT AND REPORT ANY DISCREPANCIES TO THE CONTRACT ADMINISTRATOR PRIOR TO PROCEEDING WITH SITE WORK.
2. CONFIRM THE LOCATION OF ALL UNDERGROUND UTILITIES AND STRUCTURES PRIOR TO PROCEEDING WITH ANY EXCAVATION AND TRENCHING.
3. ALL ELEVATIONS ARE IN METRES UNLESS OTHERWISE SPECIFIED. SITE GRADES ARE DEPICTED IN GEODETIC FORM. EG 232.24M ASL
4. STAKE OUT ALL SURFACE AND SUBSURFACE DRAIN LOCATIONS AND ELEVATIONS AND OBTAIN APPROVAL OF CONTRACT ADMINISTRATOR PRIOR TO PROCEEDING WITH SITE GRADING.
5. CONFIRM FINISHED GRADES WITH CONTRACT ADMINISTRATOR PRIOR TO INSTALLATION. REPORT ANY DISCREPANCIES TO CONTRACT ADMINISTRATOR IMMEDIATELY.
6. REFER TO MECHANICAL AND ELECTRICAL DRAWINGS FOR SERVICE CONNECTIONS TO EXISTING UTILITIES.
8. ALL NEW PAVED AREAS TO MEET EXISTING GRADES FLUSH AND TRUE.
9. MODIFY ALL CATCHBASINS, MANHOLES, INLETS, VALVES AND ANY OTHER EXISTING CWPG SERVICES TO PROPOSED GRADES WHEREVER THEY ARE AFFECTED BY GRADING CHANGES.

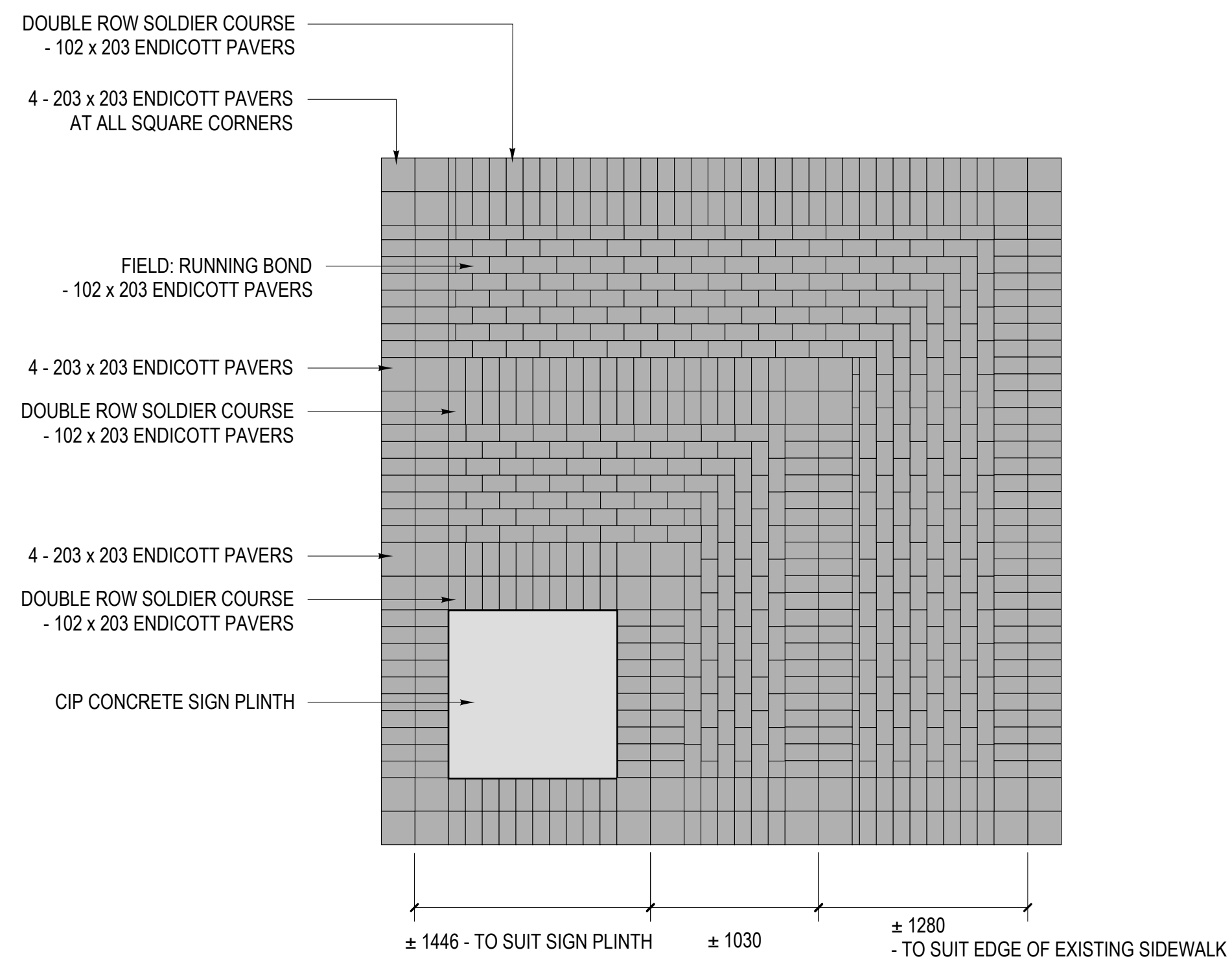

1 PAVING PATTERN
SCALE 1:30

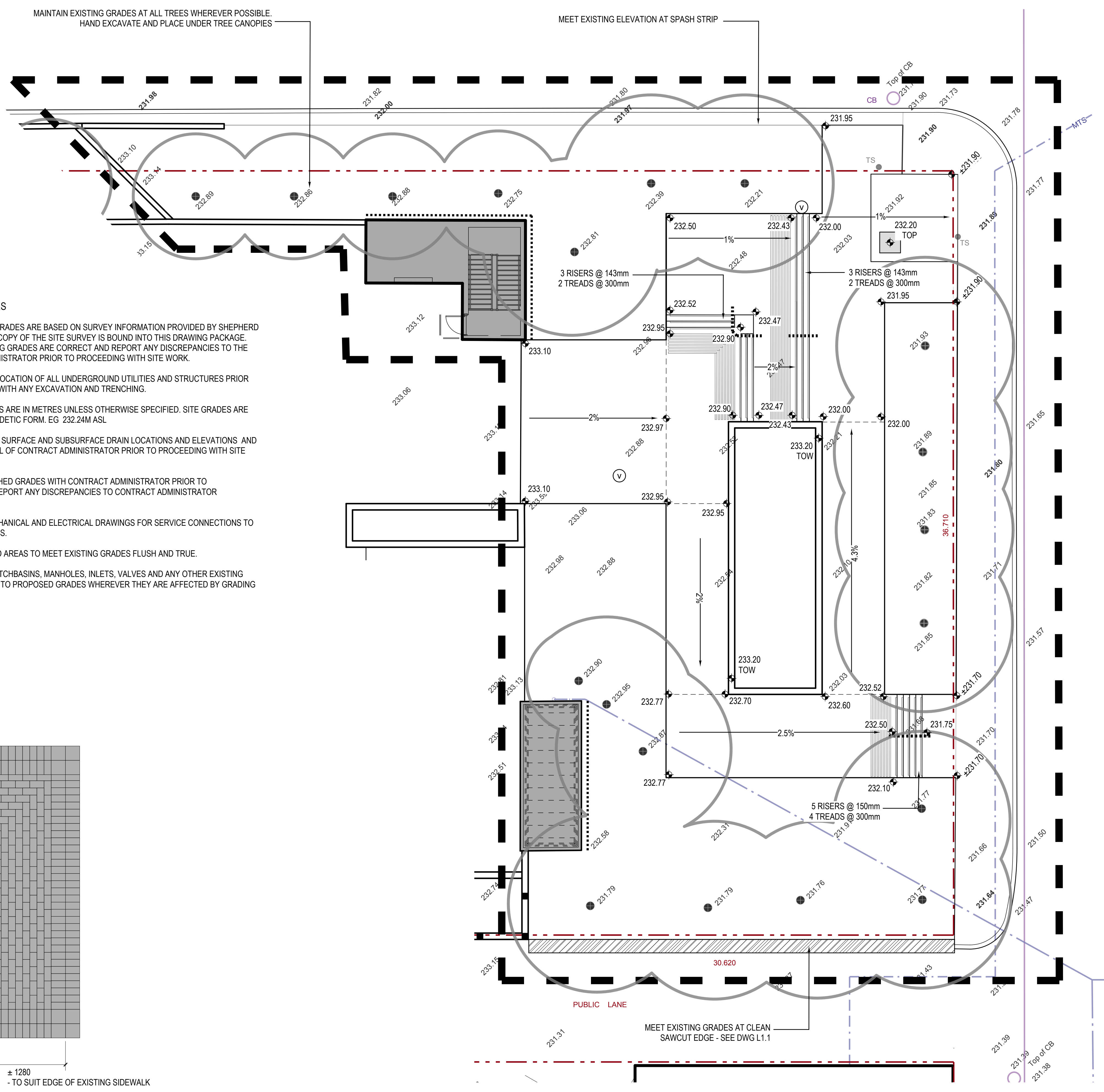

2 GRADING PLAN
SCALE 1:100

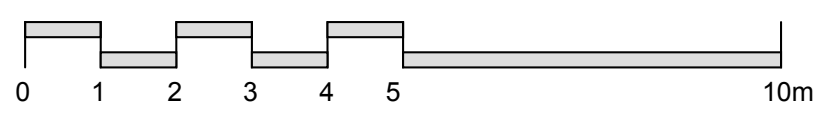
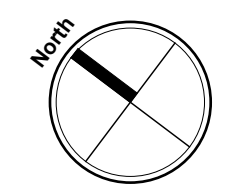

1 - ISSUED FOR TENDER	JUNE 16, 2014
ISSUE NOTES	DATE

THIS DRAWING MUST NOT BE SCALED.
THE GENERAL CONTRACTOR SHALL VERIFY ALL DIMENSIONS, DATUMS AND LEVELS PRIOR TO COMMENCEMENT OF WORK. ALL ERRORS AND OMISSIONS TO BE REPORTED IMMEDIATELY TO THE LANDSCAPE ARCHITECT.
VARIATIONS & MODIFICATIONS TO WORK SHOWN ON THESE DRAWINGS SHALL NOT BE CARRIED OUT WITHOUT WRITTEN PERMISSION FROM THE LANDSCAPE ARCHITECT.
THIS DRAWING IS THE EXCLUSIVE PROPERTY OF THE LANDSCAPE ARCHITECTS AND CAN BE REPRODUCED ONLY WITH THE PERMISSION OF THE LANDSCAPE ARCHITECTS, IN WHICH CASE THE REPRODUCTION MUST BEAR THEIR NAME AS LANDSCAPE ARCHITECTS.

PROFESSIONAL SEALS

HTFC
PLANNING & DESIGN
500-115 Bannatyne Avenue East Winnipeg, MB R3B 0R3
PHONE 204 944 9907 WEB htfc.mb.ca

PROJECT TITLE
**MILLENNIUM LIBRARY PARK
PHASE TWO
- ST MARY & SMITH ENTRANCE**
WINNIPEG, MANITOBA

SHEET TITLE
**PAVING PATTERN
& GRADING PLAN**

DRAWN RG	REVIEWED MG	DRAWING NO. L1.2
SCALE AS NOTED	PROJECT No. 14-020	
DATE PRINTED 9:50 AM Mon, Jun 23, 2014		

PRELIMINARY - NOT FOR CONSTRUCTION