

NOTE: CHAINAGES SHOWN ARE ALONG CL OF PROPOSED LDS

WARNING
 IF POWER EQUIPMENT OR EXPLOSIVES ARE TO BE USED FOR EXCAVATION ON THIS PROJECT THE CONTRACTOR MUST:
 1) NOTIFY THE GAS COMPANY OF THE PROPOSED LOCATION OF EXCAVATION.
 2) TAKE PRECAUTION TO AVOID DAMAGE TO GAS COMPANY INSTALLATIONS.
 SEE PROVINCIAL REGULATION 210/72 FOR DETAILS

PROPERTY LIMITS DELINEATION
 DELINEATION OF PROPERTY LIMITS AS SHOWN ON THIS DRAWING DOES NOT REPRESENT A "LEGAL SURVEY". JACOBS AND KGS GROUP MAKE NO REPRESENTATION OR WARRANTY AS TO THE ACCURACY OF PROPERTY LIMITS DELINEATED ON THIS DRAWING, NOR ON THE DIMENSIONAL ACCURACY OF DRAWING FEATURES RELATIVE TO THOSE PROPERTY LIMITS.

- CONSTRUCTION NOTES:**
- SEWER AND WATER SERVICES SHOWN ON DRAWING ARE APPROXIMATE ONLY.
 - LOCATION OF ALL SEWER AND WATER LINES TO BE CONFIRMED IN FIELD BY CONTRACTOR.
 - INSTALL NEW SEWER BY TRENCHLESS METHODS, UNLESS OTHERWISE NOTED.
 - ONLY CCFRPM ALTERNATIVE SHOWN FOR CLARITY. ADJUST INVERT FOR PIPE JACKING AS REQUIRED.
 - ALL SIZING FOR SHAFTS ARE SHOWN FOR PLANNING ONLY. CONTRACTOR TO DETERMINE REQUIRED SHAFT SIZE BASED ON SELECTED METHODOLOGY.
 - CONTRACTOR'S TEMPORARY SHAFT TO HAVE A MIN. OF 1.0m OF PROPOSED LDS INSTALLED INSIDE SHAFT. SHAFT TO BE FULLY BACKFILLED WITH CONTROLLED LOW STRENGTH MATERIAL (MAX. 1MPa).
 - HYDRO EXCAVATE UTILITY PRIOR TO TUNNEL CONSTRUCTION.
 - PROVIDE PRE AND POST CCTV OF UTILITY CROSSING.
 - FOR STUB OUT CONNECTION SEE LD-8902 FOR TWO-PASS OR LD-8904 FOR PIPE JACKING.
 - MID POINT OF STUB OUT TO MATCH MID POINT OF LDS TRUNK

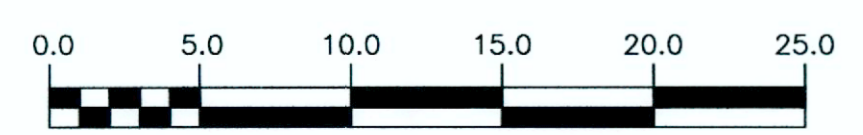
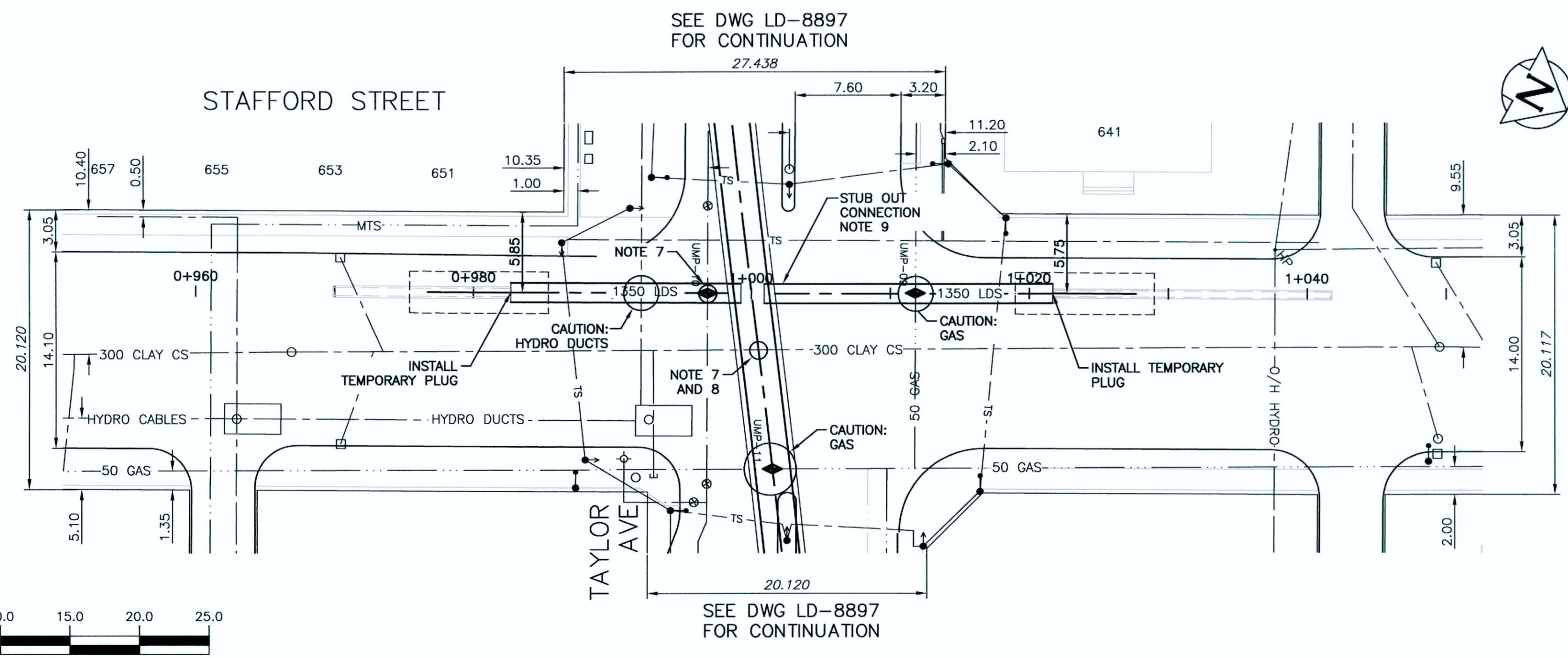

150 WM	WATER MAIN	150 WM	HYDRO	150 WM	WATER MAIN	150 WM
Hydrant	HYDRANT	M.T.S.	M.T.S.	Hydrant	HYDRANT, VALVE	Hydrant
Valve	VALVE	CONCRETE	CONCRETE	Land Drainage Sewer	LAND DRAINAGE SEWER	Land Drainage Sewer
300 LDS	LAND DRAINAGE SEWER	Asphalt	Asphalt	300 LDS	WASTE WATER SEWER	300 LDS
250 WWS	WASTE WATER SEWER	Sidewalk	Sidewalk	250 WWS	WASTE WATER SEWER	250 WWS
Manhole	MANHOLE	Planing	Planing	Centreline	CENTRELINE	Centreline
Catch Basin	CATCH BASIN	Property Line	Property Line	North/West Gutter	NORTH/WEST GUTTER	North/West Gutter
Curb Inlet	CURB INLET	Survey Bar	Survey Bar	South/East Gutter	SOUTH/EAST GUTTER	South/East Gutter
Bend	BEND	Gas	Gas	N/W, S/E IP'S	N/W, S/E IP'S	N/W, S/E IP'S
Reducer	REDUCER	Curb Stop	Curb Stop			
Tee	TEE					
Existing	LEGEND-PLAN	Proposed	LEGEND-PLAN	Proposed	LEGEND-PROFILE	Proposed

LOCATION APPROVED UNDERGROUND STRUCTURES

SUPV. U/G STRUCTURES COMMITTEE DATE

NOTE:
 LOCATION OF UNDERGROUND STRUCTURES AS SHOWN ARE BASED ON THE BEST INFORMATION AVAILABLE BUT NO GUARANTEE IS GIVEN THAT ALL EXISTING UTILITIES ARE SHOWN OR THAT THE GIVEN LOCATIONS ARE EXACT. CONFIRMATION OF EXISTENCE AND EXACT LOCATION OF ALL SERVICES MUST BE OBTAINED FROM THE INDIVIDUAL UTILITIES BEFORE PROCEEDING WITH CONSTRUCTION.

KGS GROUP CONSULTING ENGINEERS

JACOBS

DESIGNED BY: SDG
 DRAWN BY: JBC

CHECKED BY: MD
 APPROVED BY: RBO (KGS Group)

HOR. SCALE: 1:250
 VERTICAL: 1:50

ISSUED FOR TENDER: 01/2019 JBC
 NO. REVISIONS: DATE BY

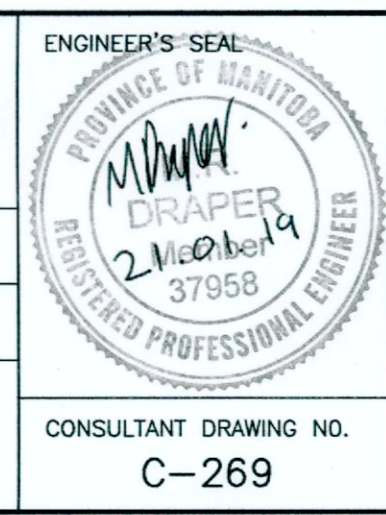

THE CITY OF WINNIPEG WATER AND WASTE DEPARTMENT

PROJECT TITLE: COCKBURN AND CALROSSIE COMBINED SEWER RELIEF WORKS - CONTRACT 5

STAFFORD STREET STUB OUTS

SHEET 12 OF 19
 COMPUTER FILE NAME: C-269.dwg
 CITY DRAWING NUMBER: LD-8901

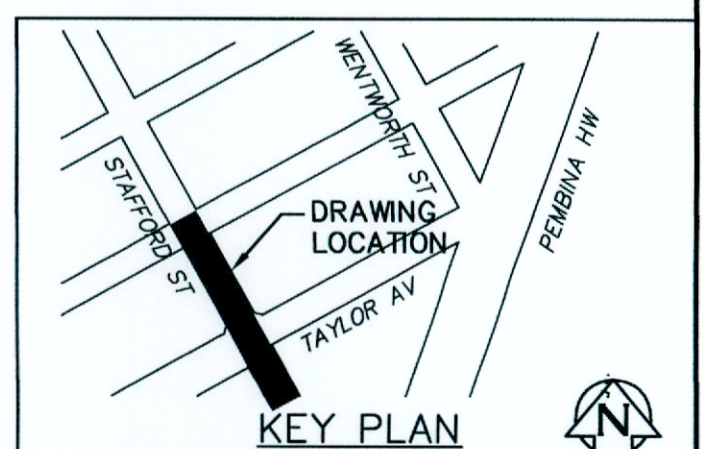

File Name: C:\pwworkdir\ch2mhill_wbg\cortez\0443046\