

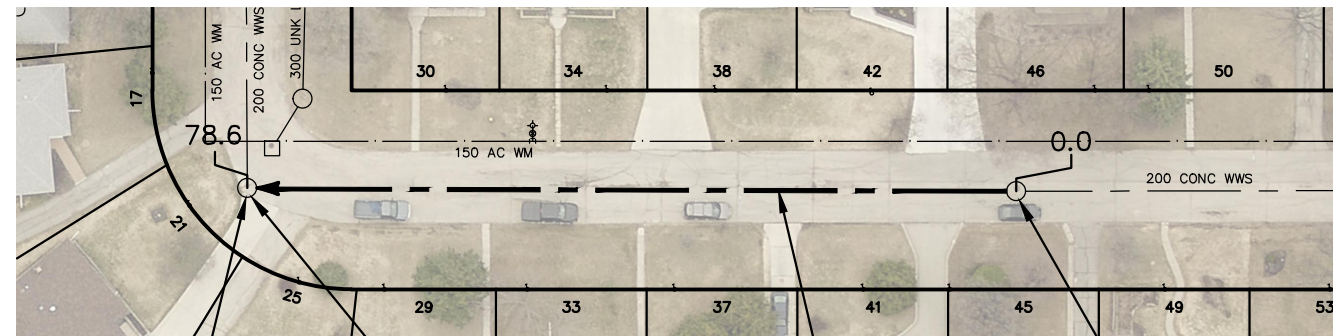

# RILEY CRESCENT

111.6m N OF N/R OF DOWKER AVE



REPLACE BENCHING  
(TO BE DONE BY OTHERS)

S-MH60015151  
RIM 232.09  
INV E 226.79  
INV S 226.79

S-MH60015207  
RIM 232.11  
INV S 228.36  
INV N 227.63

78.6 OF 200 WWS TO BE LINED  
S-MA60017535.  
(PARTIALLY DETERIORATED)

SEWER JUNCTION INFORMATION FROM SEWER VIDEO INSPECTION		
SEWER ID S-MA60017535		
DISTANCE FROM MH ID S-MH60015207		
DISTANCE	DIAMETER	CLOCK
4.6	100	2
7.7	100	10
17.0	100	2
20.1	100	10
31.8	100	2
32.6	100	2
35.7	100	10
47.4	100	2
49.9	100	2
50.5	100	10
56.8	100	2
59.9	100	2
62.9	100	10
65.9	100	2
66.3	100	11
75.3	100	10

FOR INDEX SEE  
11697

METRIC

WHOLE NUMBERS INDICATE MILLIMETRES  
DECIMALIZED NUMBERS INDICATE METRES

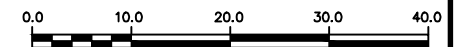

### WARNING

IF POWER EQUIPMENT OR EXPLOSIVES ARE TO BE USED FOR EXCAVATION ON THIS PROJECT THE CONTRACTOR MUST:

- 1) NOTIFY THE GAS COMPANY OF THE PROPOSED LOCATION OF EXCAVATION.
- 2) TAKE PRECAUTION TO AVOID DAMAGE TO GAS COMPANY INSTALLATIONS.

SEE PROVINCIAL REGULATION 210/72 FOR DETAILS

LOCATION APPROVED  
UNDERGROUND STRUCTURES

SUPV. U/G STRUCTURES COMMITTEE DATE

NOTE:

LOCATION OF UNDERGROUND STRUCTURES AS SHOWN ARE BASED ON THE BEST INFORMATION AVAILABLE BUT NO GUARANTEE IS GIVEN THAT ALL EXISTING UTILITIES ARE SHOWN OR THAT THE GIVEN LOCATIONS ARE EXACT. CONFIRMATION OF EXISTENCE AND EXACT LOCATION OF ALL SERVICES MUST BE OBTAINED FROM THE INDIVIDUAL UTILITIES BEFORE PROCEEDING WITH CONSTRUCTION.

B.M.  
ELEV.

NO.	REVISIONS	DATE	BY

DESIGNED BY	SC	CHECKED BY	SC
DRAWN BY	BL	APPROVED BY	KZ
SCALE:	1:750	RELEASED FOR CONSTRUCTION	K.ZUREK
HORIZONTAL		DATE	2018 05 14
VERTICAL		DATE	2018 05 16

ENGINEER'S SEAL

ORIGINAL SIGNED  
BY S.R.J COURNOYER  
18/05/14

CONSULTANT DRAWING NUMBER  
-



THE CITY OF WINNIPEG  
WATER AND WASTE DEPARTMENT  
ENGINEERING DIVISION

2017 SEWER MAIN RENEWALS  
BY CIPP LINING

RILEY CRESCENT

2ND MH N OF DOWKER AVENUE TO  
MH AT RILEY CRESCENT (N-LEG)

SHEET 34 OF 53  
CITY DRAWING NUMBER

11728

PLOT DATE: 2018 05 16

BID OPPORTUNITY: 112-2018  
CONTRACT NUMBER: 5

FILE PATH: R:\DRAWINGS\SEWER\2017 RENEWALS\CIPP-FSR-EPR\Cont. 5\CONSTRUCTION DWGS\  
FILE NAME: RILEY CR (W LEG).dwg