

SEWER JUNCTION INFORMATION FROM SEWER VIDEO INSPECTION

SEWER ID S-MA40007869		
DISTANCE FROM MH40007164		
DISTANCE	DIAMETER	CLOCK
10.4	150	10
12.1	150	2
15.3	150	10
16.5	150	10
24.0	150	10
25.9	150	10
26.1	150	2
30.8	150	10
41.6	150	3
42.4	150	2
42.8	150	10
44.6	150	10
44.9	150	2
47.0	150	2
47.9	150	10
56.5	150	2
60.3	150	10
64.3	150	10
72.1	150	2
81.5	150	10
83.0	150	2
87.0	150	2

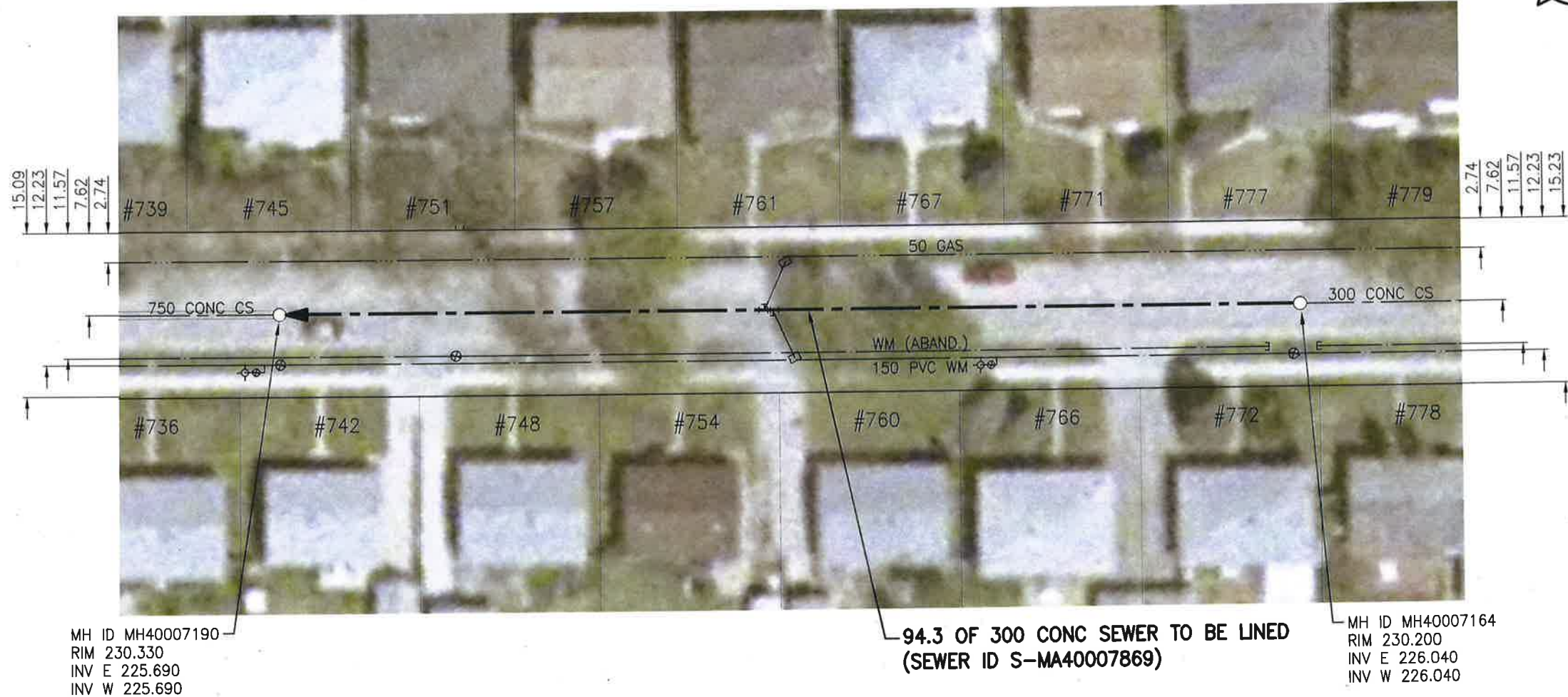

HOSKIN AVENUE



WARNING

IF POWER EQUIPMENT OR EXPLOSIVES ARE TO BE USED FOR EXCAVATION ON THIS PROJECT THE CONTRACTOR MUST:
 1) NOTIFY THE GAS COMPANY OF THE PROPOSED LOCATION OF EXCAVATION.
 2) TAKE PRECAUTION TO AVOID DAMAGE TO GAS COMPANY INSTALLATIONS.
 SEE PROVINCIAL REGULATION 140/92 FOR DETAILS

ENGINEERS GEOSCIENTISTS MANITOBA
 Certificate of Authorization
 Stantec Consulting Ltd.
 No. 1301

METRIC
 WHOLE NUMBERS INDICATE MILLIMETRES
 DECIMALIZED NUMBERS INDICATE METRES
 1:500 [Scale bar showing 0, 5, 15, 25m]
 BID OPPORTUNITY NO. 1167-2018

LOCATION APPROVED UNDERGROUND STRUCTURES		B.M. ELEV.
SUPV. U/G STRUCTURES COMMITTEE	DATE	
NOTE: LOCATION OF UNDERGROUND STRUCTURES AS SHOWN ARE BASED ON THE BEST INFORMATION AVAILABLE BUT NO GUARANTEE IS GIVEN THAT ALL EXISTING UTILITIES ARE SHOWN OR THAT THE GIVEN LOCATIONS ARE EXACT. CONFIRMATION OF EXISTENCE AND EXACT LOCATION OF ALL SERVICES MUST BE OBTAINED FROM THE INDIVIDUAL UTILITIES BEFORE PROCEEDING WITH CONSTRUCTION.		
1	ISSUED FOR TENDER	19.01.02 RS
NO.	REVISIONS	DATE BY

DESIGNED BY	CHECKED BY	DRAWN BY	APPROVED BY	HOR. SCALE:	VERTICAL:	RELEASED FOR CONSTRUCTION:	DATE
RS	RS	SC	RS	1:500		<i>[Signature]</i>	18.10.29

Stantec
 905 Waverley Street, Winnipeg, Manitoba
 Tel 204-489-5900 Fax 204-453-9012

ENGINEER'S SEAL
 PROVINCE OF MANITOBA
 R.M. SHERLOCK
 REGISTERED PROFESSIONAL ENGINEER
 MEMBER 24045

CONSULTANT DRAWING NO. C-115

THE CITY OF WINNIPEG
 WATER AND WASTE DEPARTMENT

2018 SEWER RENEWALS BY CIPP LINING
 CONTRACT 7
HOSKIN AVENUE
 1ST MH W OF LONDON ST TO
 2ND MH W OF LONDON ST

SHEET 16 OF 48
 CAD FILE DRAWING NUMBER 18120c-III-922.dwg
 CITY DRAWING NUMBER 11851

V:\1112\active\111218120\0300_drawing\0302_sheet_files\02_civil\18120c-111-922.dwg