

SEWER JUNCTION INFORMATION FROM SEWER VIDEO INSPECTION		
SEWER ID S-MA40009826		
DISTANCE FROM MH40008903		
DISTANCE	DIAMETER	CLOCK
22.1	150	3

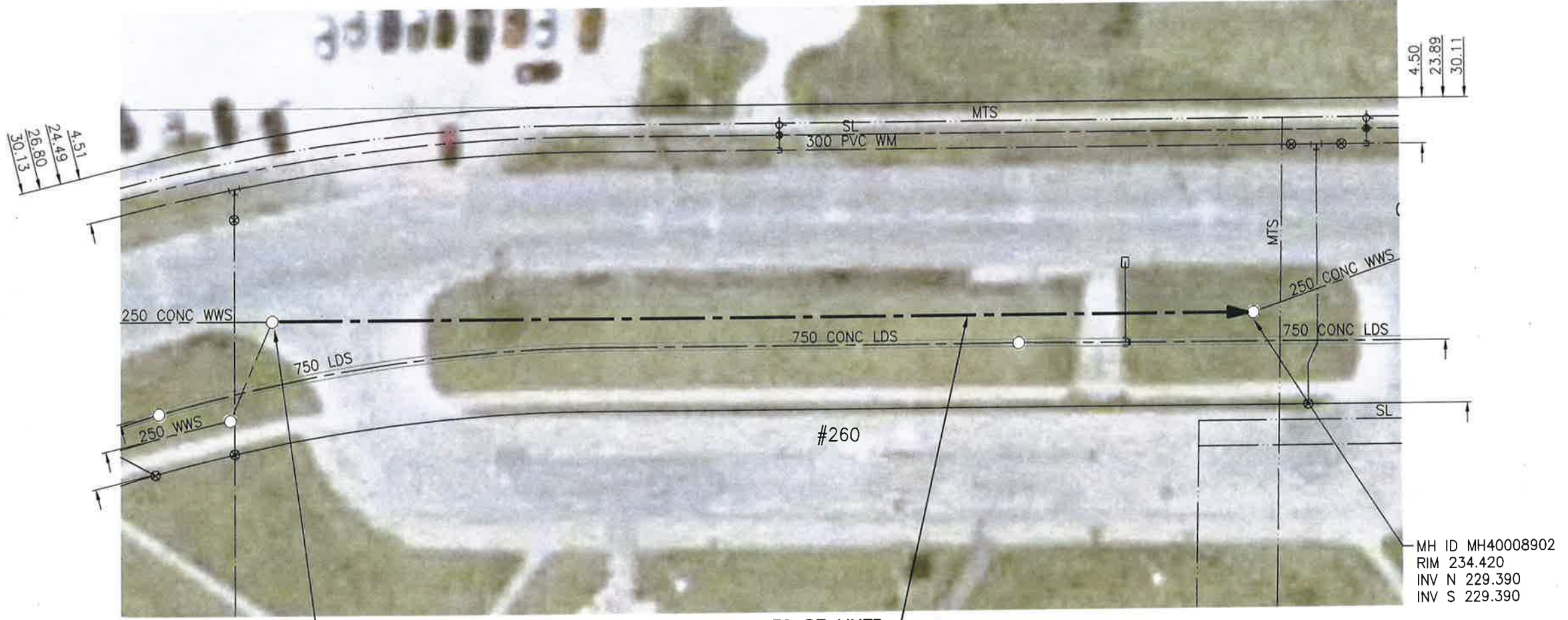

REDONDA STREET



MH ID MH40008903
RIM 234.140
INV N 229.650
INV S 229.650
INV E 229.650

96.4 OF 250 CONC SEWER TO BE LINED
(SEWER ID S-MA40009826)

MH ID MH40008902
RIM 234.420
INV N 229.390
INV S 229.390

**ENGINEERS
GEOSCIENTISTS
MANITOBA**

Certificate of Authorization
Stantec Consulting Ltd.
No. 1301

METRIC

WHOLE NUMBERS INDICATE MILLIMETRES
DECIMALIZED NUMBERS INDICATE METRES

1:500

BID OPPORTUNITY NO. 1167-2018

WARNING

IF POWER EQUIPMENT OR EXPLOSIVES ARE TO BE USED FOR EXCAVATION ON THIS PROJECT THE CONTRACTOR MUST:

- 1) NOTIFY THE GAS COMPANY OF THE PROPOSED LOCATION OF EXCAVATION.
- 2) TAKE PRECAUTION TO AVOID DAMAGE TO GAS COMPANY INSTALLATIONS.

SEE PROVINCIAL REGULATION 140/92 FOR DETAILS

LOCATION APPROVED UNDERGROUND STRUCTURES

SUPV. U/G STRUCTURES COMMITTEE DATE

NOTE:
LOCATION OF UNDERGROUND STRUCTURES AS SHOWN ARE BASED ON THE BEST INFORMATION AVAILABLE BUT NO GUARANTEE IS GIVEN THAT ALL EXISTING UTILITIES ARE SHOWN OR THAT THE GIVEN LOCATIONS ARE EXACT. CONFIRMATION OF EXISTENCE AND EXACT LOCATION OF ALL SERVICES MUST BE OBTAINED FROM THE INDIVIDUAL UTILITIES BEFORE PROCEEDING WITH CONSTRUCTION.

NO.	REVISIONS	DATE	BY
1	ISSUED FOR TENDER	19.01.02	RS

Stantec
905 Waverley Street, Winnipeg, Manitoba
Tel 204-489-5900 Fax 204-453-9012

DESIGNED BY	RS	CHECKED BY	RS
DRAWN BY	SC	APPROVED BY	RS
HOR. SCALE:	1:500	RELEASED FOR CONSTRUCTION:	
VERTICAL:		DATE	01/02/19
DATE	18.10.29		

ENGINEER'S SEAL

PROVINCE OF MANITOBA
R.M. SHERLOCK
REGISTERED PROFESSIONAL ENGINEER
MEMBER 24045

CONSULTANT DRAWING NO.
C-132

THE CITY OF WINNIPEG
WATER AND WASTE DEPARTMENT

2018 SEWER RENEWALS BY CIPP LINING
CONTRACT 7
REDONDA STREET
4TH MH S OF KILDARE AVE E TO
3RD MH S OF KILDARE AVE E

SHEET	OF
33	48
CAD FILE DRAWING NUMBER 18120c-131-922.dwg	
CITY DRAWING NUMBER 11868	

V:\1112\active\111218120\0300_drawing\0302_sheet_files\02_civil\18120c-131-922.dwg