

**NOTES:**

**CONSTRUCTION STANDARDS:**  
 TO BE CONSTRUCTED IN ACCORDANCE WITH MANITOBA HYDRO DISTRIBUTION AND SUBTRANSMISSION STANDARDS, LATEST REVISION. NO MAJOR CHANGE SHALL BE MADE WITHOUT APPROVAL OF THE DESIGN ENGINEER OR DELEGATE.

**SITE GRADING:**  
 THE DEVELOPER IS RESPONSIBLE FOR GRADING OF THE SITE TO WITHIN +/-0.15M OF FINISHED GRADE PRIOR TO CONSTRUCTION COMMENCEMENT. BENCHMARKS ARE TO BE OBTAINED FROM THE DEVELOPER OR CONSULTANT.

AUTHORITY	NOTIFIED	NOT REQ'D	OBTAINED
DISTRICT	2019-03-05		
C.O.W/MUNICIPAL	2019-03-18		
M.T.S.		X	
GAS		X	
SHAW		X	
EASEMENTS		X	
COMMUNICATIONS		X	
S.C.C.		X	
DEPT. OF HIGHWAYS		X	

CONTACT	NAME	PHONE NUMBER	E-MAIL ADDRESS
DESIGN	IAN MCCALLUM	479-3154	IMCCALLUM@HYDRO.MB.CA
DESIGN ENGINEER	ERIC WICKSTROM	770-2410	EWICKSTROM@HYDRO.MB.CA
PORTFOLIO PM	DARIN WACH	451-2617	DWACH@HYDRO.MB.CA
ENERGY SERVICE ADVISOR	DARRYL STOCKI	918-0341	DSTOCKI@HYDRO.MB.CA
LIG CONSTRUCTION	BILL AMMETER	981-8356	BAMMETER@HYDRO.MB.CA
OH CONSTRUCTION	WAYNE IRELAND	771-5212	WIRELAND@HYDRO.MB.CA
HYDRO GAS			
SHAW			
MTS			
CUSTOMER REPRESENTATIVE	JASON DOERKSEN	986-3614	JDOERKSEN@WINNPEG.CA
DISTRICT ENG TECH	GEORGE WEDDALL	360-7451	GWEDDALL@HYDRO.MB.CA

LOCATION	LUMINAIRE	TYPE	MOUNTING HEIGHT (CD/M)	AVG. AV. MIN. MAX. MIN. MAX. MIN. MAX. MIN. MAX.	AVE. SPACING		
CORYDON AVE	150W LED	II	10.7M	1.03	1.98	3.33	64

LED CONVERSION CHART		
HPS WATTAGE	EQUIVALENT LED WATTAGE	CATALOG NUMBER
100	73	ERS10C3E1540
150	95	ERS10C3E1740
250	138	ERS20H3E1540
400	209	ERS30N3E1540

INSTALLED			
Quantity	Fixture Type	Wattage	Pole Type
1	LED	60	EXCLUSIVE
9	LED	150	EXCLUSIVE

REMOVED			
Quantity	Fixture Type	Wattage	Pole Type
9	LED	150	EXCLUSIVE

BANNERS AND ASSOCIATED HARDWARE TO BE REMOVED AND RETURNED TO THE CITY OF WINNIPEG, 1277 PACIFIC AVENUE WITH AN ITEMIZED LIST AND QUANTITIES.

REEL NUMBER	MANUFACTURER	MANUFACTURE DATE

\*STREETLIGHT PLACEMENT FOLLOWS IES STANDARDS AND THEY ARE PLACED ACCORDINGLY USING DRIVEWAY LOCATIONS PROVIDED BY THE DEVELOPER. DRIVEWAY LOCATIONS THAT HAVE BEEN CHANGED AFTER THE DESIGN HAS BEEN SEALED RESULTING IN A CONFLICT BETWEEN STREETLIGHTS AND THE DRIVEWAY ARE THE RESPONSIBILITY OF THE DEVELOPER TO RECOVER THE COSTS ASSOCIATED WITH RELOCATING THE STREETLIGHTS.

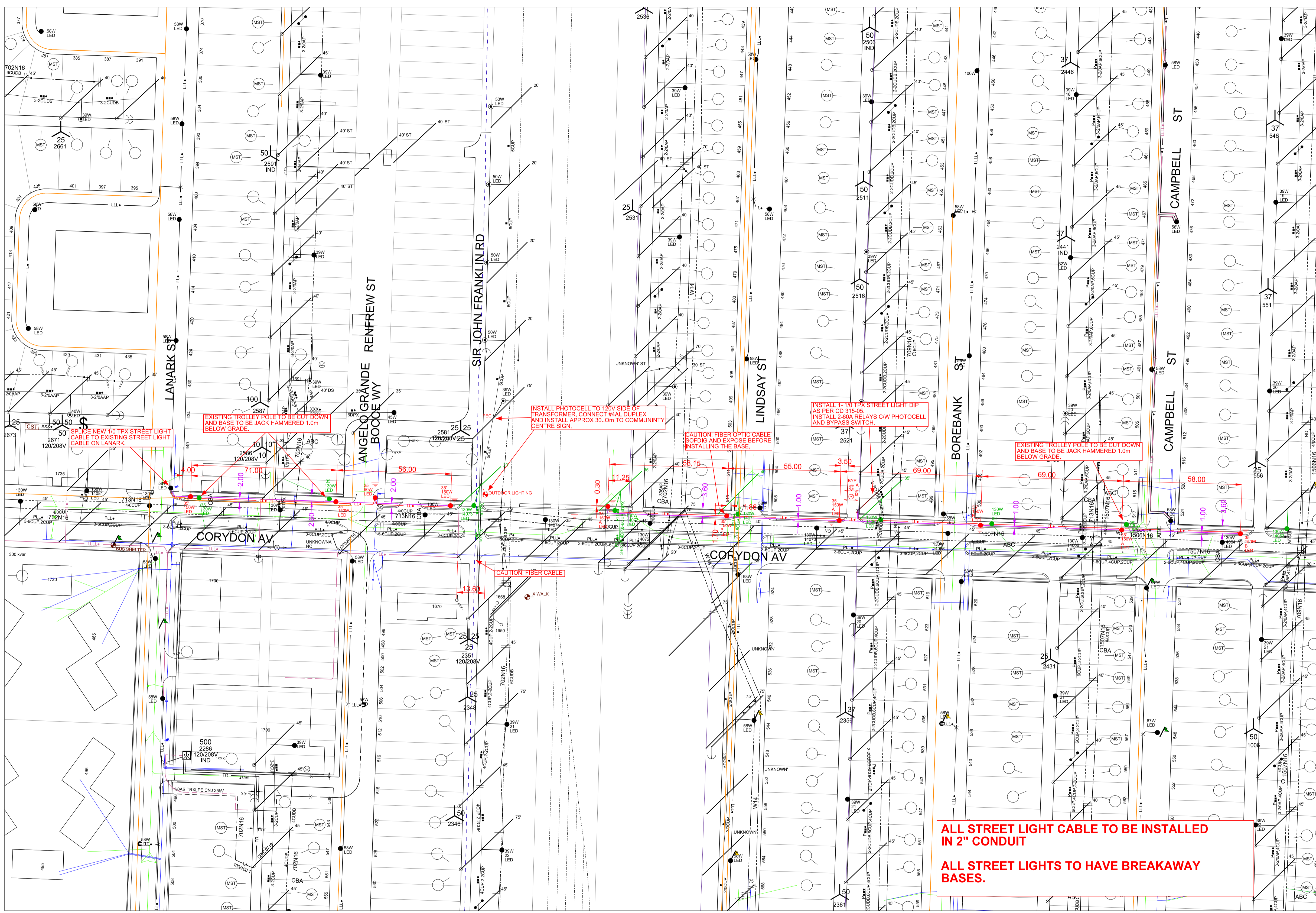

**ALL STREET LIGHT CABLE TO BE INSTALLED IN 2" CONDUIT**

**ALL STREET LIGHTS TO HAVE BREAKAWAY BASES.**

THIS IS A PRINT OF A DOCUMENT THAT HAS BEEN ELECTRONICALLY AUTHENTICATED WITH TECHNOLOGY AUTHORIZED BY THE EGM. THE ORIGINAL IS IN ELECTRONIC FORM.

INFORMATION PERTAINING TO THE SIZE AND LOCATION OF MANITOBA HYDRO FACILITIES AND INSTALLATIONS IS ILLUSTRATIVE AND SHOULD NOT BE RELIED ON FOR THE PURPOSE OF ANY ACTIVITY BEING CONDUCTED AT OR NEAR THE IDENTIFIED HYDRO INSTALLATIONS. ALL LOCATIONS AND EQUIPMENT MUST BE VERIFIED BY APPROPRIATE HYDRO DISTRICT OFFICES PRIOR TO ANY PHYSICAL ACTIVITY UNDERTAKEN AT OR NEAR HYDRO INSTALLATIONS. A CURRENT WORK CLEARANCE REQUEST FORM CAN BE OBTAINED FROM THE DISTRICT OFFICE AND MUST BE ON SITE PRIOR TO THE COMMENCEMENT OF ANY EXCAVATIONS.

CONTACT "CLICK BEFORE YOU DIG MANITOBA" AT  
[ClickBeforeYouDigMB.com](http://ClickBeforeYouDigMB.com)  
 THREE FULL WORKING DAYS  
 PRIOR TO CONSTRUCTION FOR LOCATION OF EXISTING WATER, WASTEWATER, LAND DRAINAGE UTILITIES AND MANITOBA HYDRO UTILITIES

**PRELIMINARY**

NOT TO BE USED FOR CONSTRUCTION

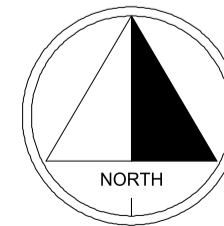

NO.	DATE	REVISION	BY	KCD.	APP.

DRAWING NUMBER	REFERENCE DRAWINGS	DRAWN	IM
CHECK		SCALE	1:1000
DATE	2019-03-04		

AREA NUMBER	5202	MANITOBA HYDRO
STATION NUMBER	1507	DISTRIBUTION PLANNING & DESIGN
FEDDER NUMBER	701N16,706N20	WBS # P-31739
SYSTEM VOLTAGE	2.4/4.16KV	DISTRICT: CITY CENTRE
		NETWORK # 4305733
		CORYDON AVE.
		NEW ROADWAY LIGHTING, NORTH SIDE CORYDON AVE
		BETWEEN LANARK ST AND CORDOVA ST

		SHT.	REV.
		01	00

FOR MICROFILM USE ONLY