

SELKIRK AVENUE

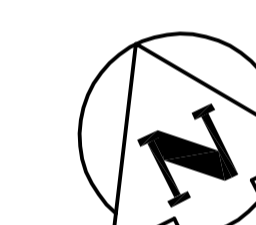
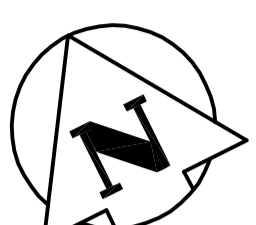
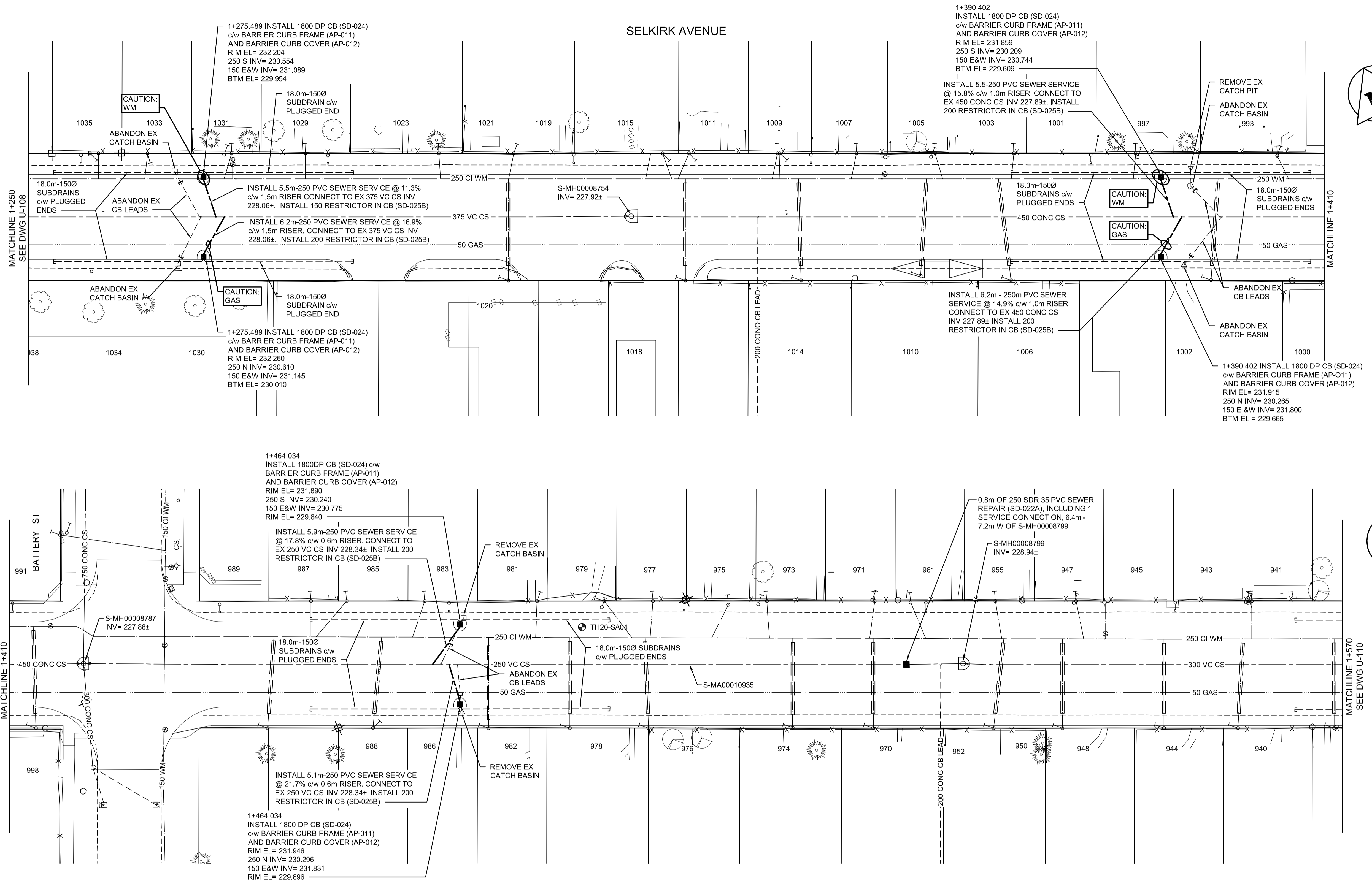

**METRIC**

WHOLE NUMBERS INDICATE MILLIMETRES  
DECIMALIZED NUMBERS INDICATE METRES

**WARNING**

IF POWER EQUIPMENT OR EXPLOSIVES ARE TO BE USED FOR EXCAVATION ON THIS PROJECT THE CONTRACTOR MUST:

- 1) NOTIFY THE GAS COMPANY OF THE PROPOSED LOCATION OF EXCAVATION.
  - 2) TAKE PRECAUTION TO AVOID DAMAGE TO GAS COMPANY INSTALLATIONS.
- SEE PROVINCIAL REGULATION 140/92 FOR DETAILS

ALL LONG SIDE WATER SERVICES WITHIN THE LIMITS OF THE RECONSTRUCTION SHALL BE INSULATED AS PER SPEC E-19

PLAN:

**NOTES:**

1. ADJUST MANHOLE RIMS, VALVES AND HYDRANTS TO NEW GRADES WHERE REQUIRED.
2. EXISTING MANHOLE FRAMES AND COVERS TO BE REPLACED WITH NEW FRAMES AND COVERS WITHIN THE RECONSTRUCTION LIMITS.
3. CONTRACTOR TO CONFIRM THE LOCATIONS OF ALL UTILITIES/SERVICES IN THE FIELD PRIOR TO CONSTRUCTION.
4. ALL NEW SEWER SERVICE PIPE TO BE TRENCHLESS INSTALLATION.
5. PROTECT INSULATION DURING INSTALLATION, TAKING CARE NOT TO DAMAGE DURING BACKFILL OPERATIONS.

EXISTING	LEGEND-PLAN	PROPOSED	EXISTING	LEGEND-PLAN	PROPOSED	EXISTING	LEGEND-PROFILE	PROPOSED
	WATERMAIN			HYDRO			NORTH OR WEST GUTTER	
	VALVE			CONCRETE			SOUTH OR EAST GUTTER	
	LAND DRAINAGE SEWER			ASPHALT			NORTH MEDIAN GUTTER	
	WASTE WATER SEWER			SIDEWALK			SOUTH MEDIAN GUTTER	
	MANHOLE			ASPHALT MILL & FILL			NORTH OR WEST P L	
	CATCH BASIN			STREET LIGHT			SOUTH OR EAST P L	
	CURB INLET/CATCH PIT			HYDRO POLE				
	TRANSIT STOP			SURVEY BAR				
	GAS			ELEVATION				
	PROPERTY LINE			SIDEWALK RAMP				

**LOCATION APPROVED UNDERGROUND STRUCTURES**

SUPV. U/G STRUCTURES COMMITTEE DATE

**NOTE:**

LOCATION OF UNDERGROUND STRUCTURES AS SHOWN ARE BASED ON THE BEST INFORMATION AVAILABLE BUT NO GUARANTEE IS GIVEN THAT ALL EXISTING UTILITIES ARE SHOWN OR THAT THE GIVEN LOCATIONS ARE EXACT. CONFIRMATION OF EXISTENCE AND EXACT LOCATION OF ALL SERVICES MUST BE OBTAINED FROM THE INDIVIDUAL UTILITIES BEFORE PROCEEDING WITH CONSTRUCTION.

NO.	REVISIONS	DATE	BY
2	ISSUED FOR TENDER	21.03.05	S.R.S.
1	ISSUED FOR U/G STRUCTURES REVIEW	21.01.13	S.R.S.
0	ISSUED FOR PRELIMINARY REVIEW	20.07.10	S.R.S.



DESIGNED BY	R.S.	CHECKED BY	R.S.
DRAWN BY	W.A.	APPROVED BY	S.R.S.
HOR. SCALE:	1:250	RELEASED FOR CONSTRUCTION:	
VERTICAL:	-	DATE	20/05/15

ENGINEER'S SEAL

**PRELIMINARY DRAWING**

NOT TO BE USED FOR CONSTRUCTION

CONSULTANT DRAWING NO. U-109

**THE CITY OF WINNIPEG**  
PUBLIC WORKS DEPARTMENT  
ENGINEERING DIVISION

2021-2022 - SELKIRK AVE AND WILLIAM AVE  
PAVEMENT RENEWALS  
SELKIRK AVENUE  
STA. 1+250 TO STA. 1+570  
UNDERGROUND INFRASTRUCTURE

SHEET 15 OF 29  
CAD FILE DRAWING NUMBER 08150u-108.dwg  
CITY DRAWING NUMBER P-3533-15

V:\1171\selkirk\117108.dwg 0809\_c:\pwworking\0809\_c:\pwworking\0809\_u-108.dwg 2021/03/02 11:50 AM B:\Schuch\Concave