

FILE NAME: 20211423-Nairn-PR-02.dwg Saved By: atepppner
 PLOT: 2/9/2021 3:24:02 PM
 A1 SIZE 594mm x 841mm

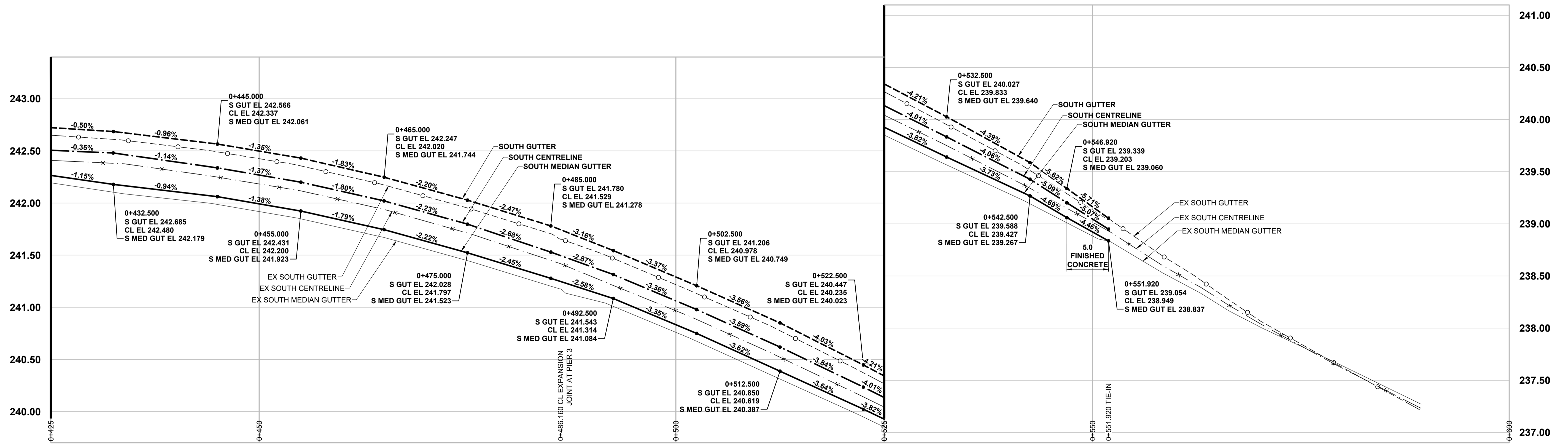

PROFILE - EASTBOUND

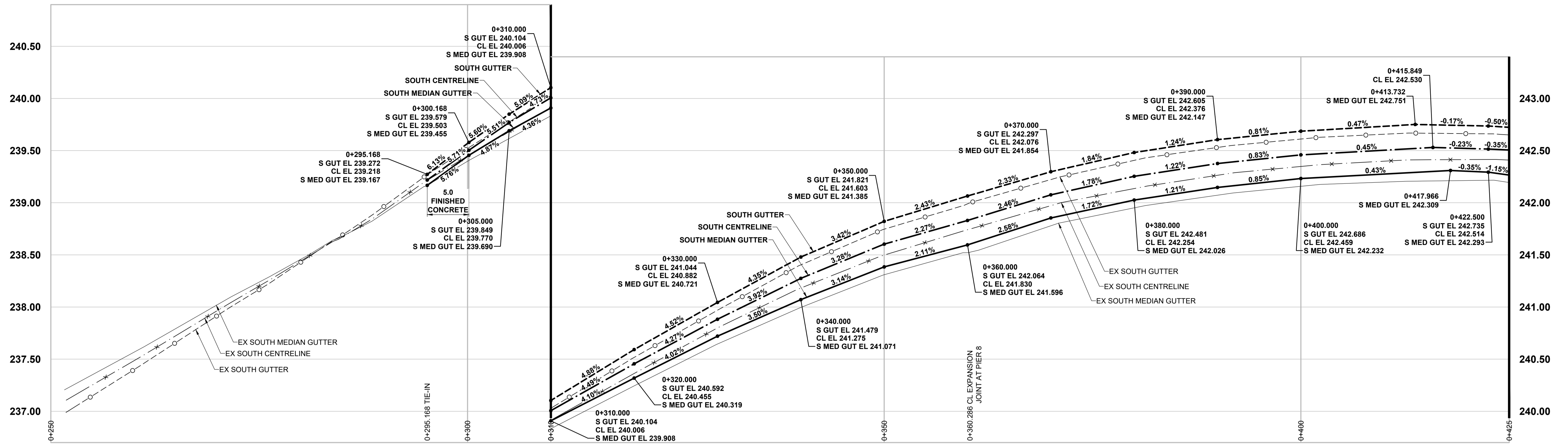
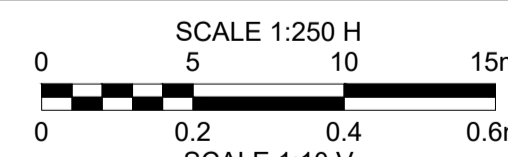

NOTE:
 1. CONTRACT ADMINISTRATOR TO PROVIDE LAYOUT FOR ASPHALT OVERLAY PAVING.

LOCATION APPROVED
 UNDERGROUND STRUCTURES

DATE: _____

NOTE:
 LOCATION OF UNDERGROUND STRUCTURES AS SHOWN ARE BASED ON THE BEST INFORMATION AVAILABLE BUT NO GUARANTEE IS GIVEN THAT ALL EXISTING UTILITIES ARE SHOWN OR THAT THE GIVEN LOCATIONS ARE EXACT. CONFIRMATION OF EXISTENCE AND EXACT LOCATION OF ALL SERVICES MUST BE OBTAINED FROM THE INDIVIDUAL UTILITIES BEFORE PROCEEDING WITH CONSTRUCTION.

BM 28-022 ELEV 231.341 m	N.W. Cor. Nairn Ave. & Grey St. in Valve Box, Bolt in 4.8 m Conc. pile, 2.4 m E. of W.L. of Grey St. & 0.6 m N. of N.L. of Nairn Ave. produced from the E.
C	ISSUED FOR TENDER 21/02/09 BE
B	ISSUED FOR REVIEW 21/02/04 BE
A	ISSUED FOR REVIEW 21/01/18 BE
No. REVISIONS	Y/M/M/D/D BY DATE

MORRISON HERSHFIELD	
DESIGNED BY: JGK	CHECKED BY: RPB
DRAWN BY: DML	APPROVED BY: BWB
RELEASED FOR CONSTRUCTION	
HOR SCALE: AS SHOWN	VERT SCALE: AS SHOWN
DATE: 21/01/15	DATE: _____

PROFESSIONAL'S SEAL

PRELIMINARY DRAWING

NOT TO BE USED FOR CONSTRUCTION

CONSULTANT FILE NAME
 2021423-NAIRN-PR-02.DWG

THE CITY OF WINNIPEG
 PUBLIC WORKS DEPARTMENT
 ENGINEERING DIVISION

NAIRN AVENUE OVERPASS DECK REHABILITATION

PROFILE EASTBOUND LANES

CITY DRAWING NUMBER: B121-21-05
 SHEET OF: 05 OF 12
 DRAWING NUMBER: 05

METRIC
 WHOLE NUMBERS INDICATE MILLIMETRES
 DECIMALIZED NUMBERS INDICATE METRES

TENDER No. 810-2020