

MUNROE AVENUE

FOR CONTINUATION SEE DWG P-3522-02

SEE DWG BELOW

MATCHLINE 7+90

MATCHLINE 9+65

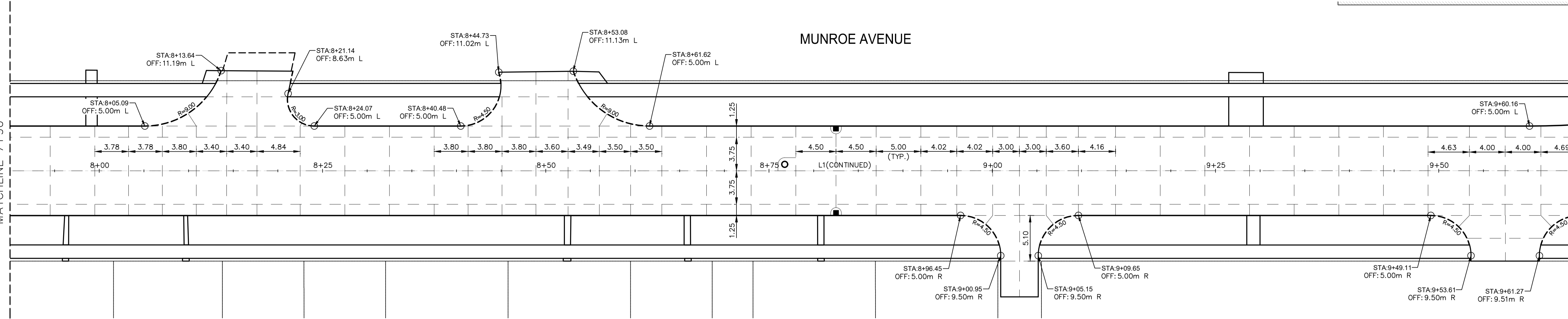

SEE DWG ABOVE

FOR CONTINUATION SEE DWG P-3522-04

MATCHLINE 9+65

MATCHLINE 11+15

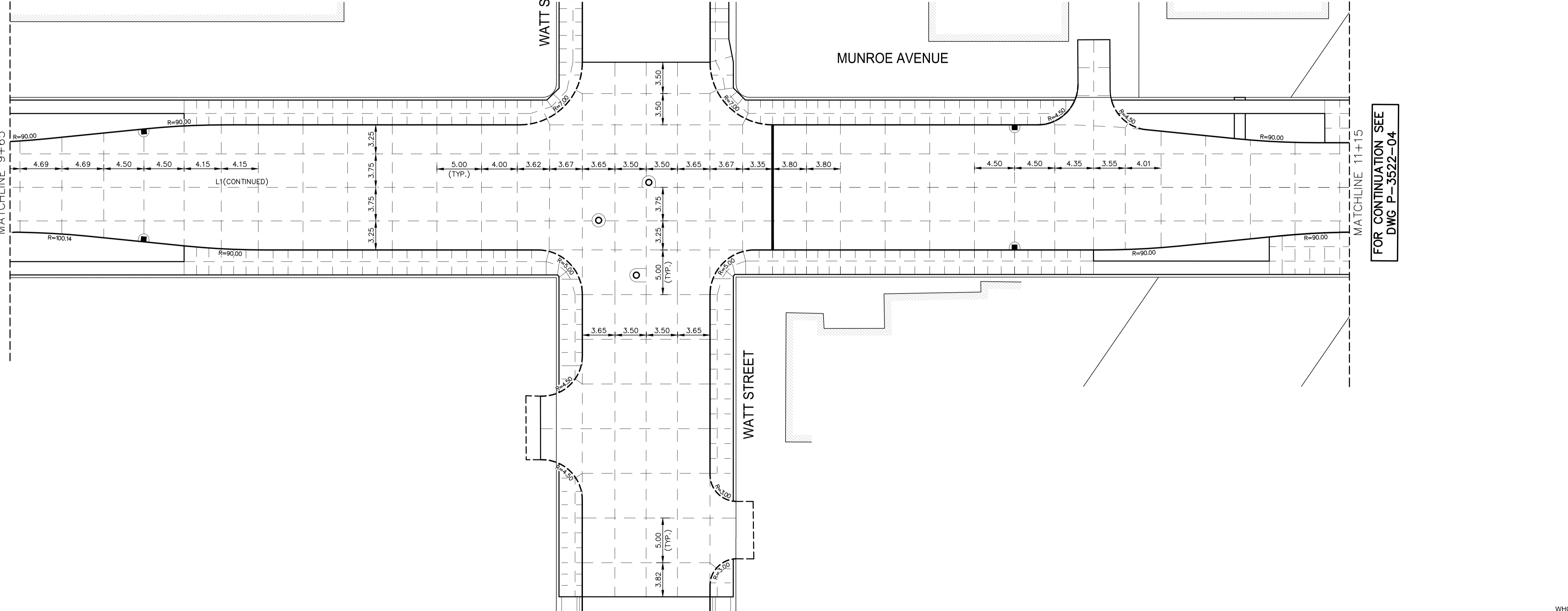

Line Table: MUNROE AVENUE ALIGNMENT

LINE #	LENGHT	START STATION	END STATION	START POINT	END POINT
L1	952.32	0+83.92	10+36.25	N 5531631.453, E 635691.214	N 5531217.363, E 636548.797
L2	689.50	10+36.25	17+25.74	N 5531217.363, E 636548.797	N 5530917.492, E 637169.673

FOR TENDER PURPOSES ONLY
NOT FOR CONSTRUCTION

METRIC
WHOLE NUMBERS INDICATE MILLIMETRES
DECIMALIZED NUMBERS INDICATE METRES



EXISTING	LEGEND-PLAN	PROPOSED	EXISTING	LEGEND-PLAN	PROPOSED	EXISTING	LEGEND-PROFILE	PROPOSED	EXISTING	LEGEND-PROFILE	PROPOSED
---	WATER MAIN	---	⊕	IRON BAR	---	---	---	---	---	---	---
---	LAND DRAINAGE SEWER	---	—●—	HYDRO POLE & LIGHT STANDARD	---	---	---	---	---	---	---
---	WASTE WATER SEWER	---	—○—	LIGHT STANDARD OR TRAFFIC SIGNAL	---	---	---	---	---	---	---
---	HYDRO	---	HP	HYDRO POLE	---	---	---	---	---	---	---
---	BELL/MTS	---	□	CURB RAMP	---	---	---	---	---	---	---
---	GAS	---	⊕	DETECTABLE WARNING SURFACE TILE	---	---	---	---	---	---	---
---	SIGNALS	---	—/—/—	EDGE OF SIDEWALK	---	---	---	---	---	---	---
○	MANHOLE	●	—/—/—	FENCE	---	---	---	---	---	---	---
□	CATCH BASIN	■	---	PROPERTY LINE	---	---	---	---	---	---	---
△	CURB INLET	▽	---	EDGE OF ASPHALT	---	---	---	---	---	---	---
∩	UTILITIES ADJUSTED	△ □ ○	---	EDGE OF CONCRETE	---	---	---	---	---	---	---
∩	PLUG	∩	---	MODIFIED BARRIER CURB	---	---	---	---	---	---	---
◇	HYDRANT	◆	---	BARRIER CURB	---	---	---	---	---	---	---
⊗	VALVE	⊗	---	BARRIER CURB AND GUTTER	---	---	---	---	---	---	---
⊕	CURB STOP	⊕	---	CONC SIDEWALK	---	---	---	---	---	---	---
230.99	GROUND GRADE	(231.00)	---	CONCRETE SLAB	---	---	---	---	---	---	---
(231.00)	PAVEMENT GRADE	(231.00)	---	ASPHALT	---	---	---	---	---	---	---
—	ANCHOR	—	---	MILLED SURFACE	---	---	---	---	---	---	---
#111	CIVIC ADDRESS	#111	---	ASPHALT JOINT REPAIR	---	---	---	---	---	---	---
---	EXISTING	---	---	LEGEND-PLAN	---	---	---	---	---	---	---

LOCATIONS APPROVED UNDERGROUND STRUCTURES

LOCATION OF UNDERGROUND STRUCTURES AS SHOWN ARE BASED ON THE BEST INFORMATION AVAILABLE BUT NO GUARANTEE IS GIVEN THAT ALL EXISTING UTILITIES ARE SHOWN OR THAT THE GIVEN LOCATIONS ARE EXACT CONFIRMATION OF EXISTENCE AND EXACT LOCATION OF ALL SERVICES MUST BE OBTAINED FROM THE INDIVIDUAL UTILITIES BEFORE PROCEEDING

G.B.M. IRON BAR IN NORTHEAST CORNER OF MUNROE AVE AND WATT ST INTERSECTION 230.276
ELEV. 230.276



WSP Canada Inc.
Suite 111 - 93 Lombard Ave
Winnipeg, MB R3B 3B1
t. 204.943.3178
f. 204.943.4948
www.wsp.com

ENGINEER'S SEAL

SIGNED BY:

DATE:

SUPV U/G STRUCTURES

DATE:

DESIGNED BY: VM

CHECKED BY: KG

DRAWN BY: SB/RB

APPROVED BY: VM

NO. REVISIONS

DATE

DATE

DATE

CONSULTANT ACAD DWG. NO. 19M-00985-00-103

Winnipeg THE CITY OF WINNIPEG
PUBLIC WORKS DEPARTMENT
ENGINEERING SERVICES DIVISION

2021/2022 MUNROE AVENUE PAVEMENT RENEWAL

MUNROE AVENUE HORIZONTAL GEOMETRY STA. 7+90 TO STA. 11+15

CITY DRAWING NUMBER: P-3522-03

SHEET 03 OF 18

BID NO. 917-2020