

CONSTRUCTION NOTES:

- PROJECT SCOPE**
1. INSTALL CONDUIT, BASES AND PITS AS SHOWN.
 2. INSTALL SERVICE AND GROUND ROD ON WOOD POLE #10 AS SHOWN. INSTALL MAST AND DISCONNECT ON XX QUADRANT. INSTALL WEATHER HEAD 150mm LOWER THAN THE LOWEST HYDRO WIRE. REMOVE EXISTING SERVICE FROM WOOD POLE #E10. TOTAL LENGTH OF SERVICE CABLE: 75m.
 3. INSTALL EQUIPMENT AS SHOWN.
 4. TIMINGS REQUIRED.

- PROJECT COORDINATION**
1. COORDINATE WORK WITH (CA'S NAME), (204) XXX-XXXX.
 2. COORDINATE HYDRO SERVICE INSTALLATION WITH (HYDRO DESIGNER), (204) XXX-XXXX. RE: JUTA PERMIT No. BXXXXX

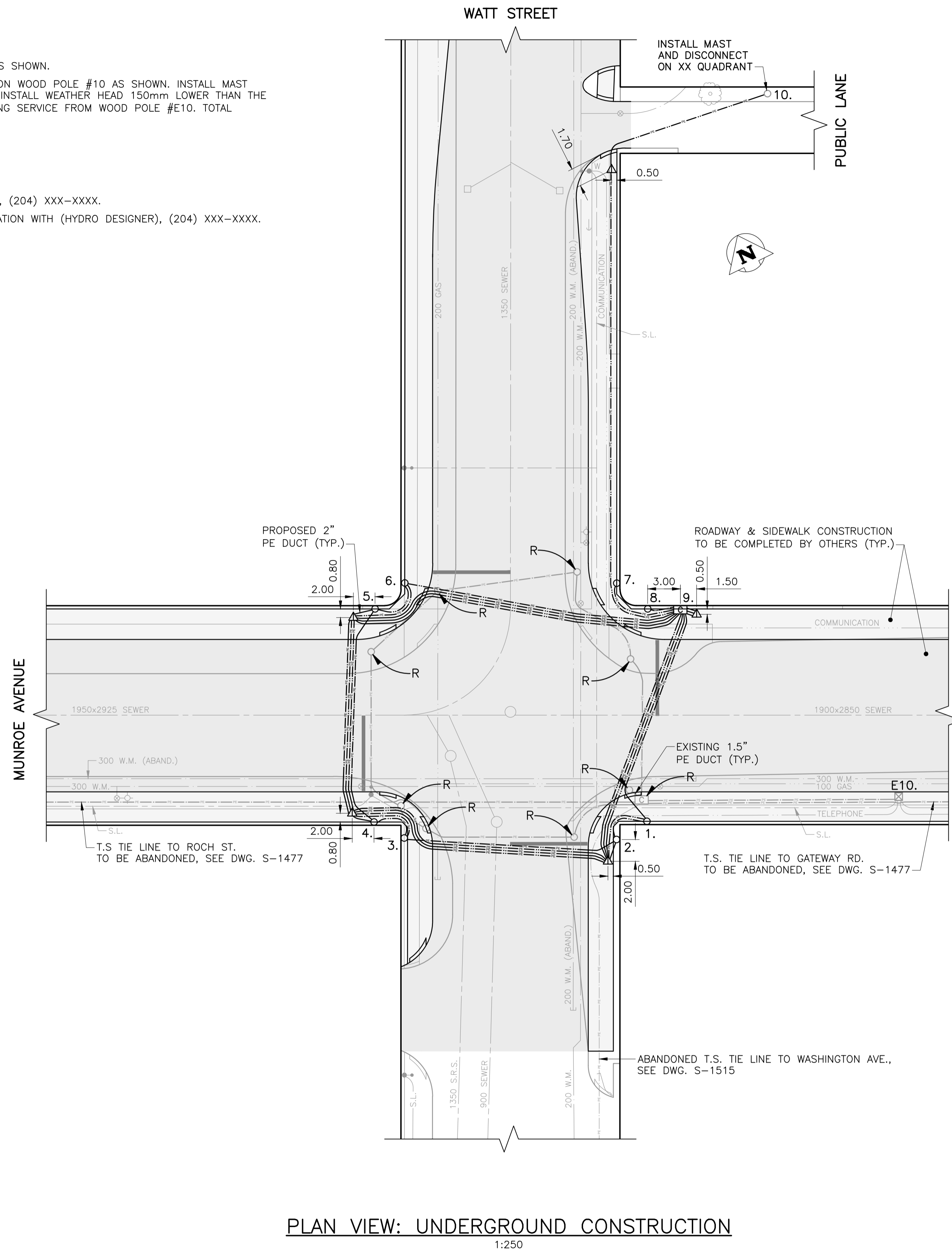

PLAN VIEW: UNDERGROUND CONSTRUCTION
1:250

INTERNAL REVIEW			
OPERATIONS:	DATE	INITIALS	
TIMINGS (INITIAL):	DATE	INITIALS	
TIMINGS (PRE-FC):	DATE	INITIALS	
TMC:	DATE	INITIALS	
STREET LIGHTING:	DATE	INITIALS	
TRAFFIC MANAGEMENT:	DATE	INITIALS	
FACILITIES PLANNING:	DATE	INITIALS	

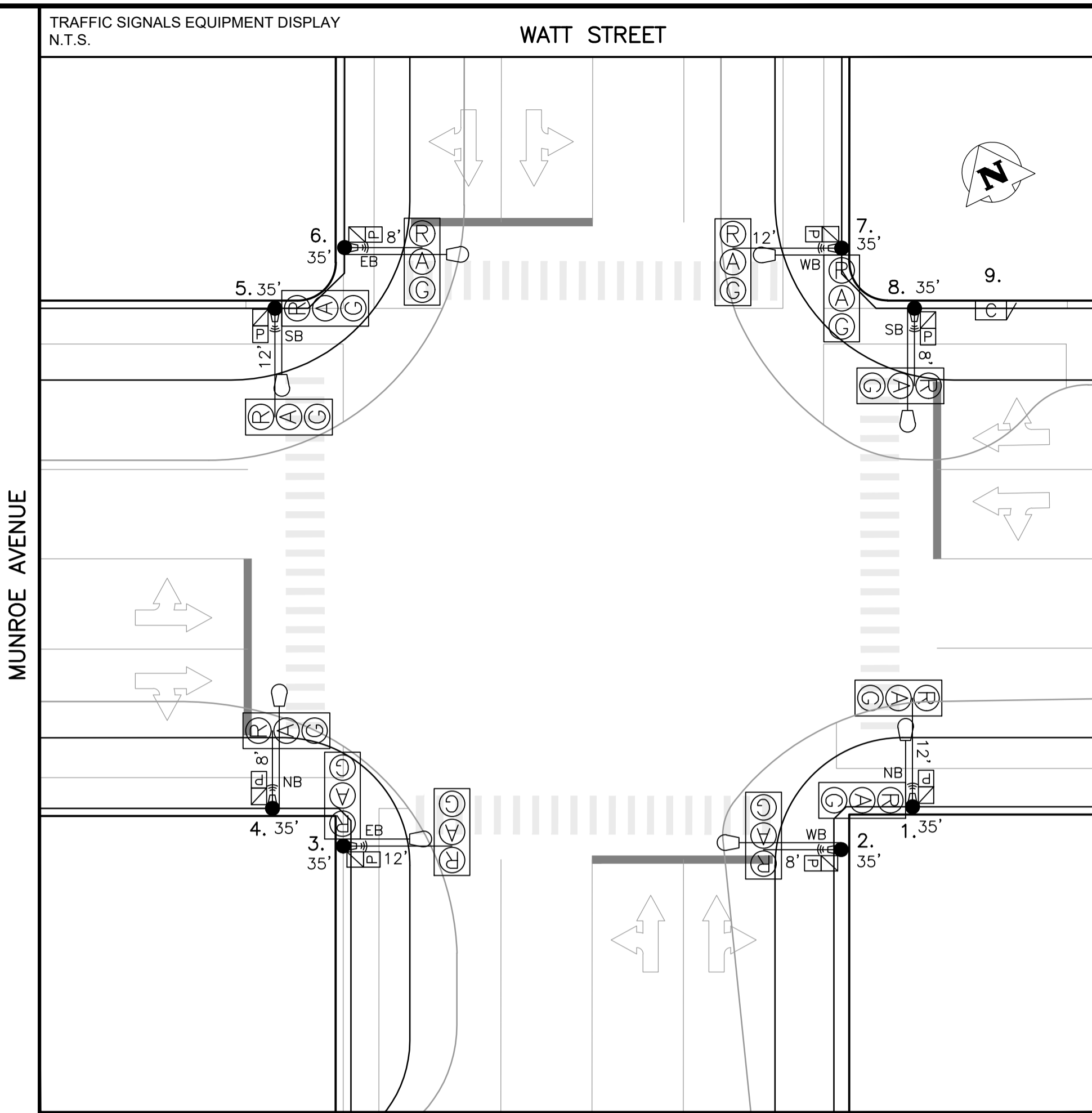

EQUIPMENT DISPLAY LEGEND			
	EXISTING		PROPOSED (AS SHOWN BELOW)

NO.	EQUIPMENT LIST	ARM	BASE	B.B.	NO.	EQUIPMENT LIST	ARM	BASE	B.B.
1.	35' SIGNAL FOR XX WATT (XXXX LUMEN) LUMINAIRE	12'	OD	DD	8.	35' SIGNAL FOR XX WATT (XXXX LUMEN) LUMINAIRE	8'	OD	DD
2.	35' SIGNAL FOR XX WATT (XXXX LUMEN) LUMINAIRE	8'	OD	DD	9.	332 CABINET/2070 CONTROLLER			
3.	35' SIGNAL FOR XX WATT (XXXX LUMEN) LUMINAIRE	12'	OD	DD	10.	HYDRO WOOD SERVICE:			
4.	35' SIGNAL FOR XX WATT (XXXX LUMEN) LUMINAIRE	8'	OD	DD	E10.	HYDRO PEDESTAL SERVICE (TO BE REMOVED)			
5.	35' SIGNAL FOR XX WATT (XXXX LUMEN) LUMINAIRE	12'	OD	DD					
6.	35' SIGNAL FOR XX WATT (XXXX LUMEN) LUMINAIRE	8'	OD	DD					
7.	35' SIGNAL FOR XX WATT (XXXX LUMEN) LUMINAIRE	12'	OD	DD					

TRAFFIC SIGNALS UNDERGROUND LEGEND				SIGNAL BASE BOLT SQUARE TYPES	
	EXISTING		PROPOSED (AS SHOWN BELOW)		TYPE "A" - 8 1/8"
	ABANDONED		DISCONNECTED (LOOPS ONLY)		TYPE "B" - 6 3/4"
					TYPE "C" - 8 1/8" SCREW TYPE
					TYPE "D" - 12 3/4", 1 1/4" DIA. BOLTS, 24" DIA.
					TYPE "E" - 12 3/4", 1 1/4" DIA. BOLTS, 28" DIA.
					TYPE "F" - 9 9/16" SCREW TYPE
					TYPE "G" - 8 1/8", 1 1/4" DIA. BOLTS, 89mm PROJ.
					TYPE "H" - 10 5/8", 1 1/4" DIA. BOLTS, 76mm PROJ.
					TYPE "I" - 7 3/4"
					TYPE "J" - 10 5/8", 1 1/4" DIA. BOLTS
					TYPE "K" - 10 5/8", PRECAST, 1 1/4" DIA. BOLTS
					TYPE "L" - 6", 5/8" DIA. BOLTS
					TYPE "M" - 8 1/8", PRECAST, 5/8" DIA. BOLTS

V:\Staff\Projects\2014\14-0000\14-0000-0000\14-0000-0000-0000.dwg

EXISTING	LEGEND	PROPOSED	EXISTING	LEGEND	PROPOSED	EXISTING	LEGEND	PROPOSED
	WATERMAIN			ROADWAY			TELEPHONE	
	VALVE			SIDEWALK			WOOD POLE	
	SEWER			CURB & CURB RAMP			STREET LIGHT	
	MANHOLE			WARNING TILE			BANNER POLE	
	CATCH BASIN			SLOPE			RAILWAY POLE	
	CURB INLET			CULVERT			GUY-WIRE	
	HYDRO			BUILDING			FENCE	
	GAS			TREE			GUARDRAIL	

UNDERGROUND STRUCTURES	
UNDERGROUND STRUCTURES ID	DATE (YYYYMMDD)
WATER & WASTE REVIEW ID	

CONSTRUCTION REVISIONS			
NO.	REVISION	DATE (YYYYMMDD)	BY
A	ISSUED FOR INTERNAL REVIEW		

DESIGNED BY	R.S.
DRAWN BY	R.S.
CHECKED BY	
APPROVED BY	

ACCOUNTS: WT PENDING

ENGINEER'S SEAL: PRELIMINARY NOT FOR CONSTRUCTION

THE CITY OF WINNIPEG
PUBLIC WORKS DEPARTMENT
TRANSPORTATION DIVISION

TRAFFIC SIGNALS
MUNROE AVE. & WATT ST.

UNITS: ALL DIMENSIONS ARE IN METERS UNLESS OTHERWISE NOTED

DRAWING NUMBER: S-1496