

ALLEY PAVEMENT PROFILE
SCALE: 1:250 HOR
1:10 VERT

- NOTES:**
1. ALL WORK AND MATERIALS TO BE IN ACCORDANCE WITH THE LATEST REVISION OF THE CITY OF WINNIPEG STANDARD CONSTRUCTION SPECIFICATION.
 2. CONTRACTOR TO CONFIRM THE LOCATION OF ALL UTILITIES/SERVICES IN THE FIELD PRIOR TO CONSTRUCTION.
 3. CONTRACTOR TO AVOID DAMAGE TO EXISTING TREES WITHIN THE LIMITS OF THE ALLEY RIGHT OF WAY AS OUTLINED IN THE BID OPPORTUNITY.
 4. HYDRO POLES AND ANCHORS REQUIRING TEMPORARY SUPPORT TO BE DONE AT THE EXPENSE OF THE CONTRACTOR AS REQUIRED.
 5. WHERE UNSTABLE SUB-GRADES ARE ENCOUNTERED, ADDITIONAL EXCAVATION/SUB-BASE AND INSTALLATION OF GEOGRID TO BE DETERMINED BY THE CONTRACT ADMINISTRATOR AND CONSTRUCTED IN ACCORDANCE W/ CW-3110.
 6. PROPOSED ELEVATIONS GIVEN ARE FOR EDGE OF PAVEMENT.
 7. ISOLATE EXISTING HYDRO POLES AS PER SD-228C.
 8. RENEW CURB AND SIDEWALK AS DIRECTED BY THE CONTRACT ADMINISTRATOR.
 9. MODIFIED BARRIER CURBS TO BE CONSTRUCTED AT ALL BACK LANE RADI.
 10. ALL EXISTING PRIVATE APPROACHES TO BE RENEWED AS DIRECTED BY THE CONTRACT ADMINISTRATOR.
 11. ADJUSTMENTS TO PROPOSED CROSSFALL, WHERE REQUIRED, ARE TO BE DETERMINED BY THE CONTRACT ADMINISTRATOR TO SUIT EXISTING DRIVEWAYS, APPROACHES, ETC.
 12. ALL BOULEVARD RESTORATION TO BE SODDED UNLESS OTHERWISE NOTED.
 13. INSTALLATION OF LIP CURBS AND THEIR LIMITS THROUGH PRIVATE APPROACHES TO BE DETERMINED BY THE CONTRACT ADMINISTRATOR.
 14. REMOVE, ADJUST, AND SUPPLY PRECAST SIDEWALK BLOCKS AS DIRECTED BY THE CONTRACT ADMINISTRATOR.

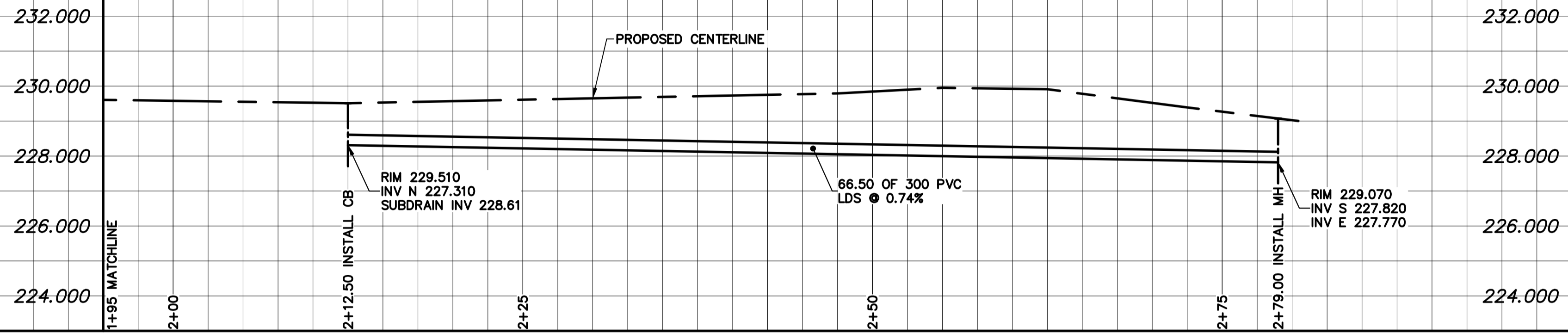

LAND DRAINAGE SEWER PROFILE
SCALE: 1:250 HOR
1:100 VERT

NOTE: CHAINAGES SHOWN ARE ALONG CL OF RIGHT-OF-WAY

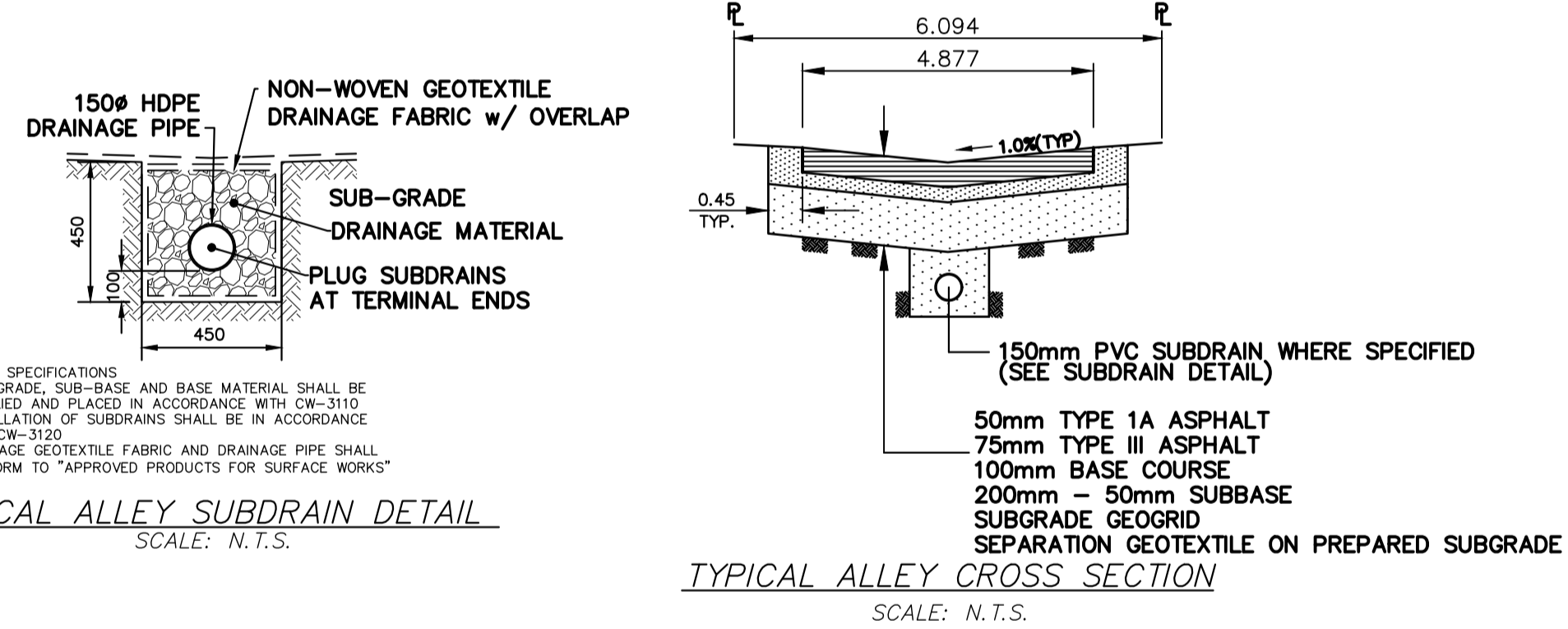
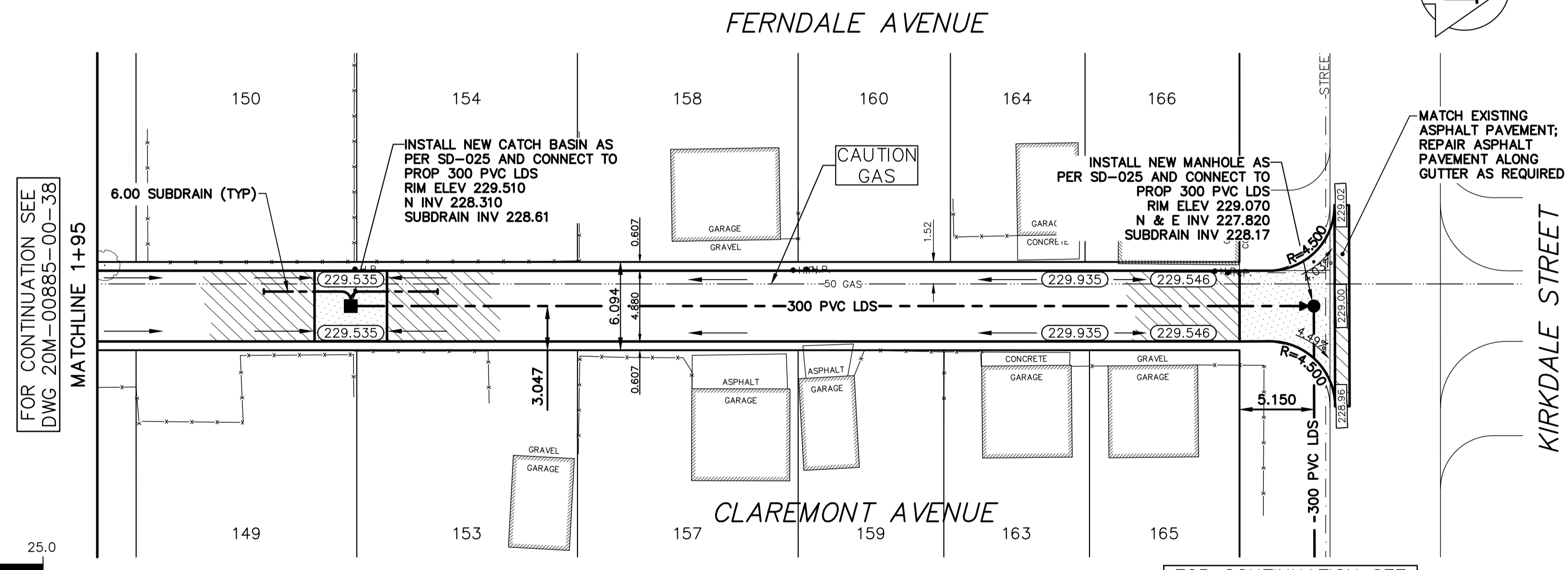

REFERENCE SPECIFICATIONS
1. SUB-GRADE, SUB-BASE AND BASE MATERIAL SHALL BE SUPPLIED AND PLACED IN ACCORDANCE WITH CW-3110
2. INSTALLATION OF SUBDRAINS SHALL BE IN ACCORDANCE WITH CW-3120
3. DRAINAGE GEOTEXTILE FABRIC AND DRAINAGE PIPE SHALL CONFORM TO "APPROVED PRODUCTS FOR SURFACE WORKS"

TYPICAL ALLEY SUBDRAIN DETAIL
SCALE: N.T.S.

TYPICAL ALLEY CROSS SECTION
SCALE: N.T.S.

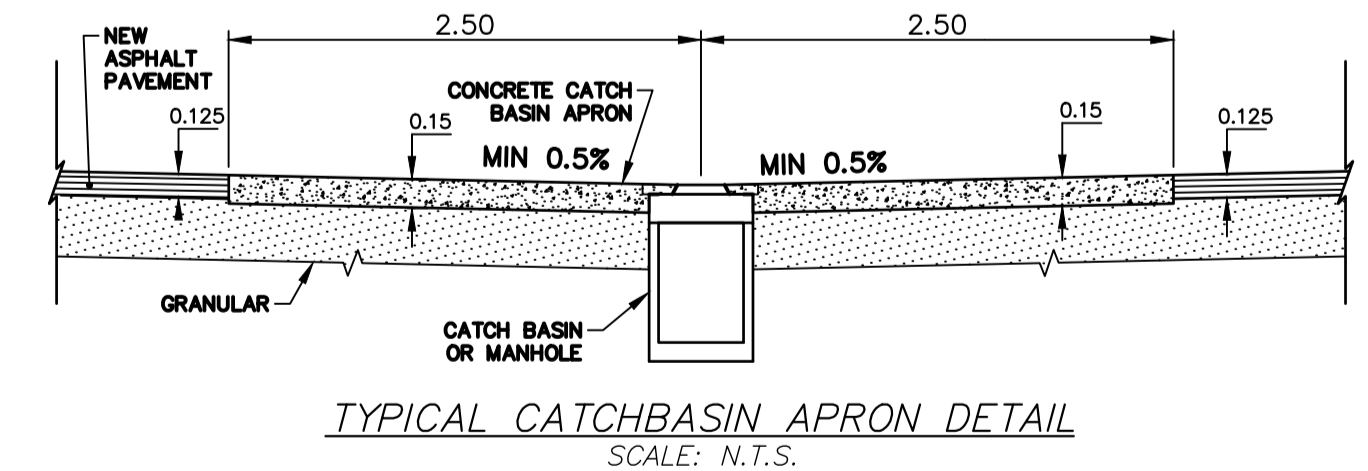

TYPICAL CATCHBASIN APRON DETAIL
SCALE: N.T.S.

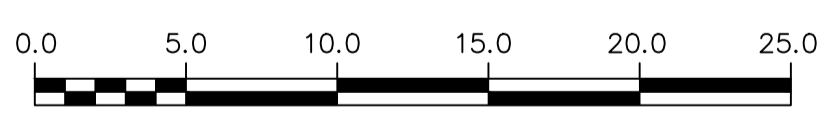

METRIC
WHOLE NUMBERS INDICATE MILLIMETRES
DECIMALIZED NUMBERS INDICATE METRES
UNLESS OTHERWISE NOTED

FOR CONTINUATION SEE DWG 20M-00885-00-40

FOR TENDER PURPOSES ONLY
NOT FOR CONSTRUCTION

ENGINEERS GEOSCIENTISTS MANITOBA
Certificate of Authorization
WSP Canada Inc.
No. 5750

WATERMAIN	M.T.S.	150 MM	WATERMAIN	150 MM
HYDRANT	CONCRETE/ASPHALT	300 LDS	VALVE	300 LDS
VALVE	SIDEWALK	290 WWS	LAND DRAINAGE SEWER	300 LDS
CURB STOP	CURB RAMP	(232.00)	WASTE WATER SEWER	250 WWS
LAND DRAINAGE SEWER	ELEVATIONS	(232.00)	CENTERLINE	
WASTE WATER SEWER	PROPERTY LINE		SOUTH & EAST GUTTER	
CB LEAD	SURVEY BAR		NORTH & WEST GUTTER	
MANHOLE	HYDRO POLE		S & E GARAGE PAD	
CATCH BASIN	STREET LIGHT		N & W GARAGE PAD	
GAS	JOINTS			
HYDRO	ASPHALT REPAIR			
EXISTING	LEGEND - PLAN	PROPOSED	EXISTING	LEGEND - PROFILE
			PROPOSED	

LOCATION APPROVED UNDERGROUND STRUCTURES	B.M. ELEV.
SUPV. U/G STRUCTURES COMMITTEE	DATE
NOTE:	
LOCATION OF UNDERGROUND STRUCTURES AS SHOWN ARE BASED ON THE BEST INFORMATION AVAILABLE BUT NO GUARANTEE IS GIVEN THAT ALL EXISTING UTILITIES ARE SHOWN OR THAT THE GIVEN LOCATIONS ARE EXACT. CONFIRMATION OF EXISTENCE AND EXACT LOCATION OF ALL SERVICES MUST BE OBTAINED FROM THE INDIVIDUAL UTILITIES BEFORE PROCEEDING WITH CONSTRUCTION.	
NO	REVISIONS

DESIGNED BY	A.B.	CHECKED BY	R.H.
DRAWN BY	D.R.	APPROVED BY	S.M.
HOR. SCALE:	1:250	RELEASED FOR CONSTRUCTION	
VERT. SCALE:	AS SHOWN		
DATE	DECEMBER 2020		

WSP Canada Incorporated Suite 111 - 93 Lombard Ave Winnipeg, MB R3B 3B1 t. 204.943.3178 f. 204.943.4948 www.wsp.com
NOT FOR CONSTRUCTION
CONSULTANT DRAWING NO. 20M-00885-00-39

THE CITY OF WINNIPEG
PUBLIC WORKS DEPARTMENT

2021 ALLEY RENEWALS
FERDALE AVE / CLAREMONT AVE ALLEY
FROM STA 1+95 TO KIRDALE STREET

CITY DRAWING NO.
LD-
SHEET 2 OF 3

BID OPPORTUNITY
17-2021

ASPHALT PAVEMENT