

CHELSEA AVENUE

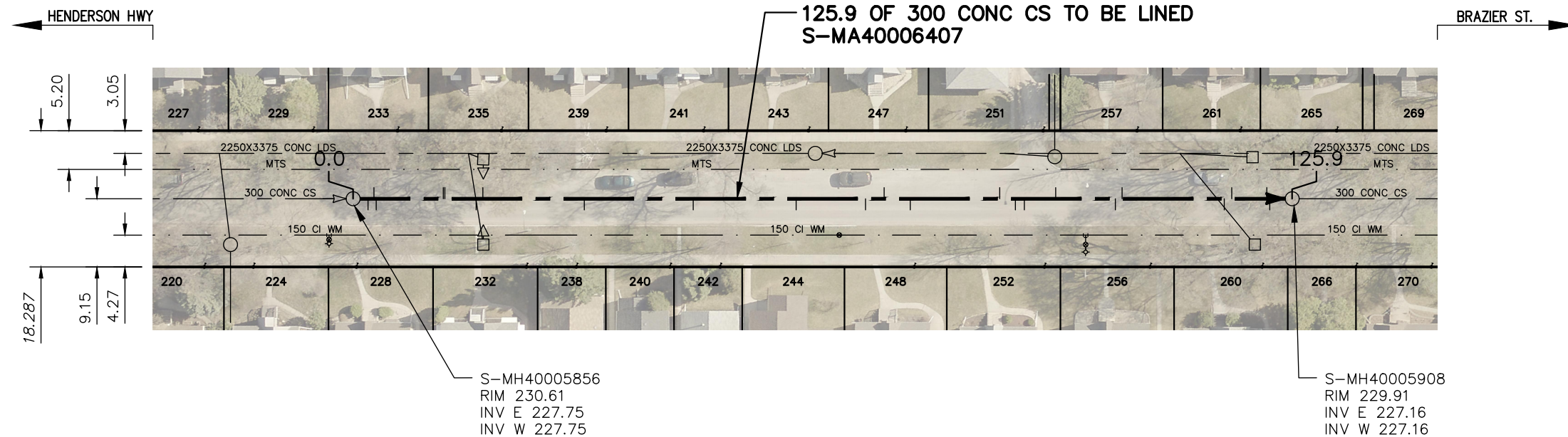
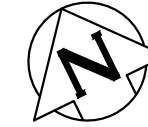

SEWER JUNCTION INFORMATION FROM SEWER VIDEO INSPECTION		
SEWER ID S-MA40006407		
DISTANCE FROM MH ID S-MH40005856		
DISTANCE	DIAMETER	CLOCK
2.0	150	10
2.8	150	1
3.1	150	10
12.1	150	1
12.3	150	1
16.5	150	10
17.4	150	3
31.0	150	10
45.6	150	10
59.4	150	10
68.7	150	11
71.2	150	2
74.7	250	11
86.7	150	1
88.8	150	10
90.0	150	10
94.2	150	1
102.2	150	10
103.1	150	2
116.8	150	10
117.8	150	2
122.5	150	2
122.9	150	11

WARNING

IF POWER EQUIPMENT OR EXPLOSIVES ARE TO BE USED FOR EXCAVATION ON THIS PROJECT THE CONTRACTOR MUST:

- 1) NOTIFY THE GAS COMPANY OF THE PROPOSED LOCATION OF EXCAVATION.
- 2) TAKE PRECAUTION TO AVOID DAMAGE TO GAS COMPANY INSTALLATIONS.

SEE PROVINCIAL REGULATION 210/72 FOR DETAILS

FOR INDEX SEE 12674

METRIC

WHOLE NUMBERS INDICATE MILLIMETRES
DECIMALIZED NUMBERS INDICATE METRES

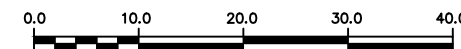

LOCATION APPROVED UNDERGROUND STRUCTURES

B.M. ELEV.

SUPV. U/G STRUCTURES COMMITTEE DATE

NOTE:

LOCATION OF UNDERGROUND STRUCTURES AS SHOWN ARE BASED ON THE BEST INFORMATION AVAILABLE BUT NO GUARANTEE IS GIVEN THAT ALL EXISTING UTILITIES ARE SHOWN OR THAT THE GIVEN LOCATIONS ARE EXACT. CONFIRMATION OF EXISTENCE AND EXACT LOCATION OF ALL SERVICES MUST BE OBTAINED FROM THE INDIVIDUAL UTILITIES BEFORE PROCEEDING WITH CONSTRUCTION.

NO.	REVISIONS	DATE	BY

DESIGNED BY	SC	CHECKED BY	SC
DRAWN BY	AJ	APPROVED BY	KZ
SCALE:		RELEASED FOR CONSTRUCTION	
HORIZONTAL	1:750	K.ZUREK	
VERTICAL			
DATE	2021 04 16	DATE	2021-04-16

ENGINEER'S SEAL

ORIGINAL SIGNED BY
S.R.J. COURNOYER
2021/04/16

CONSULTANT DRAWING NUMBER
-



THE CITY OF WINNIPEG

WATER AND WASTE DEPARTMENT
ENGINEERING DIVISION

2021 SEWER RENEWALS BY CIPP LINING
CONTRACT No.9
CHELSEA AVENUE
1ST MH E OF HENDERSON HIGHWAY TO
TO 2ND MH E OF HENDERSON HIGHWAY

SHEET 17 OF 57
CITY DRAWING NUMBER
12690

PLOT DATE: 2021 04 16

BID OPPORTUNITY: 218-2021
CONTRACT NUMBER: 9

FILE PATH: R:\DRAWINGS\SEWER\2021 RENEWALS\CIPP LINING\CONTRACT #9\Construction Dwg\
FILE NAME: CHELSEA AVE.dwg