

# NEWMAN AVENUE EAST

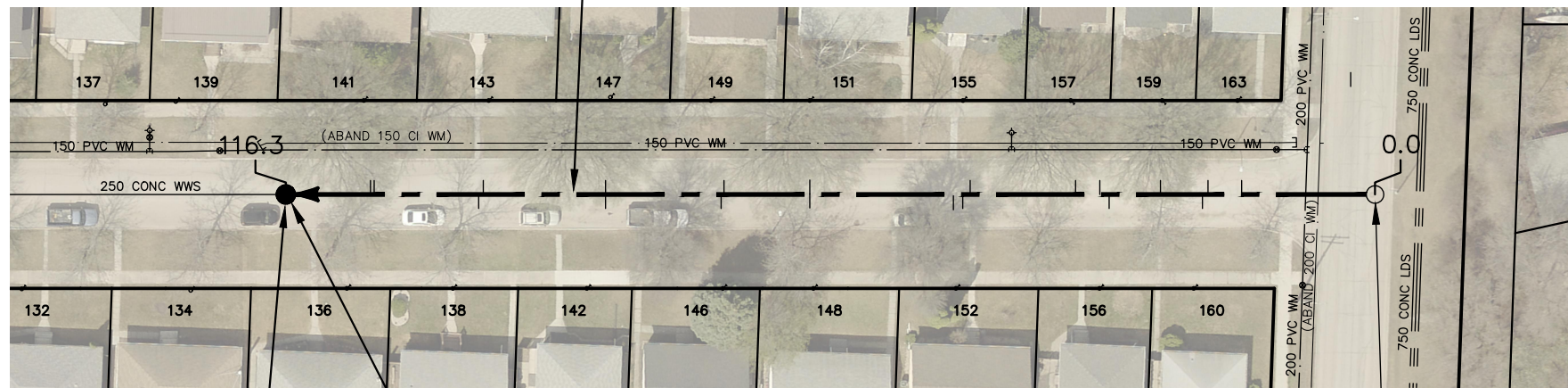

WABASHA ST

116.3 OF 250 CONC WWS TO BE LINED  
S-MA40014144



REPLACE MANHOLE  
FRAME AND COVER

S-MH40012779  
RIM 233.23  
INV E 229.47  
INV W 229.47

S-MH40012780  
RIM 233.27  
INV W 229.82

SEWER JUNCTION INFORMATION FROM SEWER VIDEO INSPECTION		
SEWER ID S-MA40014144		
DISTANCE FROM MH ID S-MH40012780		
DISTANCE	DIAMETER	CLOCK
14.3	150	2
17.9	150	2
18.5	150	10
23.0	150	2
28.5	150	10
29.5	150	1
32.1	150	1
43.4	150	2
44.2	150	10
45.2	150	10
60.6	150	2
60.6	150	10
69.8	150	2
70.1	150	10
82.5	150	11
82.5	150	2
95.6	150	2
96.1	150	10
107.3	150	1
107.7	150	11

## WARNING

IF POWER EQUIPMENT OR EXPLOSIVES ARE TO BE USED FOR EXCAVATION ON THIS PROJECT THE CONTRACTOR MUST:

- 1) NOTIFY THE GAS COMPANY OF THE PROPOSED LOCATION OF EXCAVATION.
- 2) TAKE PRECAUTION TO AVOID DAMAGE TO GAS COMPANY INSTALLATIONS.

SEE PROVINCIAL REGULATION 210/72 FOR DETAILS

FOR INDEX SEE  
12674

## METRIC

WHOLE NUMBERS INDICATE MILLIMETRES  
DECIMALIZED NUMBERS INDICATE METRES



LOCATION APPROVED  
UNDERGROUND STRUCTURES

B.M.  
ELEV.

SUPV. U/G STRUCTURES COMMITTEE DATE

NOTE:

LOCATION OF UNDERGROUND STRUCTURES AS SHOWN ARE BASED ON THE BEST INFORMATION AVAILABLE BUT NO GUARANTEE IS GIVEN THAT ALL EXISTING UTILITIES ARE SHOWN OR THAT THE GIVEN LOCATIONS ARE EXACT. CONFIRMATION OF EXISTENCE AND EXACT LOCATION OF ALL SERVICES MUST BE OBTAINED FROM THE INDIVIDUAL UTILITIES BEFORE PROCEEDING WITH CONSTRUCTION.

NO.	REVISIONS	DATE	BY

DESIGNED BY	SC	CHECKED BY	SC
DRAWN BY	AJ	APPROVED BY	KZ
SCALE:		RELEASED FOR CONSTRUCTION	
HORIZONTAL	1:750	<b>K.ZUREK</b>	
VERTICAL		DATE	2021-04-16
PLOT DATE: 2021 04 16		DATE	

ENGINEER'S SEAL

ORIGINAL  
SIGNED BY  
**S.R.J. COURNOYER**  
2021/04/16

CONSULTANT DRAWING NUMBER



**THE CITY OF WINNIPEG**  
WATER AND WASTE DEPARTMENT  
ENGINEERING DIVISION

2021 SEWER RENEWALS BY CIPP LINING  
CONTRACT No.9

**NEWMAN AVENUE EAST**  
MH AT WABASHA STREET TO  
1ST MH W OF WABASHA STREET

SHEET **44** OF **57**  
CITY DRAWING NUMBER

**12719**