

SEWER JUNCTION INFORMATION FROM SEWER VIDEO INSPECTION		
SEWER ID S-MA70097036		
DISTANCE FROM MH ID S-MH70046116		
DISTANCE	DIAMETER	CLOCK
3.3	150	2
3.6	150	3
18.2	150	11
18.8	150	3
22.0	100	2
28.3	150	3
39.9	150	10
50.5	150	2
50.5	150	10
51.3	150	3
65.0	150	10
67.5	150	3
67.8	150	2
79.7	150	2
81.4	100	9
86.0	150	8
99.8	150	9
101.4	150	3
105.2	150	2
113.0	150	9

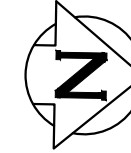

SPEERS ROAD

WINAKWA RD

BETOURNAY ST

119.8 OF 200 WWS TO BE LINED
S-MA70097036

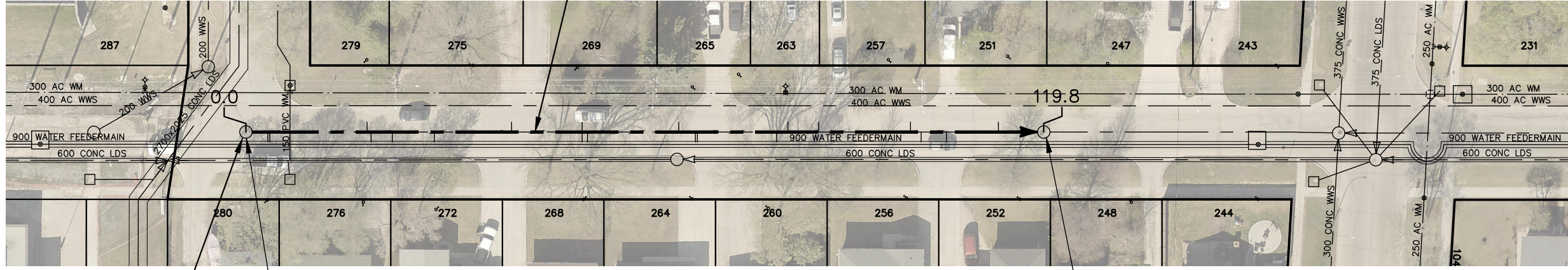

S-MH70046116
RIM 232.20
INV N 229.25

S-MH70046115
RIM 232.23
INV N 228.64
INV S 228.64

REPLACE RISERS 0-0.6
GROUT HOLE AT 1.2

WARNING

IF POWER EQUIPMENT OR EXPLOSIVES ARE TO BE USED FOR EXCAVATION ON THIS PROJECT THE CONTRACTOR MUST:

- 1) NOTIFY THE GAS COMPANY OF THE PROPOSED LOCATION OF EXCAVATION.
- 2) TAKE PRECAUTION TO AVOID DAMAGE TO GAS COMPANY INSTALLATIONS.

SEE PROVINCIAL REGULATION 210/72 FOR DETAILS

FOR INDEX SEE
12674

METRIC

WHOLE NUMBERS INDICATE MILLIMETRES
DECIMALIZED NUMBERS INDICATE METRES



LOCATION APPROVED UNDERGROUND STRUCTURES SUPV. U/G STRUCTURES COMMITTEE _____ DATE _____ NOTE: LOCATION OF UNDERGROUND STRUCTURES AS SHOWN ARE BASED ON THE BEST INFORMATION AVAILABLE BUT NO GUARANTEE IS GIVEN THAT ALL EXISTING UTILITIES ARE SHOWN OR THAT THE GIVEN LOCATIONS ARE EXACT. CONFIRMATION OF EXISTENCE AND EXACT LOCATION OF ALL SERVICES MUST BE OBTAINED FROM THE INDIVIDUAL UTILITIES BEFORE PROCEEDING WITH CONSTRUCTION.	B.M. ELEV.			ENGINEER'S SEAL ORIGINAL SIGNED BY S.R.J. COURNOYER 2021/04/16		THE CITY OF WINNIPEG WATER AND WASTE DEPARTMENT ENGINEERING DIVISION	
	DESIGNED BY SC CHECKED BY SC DRAWN BY AJ APPROVED BY KZ SCALE: HORIZONTAL 1:750 VERTICAL K.ZUREK DATE 2021-04-16			RELEASED FOR CONSTRUCTION DATE 2021-04-16		2021 SEWER RENEWALS BY CIPP LINING CONTRACT No.9 SPEERS ROAD MH AT WINAKWA ROAD TO 1ST MH S OF BETOURNAY STREET	
NO. REVISIONS DATE BY			PLOT DATE: 2021 04 16		SHEET 49 OF 57 CITY DRAWING NUMBER 12724		