

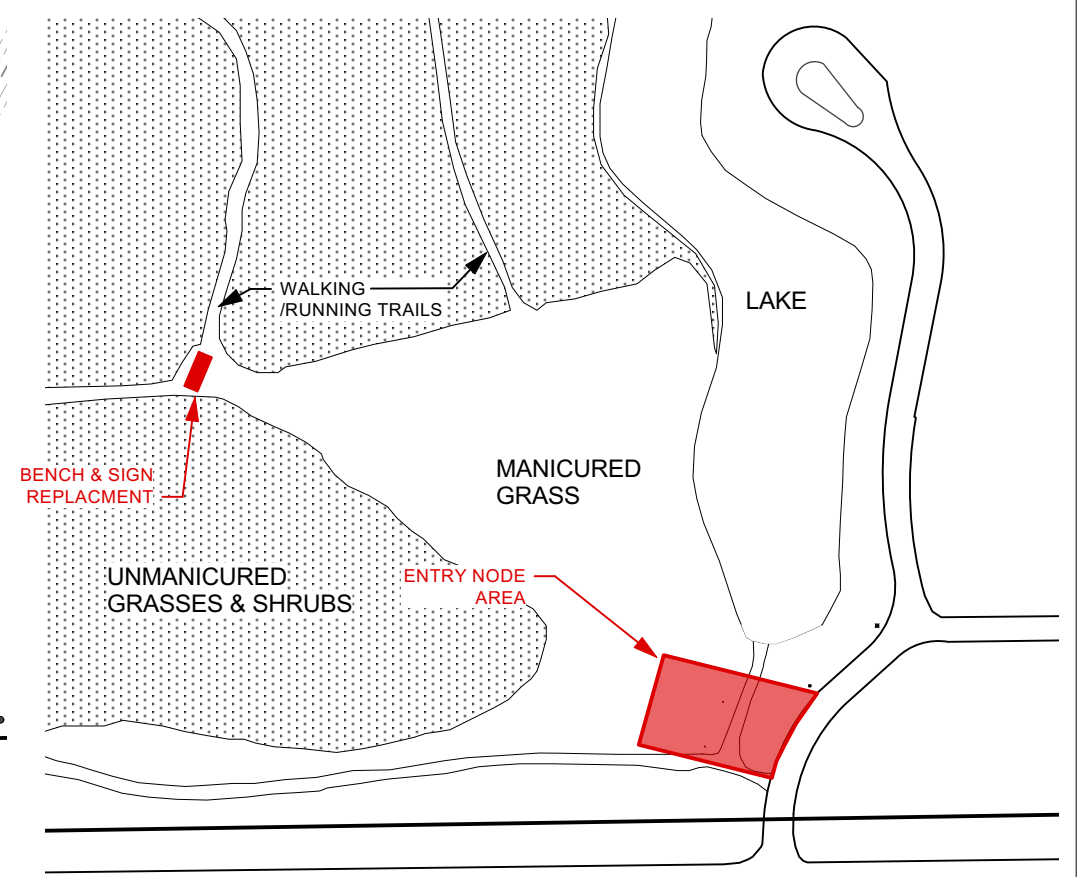

CONTEXT PLAN  
NTS



PROJECT EXTENTS  
NTS

CONTRACTOR TO CONFIRM ALL DIMENSIONS AND REPORT ANY DISCREPANCIES TO CONTRACT ADMINISTRATOR PRIOR TO CONSTRUCTION. LOCATION OF UNDERGROUND STRUCTURES AS SHOWN ARE BASED ON THE BEST INFORMATION AVAILABLE BUT NO GUARANTEE IS GIVEN THAT ALL EXISTING UTILITIES ARE SHOWN OR THAT THE GIVEN LOCATIONS ARE EXACT. CONFIRMATION OF EXISTENCE AND EXACT LOCATION OF ALL SERVICES MUST BE OBTAINED FROM THE INDIVIDUAL UTILITIES BEFORE PROCEEDING WITH CONSTRUCTION.



THE CITY OF WINNIPEG  
Planning, Property and Development Department  
Planning and Land Use Division  
Unit 15 - 30 Fort Street, Winnipeg, MB, (R3C 4X5)

DESIGNED BY	IL	CHECKED BY	
DRAWN BY	IL	APPROVED BY	
HORIZ. SCALE			
VERT. SCALE	1:200		
DATE	APRIL 2021		

MANAGER, PARK AND OPEN SPACES	DATE
MANAGER, PLANNING AND LAND USE DIVISION	DATE

DRAWING TITLE <b>KILCONA PARK</b> <b>Chris McCubbins Trail Entry Node</b> <b>Existing Conditions</b>
SITE ADDRESS 1867 Springfield Road

DRAWING NO. <b>K.7-1</b>
BID OPPORTUNITY NO. <b>246-2021</b>