

**NOTES**

1. DIMENSIONS ARE IN METRES
2. DIMENSIONS FOR TIMBER EDGING ARE TO OUTSIDE OF EDGING
3. DIMENSIONS IN GREEN ARE RELATIVE TO 10m OFFSET FROM SOUTH END OF CITY SIDEWALK
4. CONTRACTOR TO VERIFY DIMENSIONS AND CONFORMANCE OF SWING AND PLAY EQUIPMENT SAFETY ZONES AND REPORT ANY DISCREPANCIES TO CONTRACT ADMINISTRATOR
5. IF USING OPTION OF CONCRETE EDGING, LAYOUT PLAN FOR CONCRETE WILL BE PROVIDED PRIOR BY CONTRACT ADMINISTRATOR PRIOR TO CONSTRUCTION

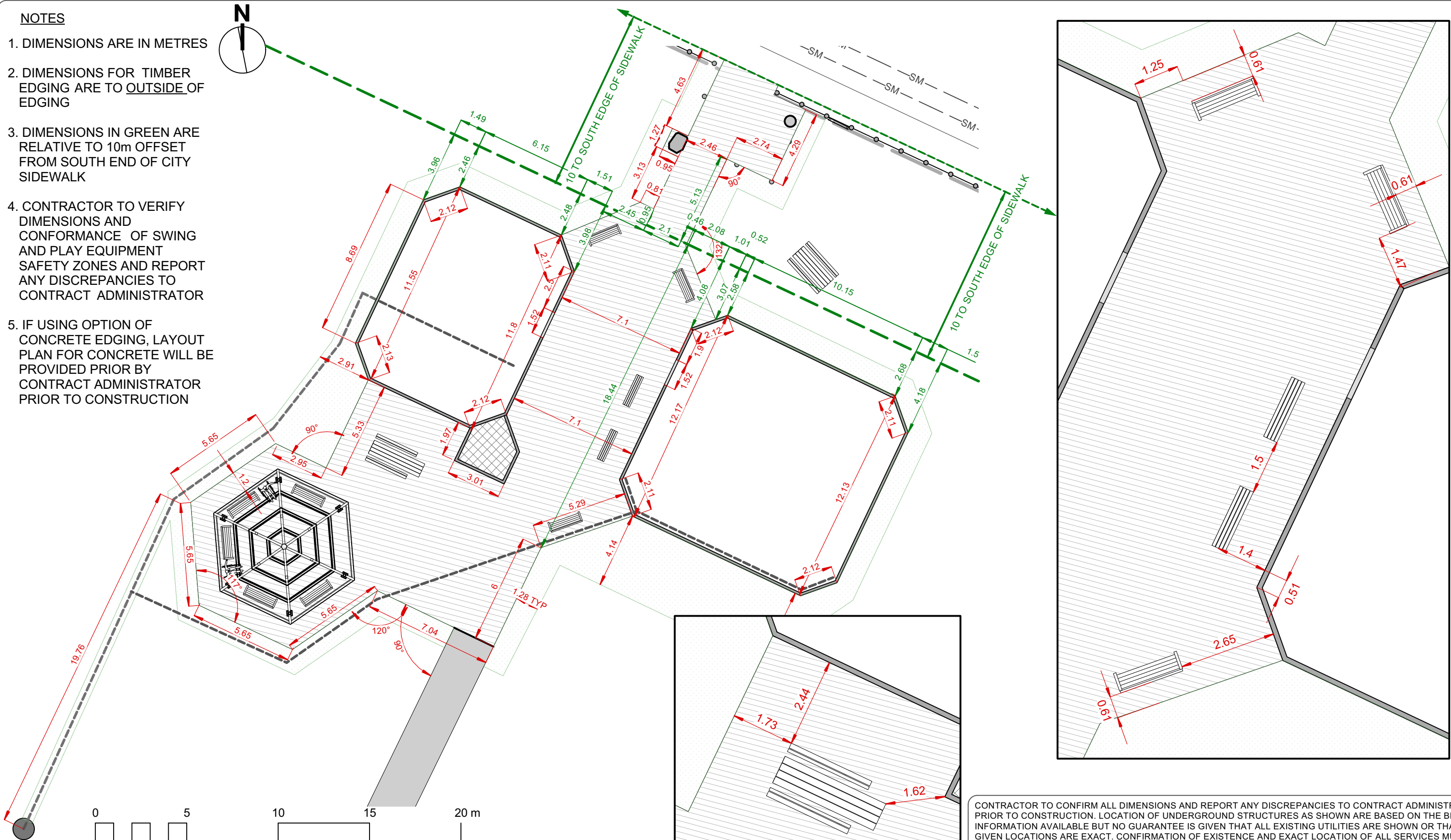

CONTRACTOR TO CONFIRM ALL DIMENSIONS AND REPORT ANY DISCREPANCIES TO CONTRACT ADMINISTRATOR PRIOR TO CONSTRUCTION. LOCATION OF UNDERGROUND STRUCTURES AS SHOWN ARE BASED ON THE BEST INFORMATION AVAILABLE BUT NO GUARANTEE IS GIVEN THAT ALL EXISTING UTILITIES ARE SHOWN OR THAT THE GIVEN LOCATIONS ARE EXACT. CONFIRMATION OF EXISTENCE AND EXACT LOCATION OF ALL SERVICES MUST BE OBTAINED FROM THE INDIVIDUAL UTILITIES BEFORE PROCEEDING WITH CONSTRUCTION.

 <p>THE CITY OF WINNIPEG Planning, Property and Development Department Planning and Land Use Division Unit 15 - 30 Fort Street, Winnipeg, MB, (R3C 4X5)</p>	DESIGNED BY	CHECKED BY	MANAGER, PARK AND OPEN SPACES		DRAWING TITLE	DRAWING NO. <b>T.043-4</b>  BID OPPORTUNITY NO. <b>338-2021</b>
	DRAWN BY	APPROVED BY	DATE	DATE	SITE ADDRESS	
	HORIZ. SCALE	1:200			840 Beecher Ave	
	VERT. SCALE					
DATE	April 2021		MANAGER, PLANNING AND LAND USE DIVISION	DATE		