

# ASBESTOS INVENTORY CONTROL



Planning, Property and Development Department  
 Municipal Accommodations Division  
 4th Floor - 185 King Street • Winnipeg, MB • R3B 1J1

<b>Building Name:</b>	Fire Station	<b>Inspection Date:</b>	October 28, 2021
<b>Building Code:</b>	FS-01	<b>Inspected By:</b>	Annette Brodbeck & Neal Richardson
<b>Building Address:</b>	65 Ellen Street	<b>Construction Date:</b>	1965

Material Location	Material Description	Drawing Label	Material Condition	Testing Status	Lab Report #	Date M/Y	Test %	Est. %
	Caution Concrete Block Walls contain vermiculite (ACM) - See Plan	VE					<1	
	Caution Exterior Perimeter Ceiling tiles may have vermiculite (ACM) debris on top of tiles						<1	
	Black mastic on Pipe Insulation contains asbestos						8	
<b>Main Floor</b>								
<b>Administration Area</b>								
Entrance	Decorative Brick Cement Board (Red/ Gray/ Gold)		Good	TESTED	248693	Jan/'21	0	
	Decorative Brick Cement Board (Red/ Gray/ Gold)		Good	TESTED	249394	Feb/'21	0	
Office Area	12x12 Floor Tile	F12	Good	TESTED	106761	Nov/'11	7	
	Floor Mastic (Tan)	MA	Good	TESTED	106761	Nov/'11	1	
Captain's Office	12x12 Floor Tile	F12	Good					7
Platoon Chief's Office	12x12 Floor Tile (same as Reception Area)	F12	Good	TESTED	257112	Jul'21	0	
	12 x 12 Ceiling Tile (2 Samples)	C12	Removed	TESTED	223180	July'19	0	
	Pipe Insulation (2 Samples)		Good	TESTED	228393	Oct'19	0	
	Black Mastic on Pipe Insulation (3 Samples)	MA	Good	TESTED	228393	Oct'19	8	
	Pipe Wrap (3 Samples)		Good	TESTED	228393	Oct'19	0	
	Exterior Wall - Insulation / Tar / Backing			TESTED	224339	Aug'19	0	
	Wallboard and Wallpaper			TESTED	224339	Aug,19	0	
	Drywall w/Covering (1 Sample )		Good	TESTED	248693	Jan/'21	0	
Control Room	12x12 Floor Tile (Red)	F12	Good	TESTED	106761	Nov/'11	0	
	Caulking - Interior Window	CA	Good	TESTED	257112	Jul'21	2	
	Caulking - Exterior Window	CA	Good	TESTED	257112	Jul'21	3	
	24x24 Ceiling Tile	C48	Good	TESTED	257112	Jul'21	0	
	Floor Mastic (Black)	MA	Good	TESTED	106761	Nov/'11	0	
Closet	12x12 Floor Tile	F12	Good					7
	Drywall Compound (1 Sample)	DC	Good	TESTED	248693	Jan/'21	0	

Material Location	Material Description	Drawing Label	Material Condition	Testing Status	Lab Report #	Date M/Y	Test %	Est. %
Computer Area	24x48 Ceiling Tile	C48	Good	TESTED	249394	Feb/'21	0	
	12x12 Floor Tile (Red)	F12	Good					0
	Concrete Block Mortar (Gray - 3 Samples)	MO	Good	TESTED	248693	Jan/'21	0	
	12x12 Ceiling Tile (above 2x4 tiles)	C12	Good	TESTED	249394	Feb/'21	0	
West Storage Room (Telephone Room)	12x12 Floor Tile	F12	Good					7
	12x12 Floor Tile	F12	Good	TESTED	249394	Feb/'21	0	
	Door Frame Lining		Needs Repair	TESTED	249394	Feb/'21	0	
	Vermiculite	VE	Good	TESTED	223180	Jul/'19	<1	
South Corridor	12x12 Floor Tile	F12	Good					7
Hallway (South corridor)	Drywall w/Covering (2 Samples )		Good	TESTED	248693	Jan/'21	0	
Men's Washroom	24x48 Ceiling Tile	C48	Good	TESTED	249394	Feb/'21	0	
	Terrazzo Flooring		Good	TESTED	249394	Feb/'21	0	
Office Lounge/Reception Area	12x12 Floor Tile	F12	Needs Repair	TESTED	257112	Jul'21	0	
	Drywall Compound	DC	Good	TESTED	192921	Oct'17	0	
	Drywall Compound (2 Samples)	DC	Good	TESTED	248693	Jan/'21	0	
EMS Superintendent's Office	12x12 Ceiling Tile	C12	Good	TESTED	313747	Sep'05	0	
<b>Dorm Area</b>								
Locker Rooms	12x12 Floor Tile - Under Carpet	F12	Good					
	Duct Insulation - Above Ceiling	DI	Good					
	Pipe Insulation Mastic	MA	Good					
	Pipe Fitting Insulation - Above Ceiling	PF	Good	TESTED	313747	Sep'05	1-5	
Storage Rm Wall (Locker Wall)	Wall Tile Grout - White (2 Samples)	GR	Good	TESTED	248693	Jan/'21	0	
	Pipe Insulation Mastic	MA	Good					
Storage Room	Pipe Fitting Insulation	PF	Good	TESTED	313747	Sep'05	1-5	
	Duct Insulation Mastic (error in 2011 s/b PF)	DI	Good	TESTED		Nov/'10	1-5	
	Pipe Fitting Insulation - Above Ceiling	PF	Good					
	Roof Drain insulation	RD	Good					
	Duct Insulation - Mastic	MA	Good	TESTED	b255650	Jul'21	0	
	Parging at Q-deck (3 samples)	PA	Good	TESTED	249394	Feb/'21	0	
	Grout	GR	Good	TESTED	249394	Feb/'21	0	
Hallway/Men's Room	Wall Tile Grout - White (1 Sample)	GR	Good	TESTED	248693	Jan/'21	0	
Men's Room	Pipe Insulation	MA	Good	TESTED	b255650	Jul'21	0	
	Brick Mortar	MO	Good	TESTED	249394	Feb/'21	0	
Pantry	Pipe Fitting Insulation - Above Ceiling	PF	Good					

Material Location	Material Description	Drawing Label	Material Condition	Testing Status	Lab Report #	Date M/Y	Test %	Est. %
	Drywall Compound (Wall - 1 Sample )	DC	Good	TESTED	248693	Jan/'21	0	
	Epoxy Flooring		Good	TESTED	249394	Feb/'21	0	
Lounge	Drywall Compound (Wall - 1 Sample )	DC	Good	TESTED	248693	Jan/'21	0	
Kitchen	Drywall Compound (South Wall - 1 Sample)	DC	Good	TESTED	248693	Jan/'21	0	
	Drywall Compound (East Wall - 1 Sample)	DC	Good	TESTED	248693	Jan/'21	0	
	Drywall Compound (South Wall - 1 Sample)	DC	Good	TESTED	248693	Jan/'21	0	
South Foyer (Hall)	12x12 Floor Tile - Black	F12	Good	TESTED	171805	Jun/'16	1	
	12x12 Floor Tile - Black	F12	Good	TESTED	209910	Oct/'18	0	
Apparatus Area	Pipe Fitting Insulation	PF	Good					
	Pipe Insulation	PI	Good					
	Roof Drain	RD	Good					
	Fire Stop Insulation - Grey (Top of perimeter conc block walls) (Temp. covered in ripstop)	CF	Good	TESTED	159531	Aug/15	80	
	Fire Stop Insulation - fallen debris on floor from roof work	CF	Debris cleanup	TESTED	b21273	Jun/'16	75	
Hose Tower	Vermiculite Block Walls (2019 Inspection)	VE	Good					<1
East Dormitory	Drywall Compound (Wall - 2 Samples )	DC	Good	TESTED	248693	Jan/'21	0	
West Lieutenants Dormitory	Drywall Compound ( 1 Sample )	DC	Good	TESTED	171805	Jun/'16	0	
<b>Exterior</b>								
Exterior Block Walls	Vermiculite	VE	Good	N/A				<1
Exterior Tyndal Stone Between Garage Bay Doors	Mortar	MO	Good	TESTED	209910	Oct/'18	2	
Exterior Windows East	Window Caulking	CA	Good	TESTED	209910	Oct/'18	2	
<b>Basement</b>								
East Stairway	12x12 Floor Tile		Removed/20					
	Sheet Flooring (later found to be large floor tile)		Removed/20					
West Stairway	12x12 Floor Tile	F12	Removed/20	TESTED	3502	Nov/'09	2-5	
	Sheet Flooring (later found to be large floor tile)		Removed/20					5
	Epoxy at Main Floor Landing		Removed/20	TESTED	243362	Sep/'20	0	
West Hallway	12x12 Floor Tile	F12	Good	TESTED		Nov/'10	2-5	
Women's Washroom	Cinder Block Randomly Inspected & Appear To Be Empty (Do Not Contain Vermiculite Insulation)		Good					
Women's Shower Room	Cinder Block Randomly Inspected & Appear To Be Empty (Do Not Contain Vermiculite Insulation)							
Locker/Game Room	9x9 Floor Tile	F9	Good					
	12x12 Floor Tile	F12	Good					
	Pipe Insulation - Above Ceiling	PI	Good					

Material Location	Material Description	Drawing Label	Material Condition	Testing Status	Lab Report #	Date M/Y	Test %	Est. %
Weight Room	Pipe Fitting Insulation - Above Ceiling	PF	Good					
	Wall Insulation (Black)		Good	TESTED	159716	Aug/'15	0	
	9x9 Floor Tile	F9	Removed					
	Pipe Fitting Insulation - Above Ceiling	PF	Removed					
	Pipe Insulation - Above Ceiling	PI	Good					
West Archives Room	12x12 Ceiling Tile	C12	Removed	TESTED	313747	Sep/'05	0	
	9x9 Floor Tile	F9	Good					
Electrical Room	Pipe Insulation	PI	Good	TESTED	133790	Nov'13	0	
	Pipe Fitting Insulation	PF	Good					
East Archives Room	9x9 Floor Tile	F9	Needs Repair					
Boardroom	12x12 Floor Tile	F12	Good	TESTED		Nov/'10	2-5	
EMS Storage Room	9x9 Floor Tile	F9	Removed					
	Pipe Fitting Insulation	PF	Removed					
	Pipe Insulation	PI	Removed					
	12x12 Ceiling Tile	C12	Good	TESTED	3502	Nov/'09	0	
EMS Small Storage Room	9x9 Floor Tile	F9	Needs Repair					
East Hallway	12x12 Floor Tile (Mastic 2-5%)	F12	Good	TESTED		Nov/'10	2-5	
East Stairway	12x12 Floor Tile	F12	Good	TESTED		Nov/'10	2-5	
	Sheet Flooring	FS	Good	TESTED	106761	Nov/'11	5	
Basement Tunnel	Pipe Insulation	PI	Good					
	Pipe Fitting Insulation	PF	Good	TESTED	313747	Sep/'05	1-5	
Boiler Room	Pipe Fitting Insulation (One PF visible)	PF	Good	TESTED	313747	Nov/'10	1-5	
	Duct Insulation, wrap & adhesive, paper	DI	Good	TESTED	120267	Nov/'12	0	
	Pipe Insulation	PI	Good					
	9x9 Floor Tile	F9	Removed	TESTED	3502	Nov/'09	2-5	
Crawl Space	No asbestos material found							
	Pipe Wrap		Good	TESTED	166861	Feb/'16	0	

**NOTES:**

1. Asbestos inspections and inventory updates are conducted annually.
2. There may be asbestos containing materials present that were not located during asbestos inspections.
3. Floor tile and sheet flooring installed before 1990 may contain asbestos and must be treated as an asbestos containing material.
4. Vermiculite insulation may contain pockets of asbestos. All vermiculite insulation must be treated as an asbestos containing material.
5. For asbestos related inquiries, call Central Control at 986-2382

# FS-01

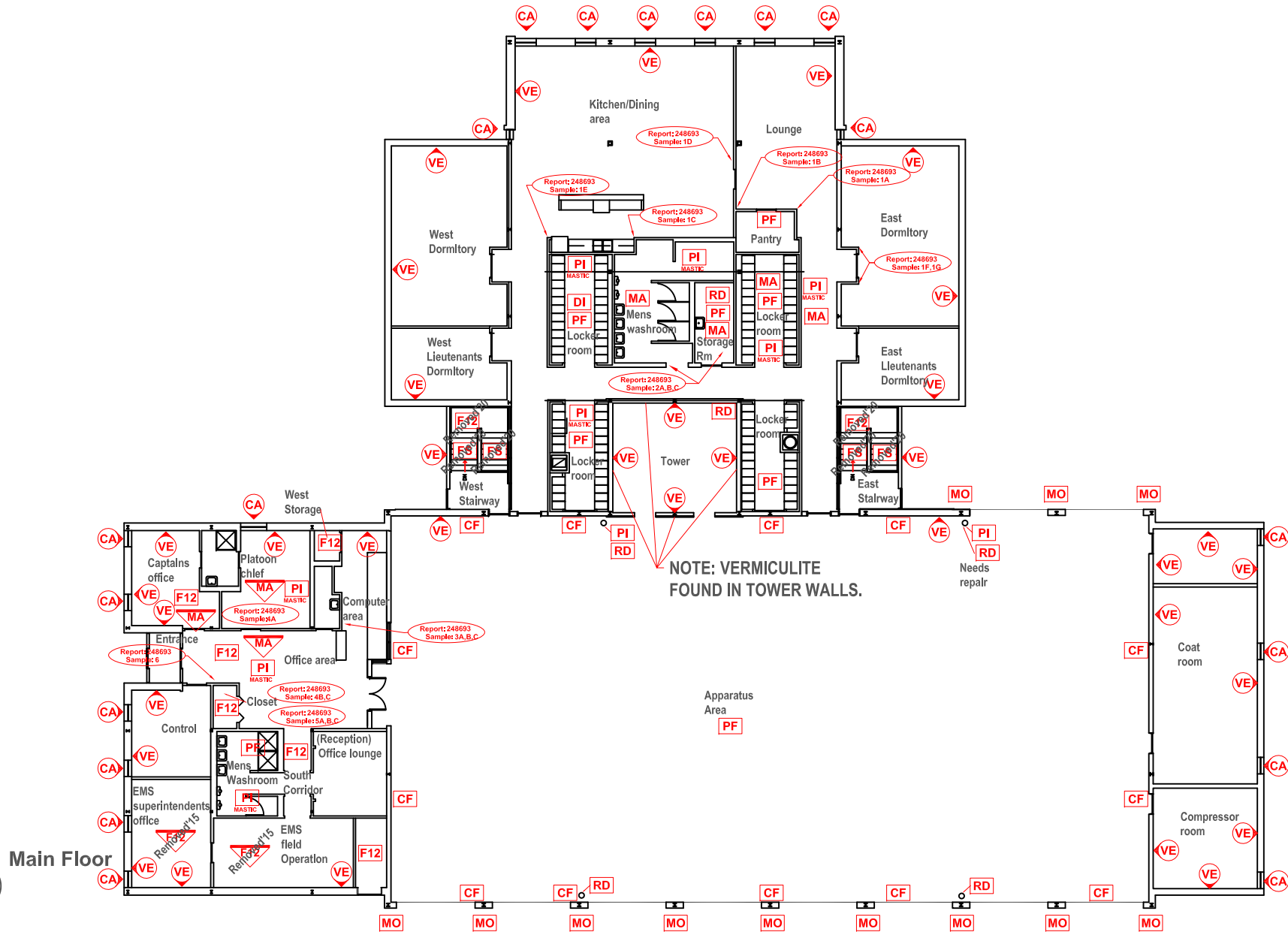

Main Floor

**LEGEND**

GENERAL LABELS    ABOVE CEILING    UNDER FLOORING    WALL DETAIL

?? =

??

??

??

??

AF: ASBESTOS FABRIC  
BR: BOILER REFRACTORY  
CA: CAULKING  
CF: CEMENTITIOUS FIBRE  
C12: 12X12 CEILING TILE  
C24: 24X24 CEILING TILE  
C48: 24X48 CEILING TILE  
DC: DRYWALL COMPOUND  
DI: DUCT INSULATION

FS: SHEET FLOORING  
F9: 9X9 FLOOR TILE  
F12: 12X12 FLOOR TILE  
HB: HARDBOARD  
MA: MASTIC  
MO: MORTAR  
PF: PIPE FITTING INSULATION  
PI: PIPE INSULATION  
PL: PLASTER

RD: ROOF DRAIN  
SC: STIPPLE CEILING  
SO: SPRAY ON  
ST: STUCCO  
TI: TANK INSULATION  
TP: TRANSITE PIPE  
VE: VERMICULITE

**NOTES:**

1. THERE MAY BE ASBESTOS CONTAINING MATERIALS PRESENT THAT WERE NOT LOCATED DURING BUILDING INSPECTIONS
2. REFER TO THE ASBESTOS INVENTORY SURVEY SHEET FOR MORE INFORMATION
3. DO NOT DISTURB ASBESTOS. FOR HANDLING PROCEDURES CALL CENTRAL CONTROL AT 986-2382

**ASBESTOS LOCATIONS**

BUILDING: FS-01 Fire Station 65 Ellen St Winnipeg, Manitoba		REVISIONS:	DATE:	SCALE:	SHEET #:
AB	November 5, 2021			N.T.S.	1/2



**CITY OF WINNIPEG**  
PLANNING, PROPERTY & DEVELOPMENT  
DEPARTMENT  
MUNICIPAL ACCOMMODATIONS DIVISION  
4th FLOOR - 185 KING STREET  
WINNIPEG, MANITOBA R3B 1J1  
PHONE: (204) 986-7266  
FAX: (204) 986-7311

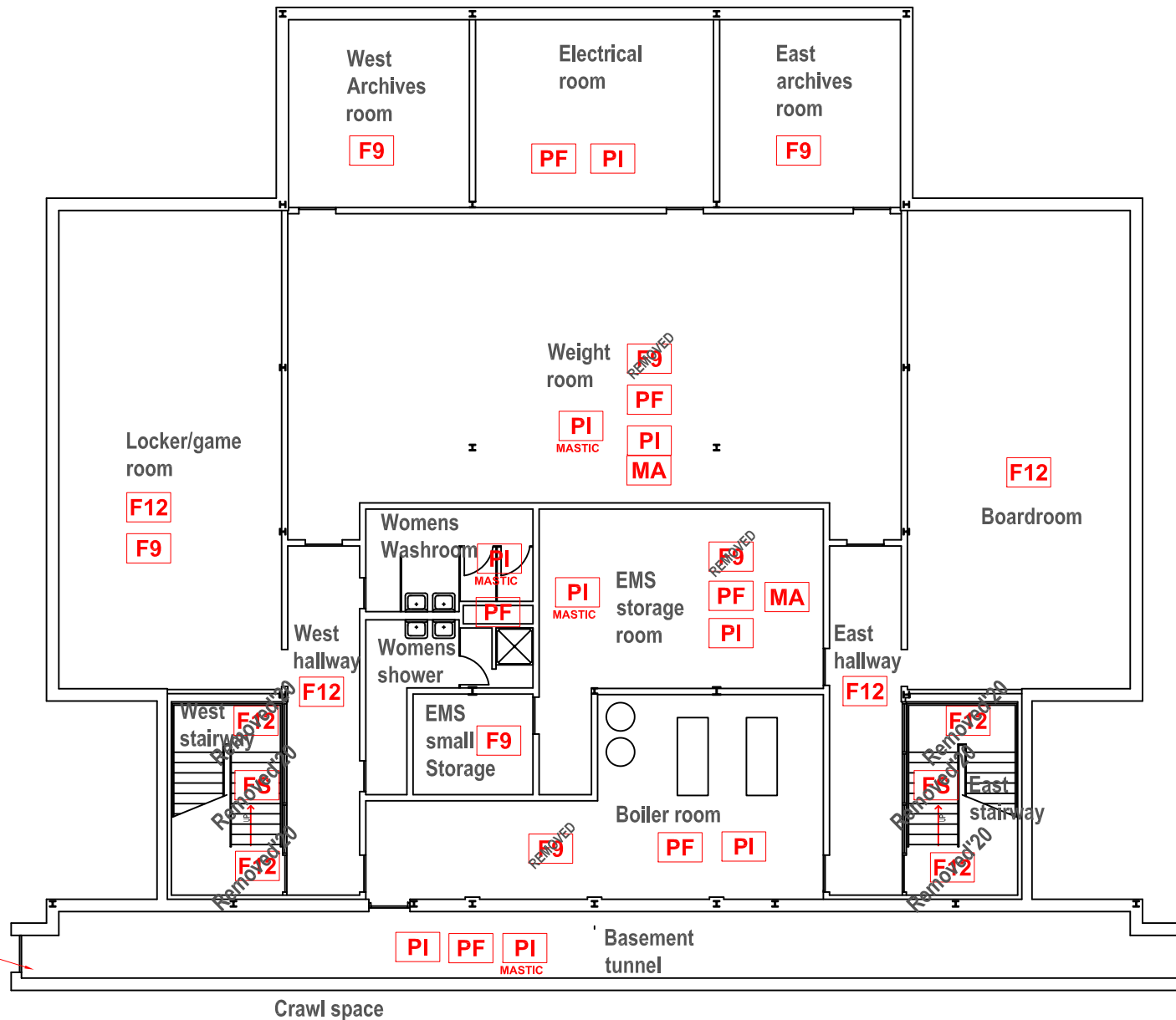

# Basement



Crawl space access hatch

## LEGEND

GENERAL LABELS	ABOVE CEILING	UNDER FLOORING	WALL DETAIL
??	??	??	??

AF:ASBESTOS FABRIC  
 BR:BOILER REFRACTORY  
 CA:CAULKING  
 CF:CEMENTITIOUS FIBRE  
 C12: 12X12 CEILING TILE  
 C24: 24X24 CEILING TILE  
 C48: 24X48 CEILING TILE  
 DC:DRYWALL COMPOUND  
 DI:DUCT INSULATION

FS:SHEET FLOORING  
 F9:9X9 FLOOR TILE  
 F12:12X12 FLOOR TILE  
 HB:HARDBOARD  
 MA:MASTIC  
 MO:MORTAR  
 PF:PIPE FITTING INSULATION  
 PI:PIPE INSULATION  
 PL:PLASTER

RD:ROOF DRAIN  
 SC:STIPPLE CEILING  
 SO:SPRAY ON  
 ST:STUCCO  
 TI:TANK INSULATION  
 TP:TRANSITE PIPE  
 VE:VERMICULITE

### NOTES:

1. THERE MAY BE ASBESTOS CONTAINING MATERIALS PRESENT THAT WERE NOT LOCATED DURING BUILDING INSPECTIONS
2. REFER TO THE ASBESTOS INVENTORY SURVEY SHEET FOR MORE INFORMATION
3. DO NOT DISTURB ASBESTOS. FOR HANDLING PROCEDURES CALL CENTRAL CONTROL AT 986-2382

## ASBESTOS LOCATIONS

BUILDING: FS-01 Fire Station 65 Ellen St Winnipeg, Manitoba		REVISIONS:	DATE: Novemehr 5, 2021	SCALE: N.T.S.	SHEET #: 2/2
--	--	------------	------------------------	---------------	--------------



**CITY OF WINNIPEG**  
 PLANNING, PROPERTY & DEVELOPMENT  
 DEPARTMENT  
 MUNICIPAL ACCOMMODATIONS DIVISION  
 4th FLOOR - 185 KING STREET  
 WINNIPEG, MANITOBA R3B 1J1  
 PHONE: (204) 986-7266  
 FAX: (204) 986-7311