

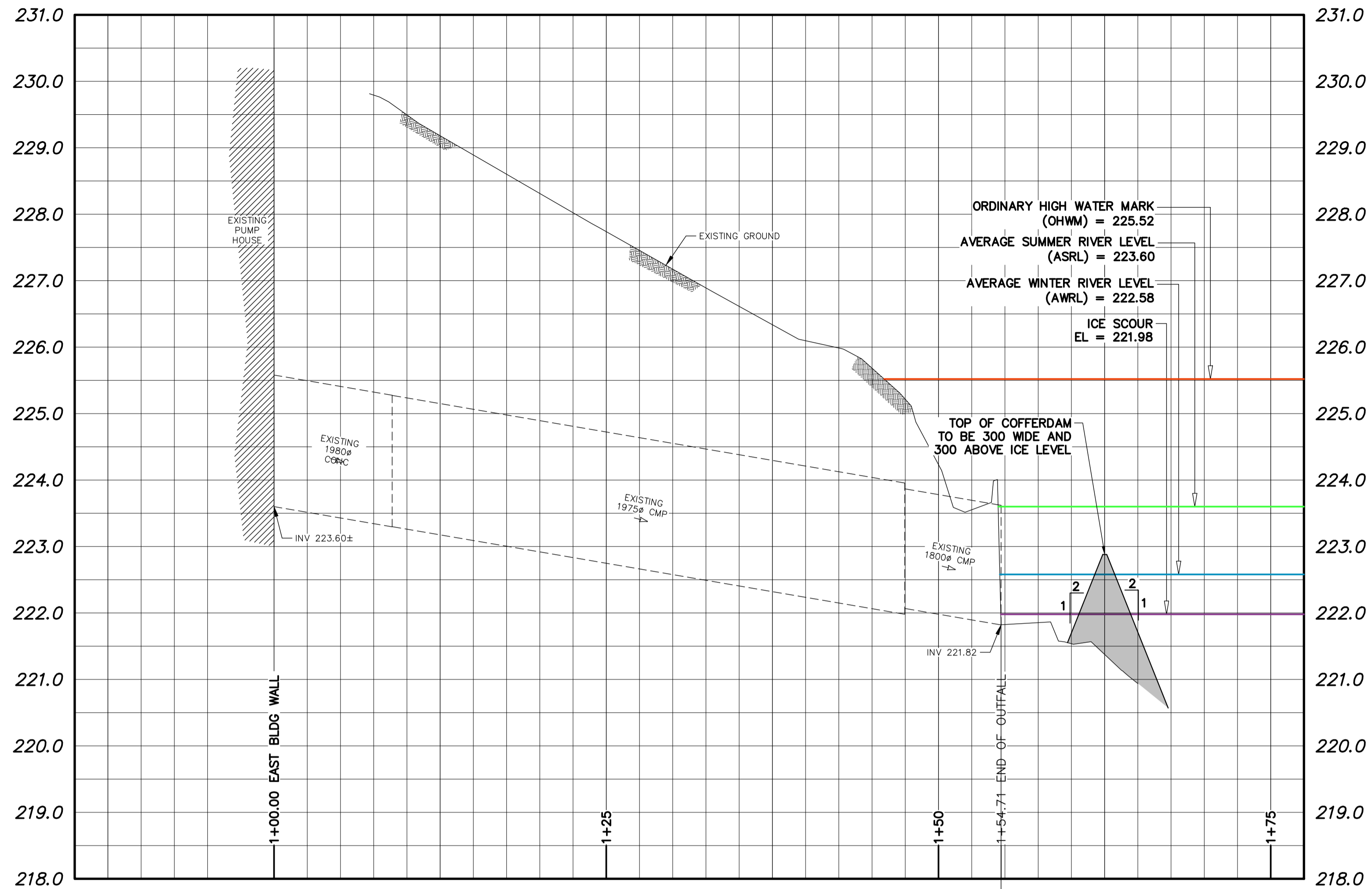

LOOKING INTO PIPE FROM OUTLET
DATE 2021-03

NOTES:

- 1. ALL EXCAVATED MATERIAL WITHIN 107.0 OF THE ASRL MUST BE REMOVED FROM SITE (NO STOCKPILING).
- 2. CONSTRUCT TEMPORARY CLAY COFFERDAM AT RIVER AS REQUIRED TO FACILITATE CLEANING.
- 3. CONTRACTOR TO PROTECT EXISTING TREES AND GEO INSTRUMENTATION THROUGHOUT CONSTRUCTION.
- 4. CONTRACTOR TO PROVIDE AND INSTALL PROPER WARNING SIGNS ALONG PEDESTRIAN PATHWAY CONCERNING WORK SITE.
- 5. CONTRACTOR TO PROVIDE ALTERNATE PEDESTRIAN ACCESS AS REQUIRED.
- 6. PERMITS AS REQUIRED FOR CONSTRUCTION OF TEMPORARY ACCESS IS THE RESPONSIBILITY OF THE CONTRACTOR.
- 7. ALL MATERIALS, INCLUDING TEMPORARY MATERIAL PLACED TO CONSTRUCT EQUIPMENT PADS, MUST BE REMOVED FROM SITE FOLLOWING COMPLETION OF WORKS.
- 8. REMOVE AND RE-INSTALL DEBRIS GRATE AS REQUIRED.



NOTE: CHAINAGES SHOWN ARE ALONG CL EXISTING OUTFALL

SUBSTRATE LEGEND

(Orange box)	GRAVEL/CLAY WITH COBBLE/BOULDER
(Light brown box)	CLAY WITH SOME SILT

SUBSTRATE TYPES BELOW ICE SCOUR AFFECTED BY THE PROJECT		
EXISTING SUBSTRATE	PERMANENT AREA (m ²)	TEMPORARY AREA (m ²)
GRAVEL/CLAY WITH COBBLE/BOULDER	0.0	3.0
CLAY WITH SOME SILT	0.0	109.1
TOTAL AREA AFFECTED	0.0	112.1

TO AUSTIN STREET NORTH
←

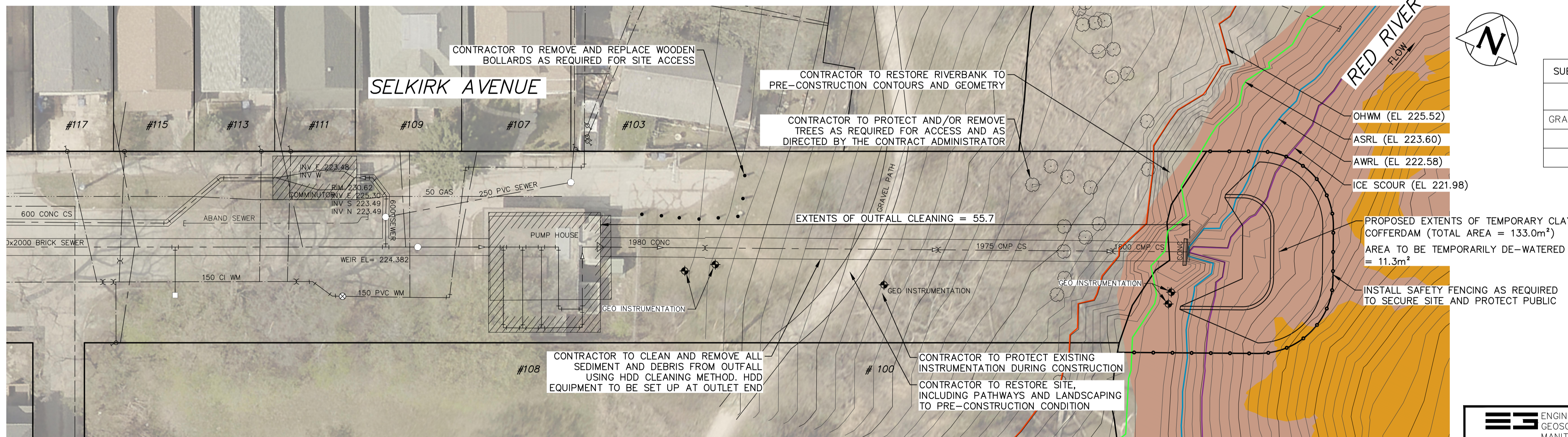

PLAN
SCALE 1:250

FOR INDEX PAGE SEE DWG
1-03030-0009-001

METRIC
WHOLE NUMBERS INDICATE MILLIMETRES
DECIMALIZED NUMBERS INDICATE METRES



WARNING
IF POWER EQUIPMENT OR EXPLOSIVES ARE TO BE USED FOR EXCAVATION ON THIS PROJECT THE CONTRACTOR MUST:
1) NOTIFY THE GAS COMPANY OF THE PROPOSED LOCATION OF EXCAVATION.
2) TAKE PRECAUTION TO AVOID DAMAGE TO GAS COMPANY INSTALLATIONS.
SEE PROVINCIAL REGULATION 2107/2 FOR DETAILS

LOCATION APPROVED
UNDERGROUND STRUCTURES
SUPV. U/G STRUCTURES COMMITTEE DATE
NOTE:
LOCATION OF UNDERGROUND STRUCTURES AS SHOWN ARE BASED ON THE BEST INFORMATION AVAILABLE BUT NO GUARANTEE IS GIVEN THAT ALL EXISTING UTILITIES ARE SHOWN OR THAT THE GIVEN LOCATIONS ARE EXACT. CONFIRMATION OF EXISTENCE AND EXACT LOCATION OF ALL SERVICES MUST BE OBTAINED FROM THE INDIVIDUAL UTILITIES BEFORE PROCEEDING WITH CONSTRUCTION.

B.M. ELEV.			
B.M.	ELEV.	DATE	BY
0	ISSUED FOR TENDER	2021 11 05	
NO.	REVISIONS	DATE	BY

KGS GROUP			
DESIGNED BY	NGV	CHECKED BY	
DRAWN BY	GEL	APPROVED BY	
SCALE:	HORIZONTAL 1:250	RELEASED FOR CONSTRUCTION	
	VERTICAL 1:50	DATE	2021 11 04

ENGINEER'S SEAL	
CONSULTANT DRAWING NUMBER	1-03030-C0053-001

THE CITY OF WINNIPEG
WATER AND WASTE DEPARTMENT
ENGINEERING DIVISION

2020-2021 OUTFALL PROGRAM
CLEANING
108 SELKIRK AVENUE OUTFALL
PLAN AND PROFILE
S-MA70007427

SHEET **16** OF **26**
CITY DRAWING NUMBER
1-03030-C0053-001

ES ENGINEERS
GEOSCIENTISTS
MANITOBA
Certificate of Authorization
KGS Group
No. 245