

MATCH LINE - STA 0+430

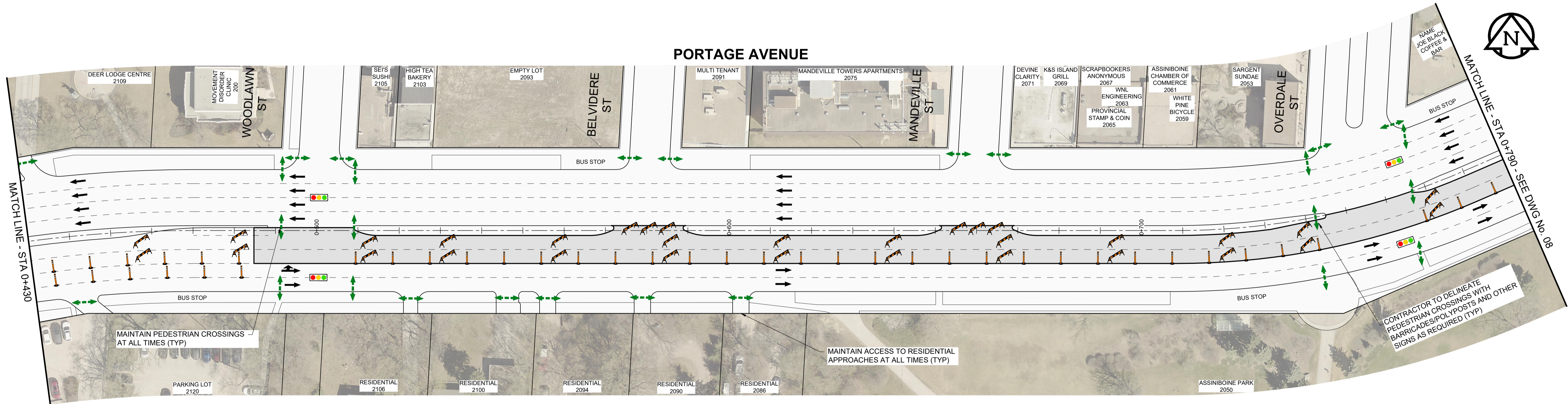

MATCH LINE - STA 0+790 - SEE DWG No. 08

PORTAGE AVENUE

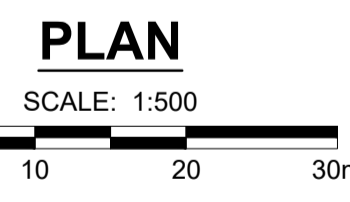

| | | | |
|--|--------------------------|-----------------|---|
| LOCATION APPROVED UNDERGROUND STRUCTURES | | B.M. 38-004 | Tilt in 7.6 m Conc. pile under B.M. cover, 4 m N. of S.L. of Portage, 2.4 m W. of line of E.L. of Conway St. N. of Portage & 28.1 m N.E. of N.E. Cor. of Pump House S. of Portage |
| SUPR. U/G STRUCTURES COMMITTEE DATE | | ELEV. 235.636 m | |
| NOTE: LOCATION OF UNDERGROUND STRUCTURES AS SHOWN ARE BASED ON THE BEST INFORMATION AVAILABLE BUT NO GUARANTEE IS GIVEN THAT ALL EXISTING UTILITIES ARE SHOWN OR THAT THE GIVEN LOCATIONS ARE EXACT. CONFIRMATION OF EXISTENCE AND EXACT LOCATION OF ALL SERVICES MUST BE OBTAINED FROM THE INDIVIDUAL UTILITIES BEFORE PROCEEDING WITH CONSTRUCTION. | | | |
| A | ISSUED FOR TENDER | 21/02/04 | GFC |
| A | ISSUED FOR CLIENT REVIEW | 20/12/21 | GFC |
| No. | REVISIONS | YY/MM/DD | BY DATE |

| | |
|---------------------------|----------|
| | |
| DESIGNED BY | ASM |
| CHECKED BY | GFC |
| DRAWN BY | DML |
| APPROVED BY | RPB |
| RELEASED FOR CONSTRUCTION | |
| HOR SCALE | 1:500 |
| VERT SCALE | GFC |
| DATE | 20/12/15 |

| | |
|----------------------|---------------------|
| CONSULTANT FILE NAME | 2020287-STAGE 2.dwg |
|----------------------|---------------------|

THE CITY OF WINNIPEG
PUBLIC WORKS DEPARTMENT
ENGINEERING DIVISION

2021 PAVEMENT RENEWALS PROJECT
PORTAGE AVENUE MILL AND FILL
MOORGATE STREET TO ST JAMES STREET

CONSTRUCTION STAGING
STAGE 2 - EASTBOUND HIGH
MOORGATE ST TO STA 0+790

| | |
|---------------------|----------|
| CITY DRAWING NUMBER | N/A |
| SHEET OF | 07 OF 20 |
| DRAWING NUMBER | 07 |

TENDER No. 8-2021

METRIC
WHOLE NUMBERS INDICATE MILLIMETRES
DECIMALIZED NUMBERS INDICATE METRES