

**PORTAGE AVENUE**

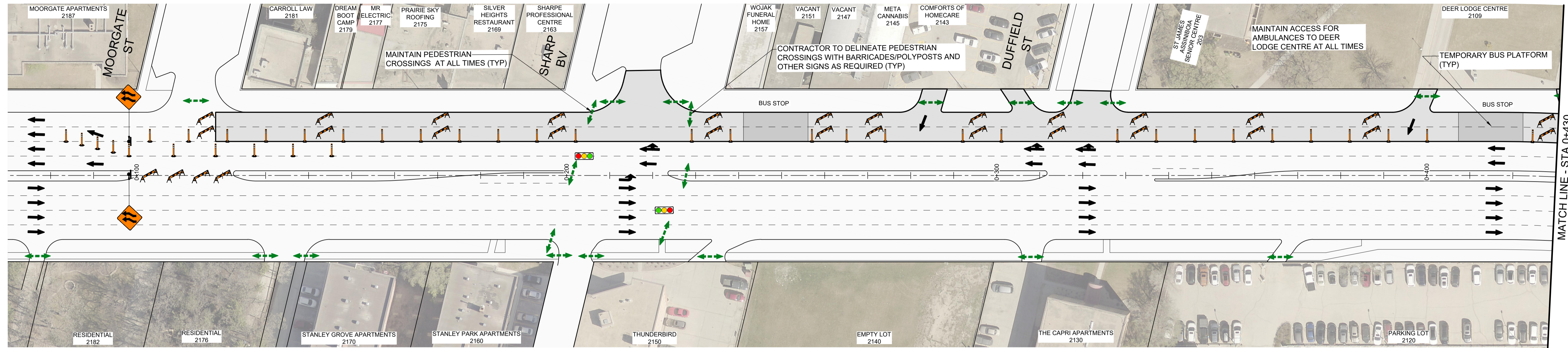

**PORTAGE AVENUE**

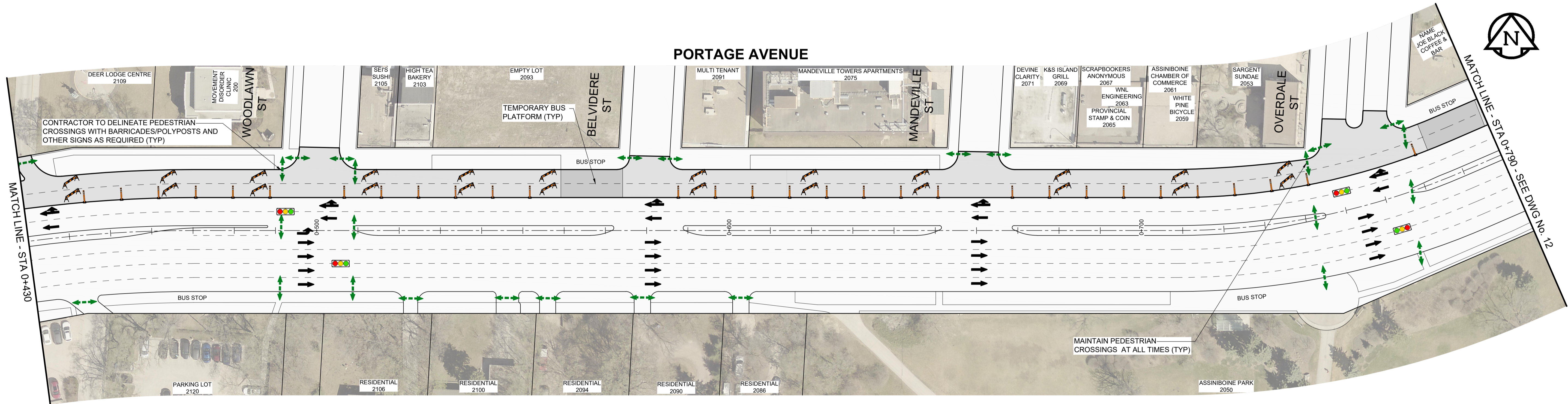

**PLAN**

SCALE: 1:500



<b>LOCATION APPROVED UNDERGROUND STRUCTURES</b>	
SUPR. U/G STRUCTURES COMMITTEE	DATE
<b>NOTE:</b> LOCATION OF UNDERGROUND STRUCTURES AS SHOWN ARE BASED ON THE BEST INFORMATION AVAILABLE BUT NO GUARANTEE IS GIVEN THAT ALL EXISTING UTILITIES ARE SHOWN OR THAT THE GIVEN LOCATIONS ARE EXACT. CONFIRMATION OF EXISTENCE AND EXACT LOCATION OF ALL SERVICES MUST BE OBTAINED FROM THE INDIVIDUAL UTILITIES BEFORE PROCEEDING WITH CONSTRUCTION.	

BIM	38-004	tblt in 7.6 m Conc. pile under B.M. cover, 4 m N. of S.L. of Portage, 2.4 m W. of line of E.L. of Conway St. N. of Portage & 28.1 m N.E. of N.E. Cor. of Pumphouse S. of Portage
ELEV	235.636 m	
No.	REVISIONS	YY/MM/DD BY



DESIGNED BY	ASM	CHECKED BY	GFC
DRAWN BY	DML	APPROVED BY	RPB
HOR SCALE		RELEASED FOR CONSTRUCTION	
VERT SCALE		DATE	
DATE		20/12/15	

CONSULTANT FILE NAME  
2020287-STAGE 3.dwg

TENDER No. 8-2021



**2021 PAVEMENT RENEWALS PROJECT**  
**PORTAGE AVENUE MILL AND FILL**  
**MOORGATE STREET TO ST JAMES STREET**  
 CONSTRUCTION STAGING  
**STAGE 3 - WESTBOUND LOW SIDE**  
 MOORGATE ST TO STA 0+790

CITY DRAWING NUMBER	N/A
SHEET OF	11 OF 20
DRAWING NUMBER	11

**METRIC**  
 WHOLE NUMBERS INDICATE MILLIMETRES  
 DECIMALIZED NUMBERS INDICATE METRES