

PORTAGE AVENUE

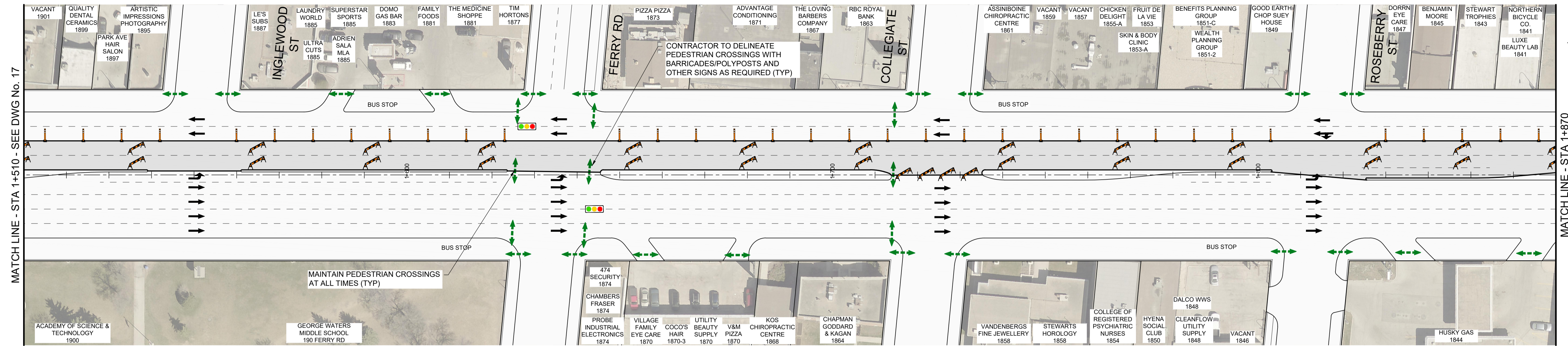

PORTAGE AVENUE

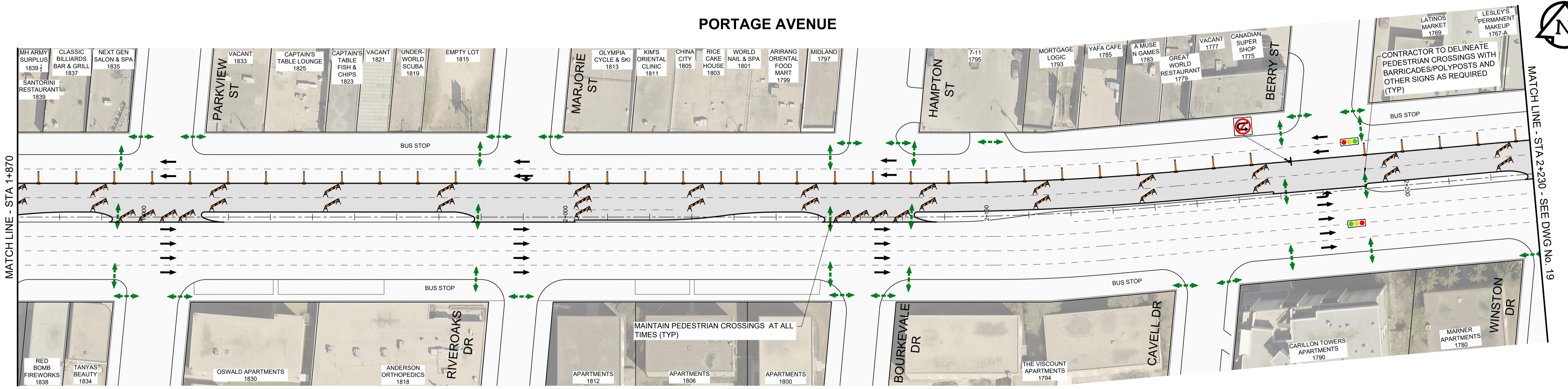

PLAN

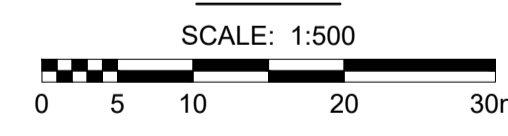

P:\2020\202028700-2020-2021 Portage Ave-Sargent Ave R109_CAD\07 Sheets\Portage\2020287-STAGE 4.dwg Last Saved: 12/7/2021 7:03 PM by DLine Plotted: 24/2/2021 2:07 PM by Dave Lane

LOCATION APPROVED UNDERGROUND STRUCTURES	
SUPR. U/G STRUCTURES COMMITTEE	DATE
NOTE: LOCATION OF UNDERGROUND STRUCTURES AS SHOWN ARE BASED ON THE BEST INFORMATION AVAILABLE BUT NO GUARANTEE IS GIVEN THAT ALL EXISTING UTILITIES ARE SHOWN OR THAT THE GIVEN LOCATIONS ARE EXACT. CONFIRMATION OF EXISTENCE AND EXACT LOCATION OF ALL SERVICES MUST BE OBTAINED FROM THE INDIVIDUAL UTILITIES BEFORE PROCEEDING WITH CONSTRUCTION.	

BM 38-004	1.61 m Conc. pile under B.M. cover, 4 m N. of S.L. of Portage, 2.4 m W. of line of E.L. of Conway St. N. of Portage & 28.1 m N.E. of N.E. Cor. of Pump House S. of Portage		
ELEV 235.636 m			
B	ISSUED FOR TENDER	21/02/04	GFC
A	ISSUED FOR CLIENT REVIEW	20/12/21	GFC
No.	REVISIONS	YY/MM/DD	BY

MORRISON HERSHFIELD			
DESIGNED BY	ASM	CHECKED BY	GFC
DRAWN BY	DML	APPROVED BY	RPB
HOR SCALE		RELEASED FOR CONSTRUCTION	
VERT SCALE		DATE	
DATE		20/12/15	

CONSULTANT FILE NAME	2020287-STAGE 4.dwg
----------------------	---------------------

THE CITY OF WINNIPEG
PUBLIC WORKS DEPARTMENT
ENGINEERING DIVISION

2021 PAVEMENT RENEWALS PROJECT
PORTAGE AVENUE MILL AND FILL
MOORGATE STREET TO ST JAMES STREET

CONSTRUCTION STAGING
STAGE 4 - WESTBOUND HIGH SIDE
STA 1+510 TO STA 2+230

CITY DRAWING NUMBER	N/A
SHEET	18 OF 20
DRAWING NUMBER	18

TENDER No. 8-2021

METRIC
WHOLE NUMBERS INDICATE MILLIMETRES
DECIMALIZED NUMBERS INDICATE METRES