

C:\pwworking\directory\projects\2021\40jpa\mms57051\212462-CF-COON-STAGE-1.dwg

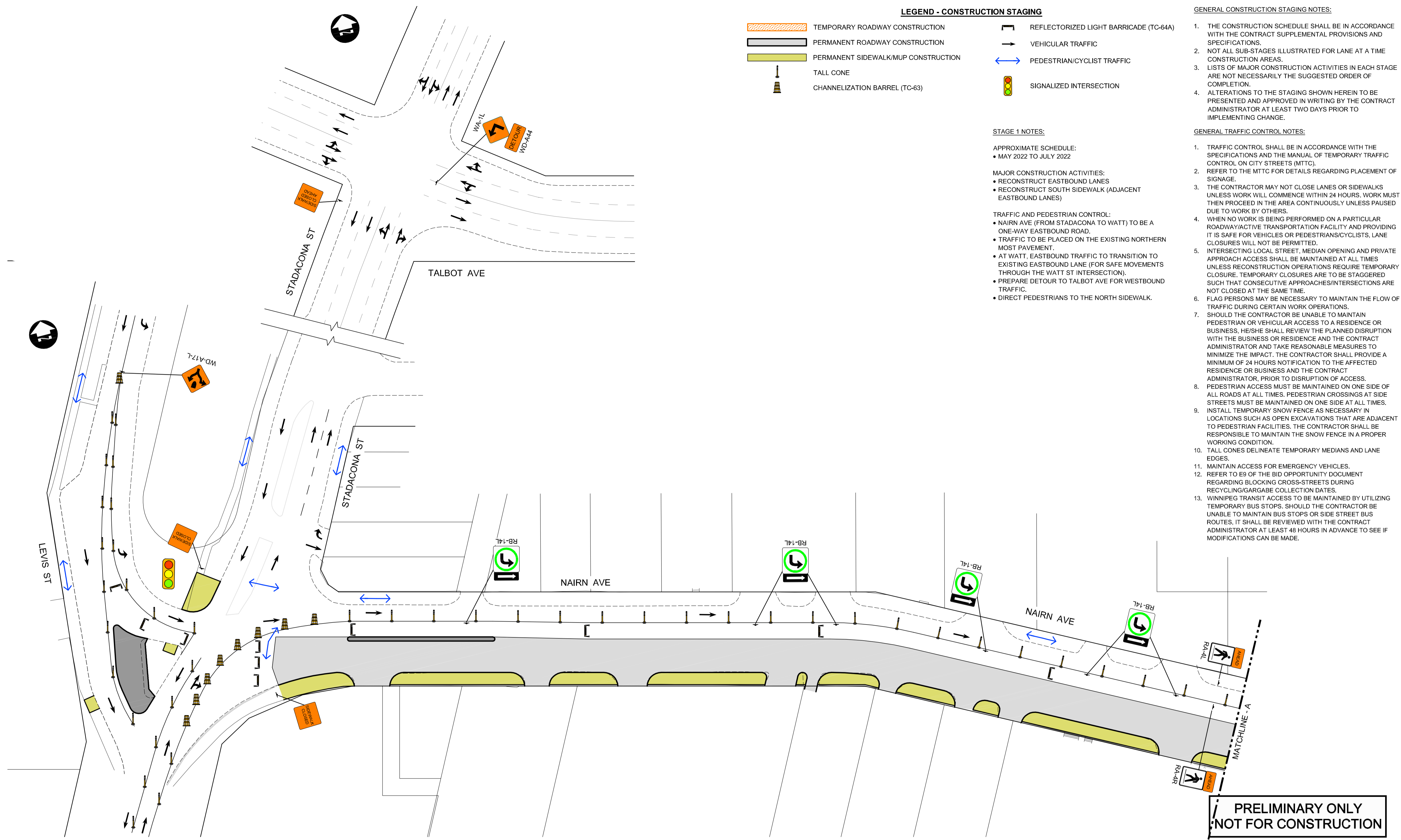

**LEGEND - CONSTRUCTION STAGING**

- TEMPORARY ROADWAY CONSTRUCTION
- PERMANENT ROADWAY CONSTRUCTION
- PERMANENT SIDEWALK/MUP CONSTRUCTION
- TALL CONE
- CHANNELIZATION BARREL (TC-63)
- REFLECTORIZED LIGHT BARRICADE (TC-64A)
- VEHICULAR TRAFFIC
- PEDESTRIAN/CYCLIST TRAFFIC
- SIGNALIZED INTERSECTION

**STAGE 1 NOTES:**

- APPROXIMATE SCHEDULE:**
- MAY 2022 TO JULY 2022
- MAJOR CONSTRUCTION ACTIVITIES:**
- RECONSTRUCT EASTBOUND LANES
  - RECONSTRUCT SOUTH SIDEWALK (ADJACENT EASTBOUND LANES)
- TRAFFIC AND PEDESTRIAN CONTROL:**
- NAIRN AVE (FROM STADACONA TO WATT) TO BE A ONE-WAY EASTBOUND ROAD.
  - TRAFFIC TO BE PLACED ON THE EXISTING NORTHERN MOST PAVEMENT.
  - AT WATT, EASTBOUND TRAFFIC TO TRANSITION TO EXISTING EASTBOUND LANE (FOR SAFE MOVEMENTS THROUGH THE WATT ST INTERSECTION).
  - PREPARE DETOUR TO TALBOT AVE FOR WESTBOUND TRAFFIC.
  - DIRECT PEDESTRIANS TO THE NORTH SIDEWALK.

**GENERAL CONSTRUCTION STAGING NOTES:**

1. THE CONSTRUCTION SCHEDULE SHALL BE IN ACCORDANCE WITH THE CONTRACT SUPPLEMENTAL PROVISIONS AND SPECIFICATIONS.
2. NOT ALL SUB-STAGES ILLUSTRATED FOR LANE AT A TIME CONSTRUCTION AREAS.
3. LISTS OF MAJOR CONSTRUCTION ACTIVITIES IN EACH STAGE ARE NOT NECESSARILY THE SUGGESTED ORDER OF COMPLETION.
4. ALTERATIONS TO THE STAGING SHOWN HEREIN TO BE PRESENTED AND APPROVED IN WRITING BY THE CONTRACT ADMINISTRATOR AT LEAST TWO DAYS PRIOR TO IMPLEMENTING CHANGE.

**GENERAL TRAFFIC CONTROL NOTES:**

1. TRAFFIC CONTROL SHALL BE IN ACCORDANCE WITH THE SPECIFICATIONS AND THE MANUAL OF TEMPORARY TRAFFIC CONTROL ON CITY STREETS (MTTC).
2. REFER TO THE MTTC FOR DETAILS REGARDING PLACEMENT OF SIGNAGE.
3. THE CONTRACTOR MAY NOT CLOSE LANES OR SIDEWALKS UNLESS WORK WILL COMMENCE WITHIN 24 HOURS. WORK MUST THEN PROCEED IN THE AREA CONTINUOUSLY UNLESS PAUSED DUE TO WORK BY OTHERS.
4. WHEN NO WORK IS BEING PERFORMED ON A PARTICULAR ROADWAY/ACTIVE TRANSPORTATION FACILITY AND PROVIDING IT IS SAFE FOR VEHICLES OR PEDESTRIANS/CYCLISTS, LANE CLOSURES WILL NOT BE PERMITTED.
5. INTERSECTING LOCAL STREET, MEDIAN OPENING AND PRIVATE APPROACH ACCESS SHALL BE MAINTAINED AT ALL TIMES UNLESS RECONSTRUCTION OPERATIONS REQUIRE TEMPORARY CLOSURE. TEMPORARY CLOSURES ARE TO BE STAGGERED SUCH THAT CONSECUTIVE APPROACHES/INTERSECTIONS ARE NOT CLOSED AT THE SAME TIME.
6. FLAG PERSONS MAY BE NECESSARY TO MAINTAIN THE FLOW OF TRAFFIC DURING CERTAIN WORK OPERATIONS.
7. SHOULD THE CONTRACTOR BE UNABLE TO MAINTAIN PEDESTRIAN OR VEHICULAR ACCESS TO A RESIDENCE OR BUSINESS, HE/SHE SHALL REVIEW THE PLANNED DISRUPTION WITH THE BUSINESS OR RESIDENCE AND THE CONTRACT ADMINISTRATOR AND TAKE REASONABLE MEASURES TO MINIMIZE THE IMPACT. THE CONTRACTOR SHALL PROVIDE A MINIMUM OF 24 HOURS NOTIFICATION TO THE AFFECTED RESIDENCE OR BUSINESS AND THE CONTRACT ADMINISTRATOR, PRIOR TO DISRUPTION OF ACCESS.
8. PEDESTRIAN ACCESS MUST BE MAINTAINED ON ONE SIDE OF ALL ROADS AT ALL TIMES. PEDESTRIAN CROSSINGS AT SIDE STREETS MUST BE MAINTAINED ON ONE SIDE AT ALL TIMES.
9. INSTALL TEMPORARY SNOW FENCE AS NECESSARY IN LOCATIONS SUCH AS OPEN EXCAVATIONS THAT ARE ADJACENT TO PEDESTRIAN FACILITIES. THE CONTRACTOR SHALL BE RESPONSIBLE TO MAINTAIN THE SNOW FENCE IN A PROPER WORKING CONDITION.
10. TALL CONES DELINEATE TEMPORARY MEDIANS AND LANE EDGES.
11. MAINTAIN ACCESS FOR EMERGENCY VEHICLES.
12. REFER TO E9 OF THE BID OPPORTUNITY DOCUMENT REGARDING BLOCKING CROSS-STREETS DURING RECYCLING/GARGABE COLLECTION DATES.
13. WINNIPEG TRANSIT ACCESS TO BE MAINTAINED BY UTILIZING TEMPORARY BUS STOPS. SHOULD THE CONTRACTOR BE UNABLE TO MAINTAIN BUS STOPS OR SIDE STREET BUS ROUTES, IT SHALL BE REVIEWED WITH THE CONTRACT ADMINISTRATOR AT LEAST 48 HOURS IN ADVANCE TO SEE IF MODIFICATIONS CAN BE MADE.

**PRELIMINARY ONLY  
NOT FOR CONSTRUCTION**

**ENGINEERS  
GEOSCIENTISTS  
MANITOBA**

Certificate of Authorization  
**Dillon Consulting Limited (MB)**  
 No. 1789 Date: 2022/03/09

UNDERGROUND STRUCTURES  SUPV. U/G STRUCTURES      DATE	B.M. ELEV.	DESIGNED BY	TJH/MRD		ENGINEER'S SEAL		<b>THE CITY OF WINNIPEG</b> PUBLIC WORKS DEPARTMENT	CITY DRAWING NUMBER P-3556-11
		DRAWN BY	TJH		RELEASED FOR CONSTRUCTION DATE			
LOCATION OF UNDERGROUND STRUCTURES AS SHOWN ARE BASED ON THE BEST INFORMATION AVAILABLE, BUT NO GUARANTEE IS GIVEN THAT ALL EXISTING UTILITIES ARE SHOWN OR THAT THE GIVEN LOCATIONS ARE EXACT. CONFIRMATION OF EXISTENCE AND EXACT LOCATION OF ALL SERVICES MUST BE OBTAINED FROM THE INDIVIDUAL UTILITIES BEFORE PROCEEDING WITH CONSTRUCTION.		CHECKED BY	TS			2021 REGIONAL STREET PROGRAM NAIRN AVENUE RECONSTRUCTION AND WATERMAIN RENEWAL	CONSULTANT DRAWING NUMBER	
		APPROVED BY	TJP			NAIRN AVE - TRAFFIC STAGING - STAGE 1 (1 OF 3)		
		HOR. SCALE	1:250					
		VERTICAL	1:50					
		NO. REVISIONS	DATE	BY	DATE			
		0	ISSUED FOR TENDER		22/03/09			