

NOTE: CHAINAGES SHOWN ARE ALONG THE SOUTH PROPERTY LINE OF NAIRN AVENUE

- SYMBOLS:**
- HYDRO MANHOLE
  - TELEPHONE MANHOLE
  - TRAFFIC SIGNAL SPLICE PIT
  - WATER VALVE
  - HYDRANT
  - CURB STOP
  - GAS VALVE
  - HYDRO POLE
  - HYDRO POLE WITH LIGHT
  - LIGHT STANDARD
  - TRAFFIC SIGNAL
  - SIGNAL CONTROL BOX
  - BELLMTS PEDESTAL
  - TREE
  - IRON PROPERTY BAR
  - HYDRO GUY ANCHOR

- WATERMAIN CONSTRUCTION NOTES:**
- EXPOSE EXISTING WATERMAIN & CONFIRM INVERTS PRIOR TO CONSTRUCTION.
  - LOCATION OF ALL SERVICES TO BE CONFIRMED IN THE FIELD.
  - INSTALL WATERMAIN BY TRENCHLESS METHODS.
  - TRENCHES AND EXCAVATIONS WITHIN 1.0 m OF A PAVED AREA INCLUDING SIDEWALKS SHALL BE CLASS 3 BACKFILL.
  - ALL MATERIALS SHALL CONFORM TO THE CITY OF WINNIPEG STANDARD CONSTRUCTION SPECIFICATIONS.
  - MINIMUM COVER TO TOP OF WATERMAIN SHALL BE 2.4 m.
  - REPLACE ALL EXISTING LEAD SERVICES FROM PROPOSED WATERMAIN TO PROPERTY LINE.
  - NOTIFY ALL AFFECTED RESIDENTS AND BUSINESSES 24 HOURS IN ADVANCE OF ANY WATER SHUTDOWNS OR DISRUPTION OF SERVICE.
  - WHERE CROSSING AN EXISTING COMBINED SEWER OR LAND DRAINAGE SEWER, THE WATERMAIN SHALL BE INSTALLED TO MAINTAIN A MINIMUM 0.5m VERTICAL CLEARANCE BETWEEN THE PIPES.

- ABBREVIATIONS:**
- WWS WASTE WATER SEWER
  - CS COMBINED SEWER
  - LDS LAND DRAINAGE SEWER
  - CL CENTER LINE
  - GIS GEOGRAPHIC INFORMATION SYSTEM
  - BM BENCH MARK
  - TH TEST HOLE
  - ELEV ELEVATION
  - INV INVERT
  - OBV OBVERT
  - MIN MINIMUM
  - MAX MAXIMUM
  - SL STREET LIGHTS
  - TS TRAFFIC SIGNALS
  - ABAND ABANDONED
  - BLDG BUILDING
  - HSE HOUSE
  - CRN CORNER
  - OPP OPPOSITE
  - WM WATERMAIN
  - MH MANHOLE
  - CB CATCH BASIN
  - CI CURB INLET
  - VERT VERTICAL
  - HORZ HORIZONTAL
  - TYP TYPICAL
  - HYD HYDRANT
  - EX EXISTING
  - N NORTH
  - E EAST
  - S SOUTH
  - W WEST
  - WI WITH
  - C/W CONSTRUCTED WITH
  - CONC CONCRETE
  - ASP ASPHALT
  - AC ASBESTOS CEMENT
  - VC VITRIFIED CLAY
  - CI CAST IRON
  - DI DUCTILE IRON
  - PVC POLYVINYL CHLORIDE
  - HDPE HIGH DENSITY POLYETHYLENE
  - PCCP PRESTRESSED CONCRETE CYLINDER PIPE

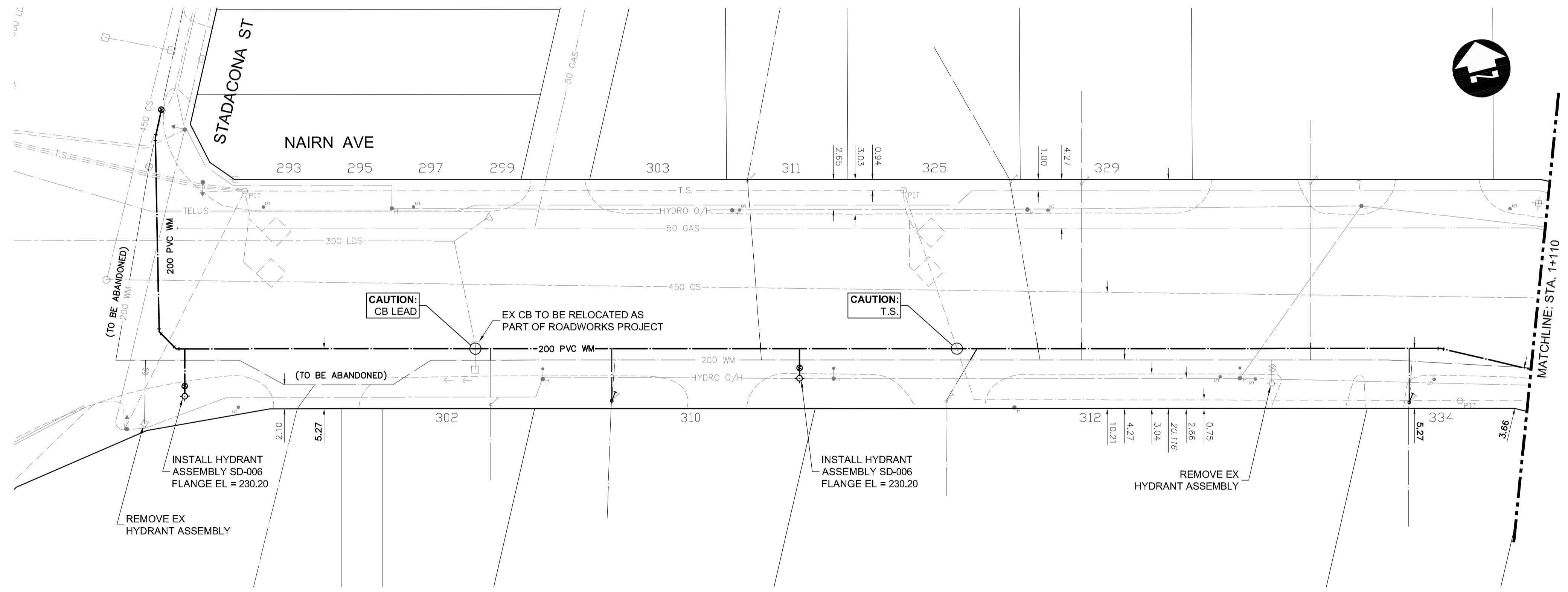

WATER SERVICE INFORMATION					
ADDRESS	SIZE (mm) MATERIAL (STREET)	SIZE (mm) MATERIAL (PROP.)	SHORT & LONG MEASUREMENTS	CORP. LOCATION	REMARKS
302 NAIRN AVE COMMERCIAL	25 CU	25 CU	14 WEL BLDG 100 EEL STADACONA	5 E S/C	RECONNECT SERVICE
310 NAIRN AVE COMMERCIAL	20 LEAD	20 LEAD	139 EEL OF STADACONA	SAME AS S/C	RENEW SERVICE
311 NAIRN AVE COMMERCIAL	-	-	-	-	RECONNECT SERVICE
312 NAIRN AVE COMMERCIAL	20 CU	20 CU	2 WEL BLDG 94 W 1ST HYD E STADACONA	1 E S/C	RECONNECT SERVICE
325 NAIRN AVE COMMERCIAL	N/A	N/A	N/A	N/A	RECONNECT SERVICE
329 NAIRN AVE COMMERCIAL	20 CU	12 LEAD	14 WEL BLDG 261 EEL STADACONA	269 EEL STADACONA	RECONNECT SERVICE
334 NAIRN AVE COMMERCIAL	12 LEAD	12 LEAD	8' W/WL HSE 371' EEL STADACONA	373' E EAL STADACONA	RENEW SERVICE

**PRELIMINARY ONLY  
NOT FOR CONSTRUCTION**

**ES ENGINEERS  
GEOSCIENTISTS  
MANITOBA**  
Certificate of Authorization  
**Dillon Consulting Limited (MB)**  
No. 1789 Date: 2022/03/09

EXISTING	LEGEND-PLAN	PROPOSED	EXISTING	LEGEND-PLAN	PROPOSED	EXISTING	LEGEND-PROFILE	PROPOSED
○	WATERMAIN	○	○	CURB STOP	○	○	WATERMAIN	○
○	LAND DRAINAGE SEWER	○	○	HYDRANT	○	○	LAND DRAINAGE SEWER	○
○	WASTE WATER SEWER	○	○	VALVE	○	○	WASTE WATER SEWER	○
○	HYDRO	○	○	BEND	○	○	HYDRANT	○
○	BELLMTS	○	○	REDUCER	○	○	VALVE	○
○	GAS	○	○	COUPLING	○	○	TEE OR CROSS	○
○	TRAFFIC SIGNALS	○	○	PLUG	○	○	COUPLING OR BEND	○
○	STREET LIGHTS	○	○	CROSS	○	○	REDUCER	○
○	MANHOLE	○	○	TEE	○	○	END OF PIPE	○
○	CATCH BASIN	○	○	VERTICAL BEND	○	○		
○	CATCH PIT	○	○	JUNCTION	○	○		

UNDERGROUND STRUCTURES		B.M. ELEV.	DESIGNED BY	SDG
○	U/G STRUCTURES		DRAWN BY	TJH
○	DATE		CHECKED BY	TS
○			APPROVED BY	TJP
○			HOR. SCALE	1:250
○			VERTICAL	1:50
○			RELEASED FOR CONSTRUCTION	
○			DATE	
○			ISSUED FOR TENDER	22/03/09
○			DATE	
○			NO. REVISIONS	
○			DATE	
○			BY	
○			DATE	

**DILLON CONSULTING**

ENGINEER'S SEAL  
PROVINCE OF MANITOBA  
REGISTERED PROFESSIONAL ENGINEER  
S.D. GOLDSTINE  
2022/03/09  
Member 42343

**THE CITY OF WINNIPEG**  
PUBLIC WORKS DEPARTMENT

**2021 REGIONAL STREET PROGRAM**  
NAIRN AVENUE RECONSTRUCTION AND  
WATERMAIN RENEWAL

NAIRN AVE - WATERMAIN RENEWAL  
(START TO STA. 1+110)

CITY DRAWING NUMBER P-3556-19  
SHEET 19 OF 21  
CONSULTANT DRAWING NUMBER

CONSULTANT PROJECT NUMBER  
**21-2462**

C:\w\working\_directory\projects\_2021\_40jpa\mbs08082\_212462-CU-CO-N-WM.dwg