

PLAN

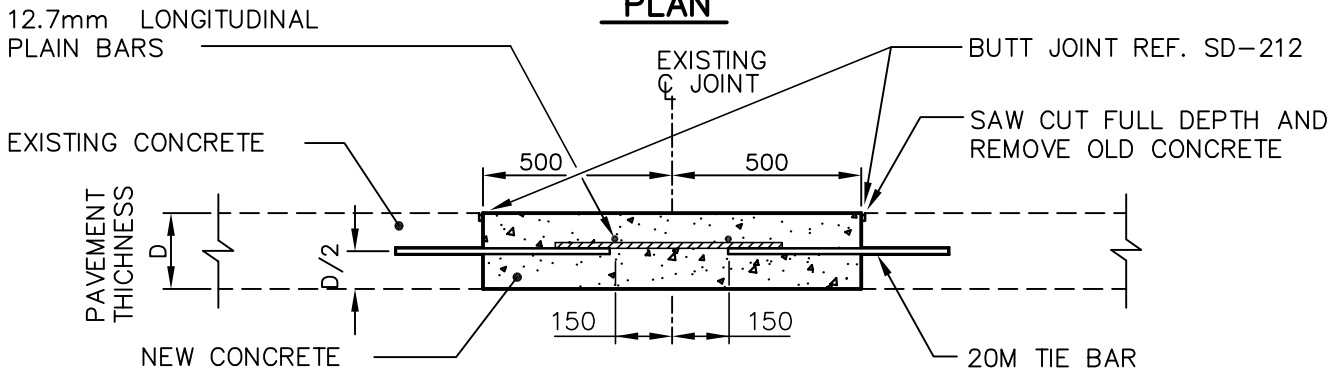

SECTION A-A

NOTE:

1. EXISTING REINFORCING STEEL SHALL BE REPLACED WITH NEW REINFORCING STEEL AS SHOWN.
2. IF JOINT REPAIR IS GREATER THAN 1000 WIDE ON EITHER SIDE OF THE JOINT, USE ADDITIONAL 12.7mm LONGITUDINAL PLAIN BARS AT 450 O.C. OR USE BAR MAT REF. SD-217..
3. WHERE BAR MAT IS USED. CUT OFF FINGER ENDS SO THE 150 GAP HAS NO FINGER ENDS.
4. ONLY TIE BARS AND DOWELS ARE REQUIRED FOR PLAIN DOWELLED PAVEMENTS.
5. INSTALL DOWELS AT PATCH ENDS, REF. SD-213B.

DIMENSIONS ARE IN MILLIMETRES



THE CITY OF WINNIPEG
PUBLIC WORKS DEPARTMENT

Reference Spec. No.
CW 3230, CW 3310, SD 213A, SD 213B

| Revisions | | | |
|-----------|---------|------------------|------|
| No. | Date | Description | By |
| 2 | FEB.04 | GENERAL REVISION | J.G. |
| 1 | JAN. 03 | GENERAL REVISION | AP |

**LONGITUDINAL JOINT
REPAIR DETAILS
FULL-WIDTH PATCH
(BOTH SIDES AT SAME TIME)**

| | | |
|--------------------------------------|-------------------|--------------------------|
| Designed By: L.S.W.L. | Drawn By: A.R. | Scale : N.T.S. |
| Checked By: B.P. | Date: 12.12.15 | Drawing No. |
| Approved: SURFACE WORKS COMMITTEE | | SD-214A |